

Docking Drawer®

Style Drawer Flush Spec Sheets

Style Drawer 24 Flush..... 3

- Part Numbers
- Finishes
- Features
- Outlet Specifications
- Cabinet Specifications
- In-Drawer Outlet Dimensions
- Cutout Template
- Electrical Planning Guide

Style Drawer 21 Flush..... 14

- Part Numbers
- Finishes
- Features
- Outlet Specifications
- Cabinet Specifications
- In-Drawer Outlet Dimensions
- Cutout Template
- Electrical Planning Guide

Style Drawer 18 Flush..... 25

- Part Numbers
- Finishes
- Features
- Outlet Specifications
- Cabinet Specifications
- In-Drawer Outlet Dimensions
- Cutout Template
- Electrical Planning Guide



Style Drawer Flush

Anatomy of a Style Drawer Flush

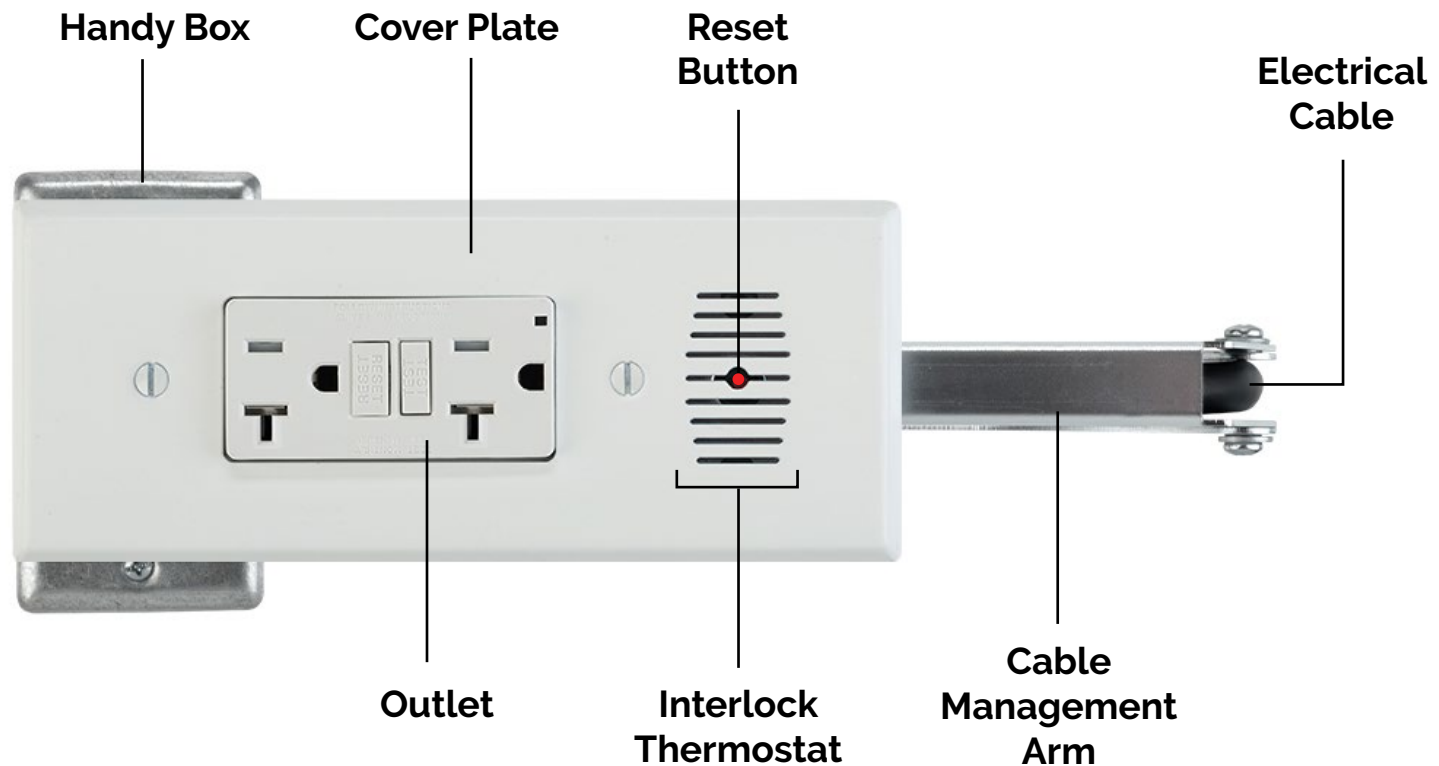

Style Drawer 24 Flush

part #: 0290-00033



Style Drawer 24 Flush

Understanding Docking Drawer Part Numbers

0290-00033W-U



Outlet Size Finish Configuration

1 Outlet Size

00033 - Style Drawer 24 Flush

00032 - Style Drawer 21 Flush

00050 - Style Drawer 18 Flush

2 Finish

- Black

W - White

S - Stainless Steel

3 Configuration

- 2 AC - GFCI

U - 2 AC & 2 USB-A

UC - 2 AC & 2 USB-C

Style Drawer 24 Flush Part Numbers



2 AC - GFCI

0290-00033

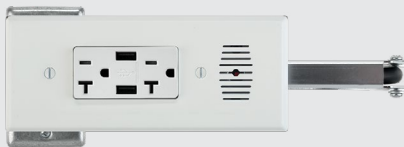

2 AC & 2 USB-A

0290-00033-U



2 AC & 2 USB-C

0290-00033-UC

Style Drawer 24 Flush part #: 0290-00033

Available Finishes

wonderful in
WHITE



beautiful in
BLACK



sexy in
STAINLESS



Style Drawer 24 Flush part #: 0290-00033

Features	
Electrical Listing	<u>ETL Listed</u>
Country of Use	Certified for use in the U.S.
Interlocking Safety Features	Interlock Thermostat - De-energizes outlet when the temperature exceeds 120°F (49°C)
Electrical Connection	Hardwired
Cable Protection	Ultra flexible cable jacket and cable strain reliefs prevent tension and wear
Available Outlet Finishes	White, Black or Stainless Steel
Warranty	2 Years
Country of Origin	Made in Mexico

Outlet Specifications	
Tamper Resistant	Yes
2 AC GFCI	2 AC: 20 amps @ 120 VAC
2 AC & 2 USB-A	2AC: 20 amps @ 120 VAC USB: 3.6 amps @ 5 VDC
2 AC & 2 USB-C	2AC: 20 amps @ 120 VAC USB-C (PD Device): 3 amps @ 9 VDC USB-C (Non-PD Device): 3 amps @ 5 VDC

Style Drawer 24 Flush part #: 0290-00033

Will it Fit in My Cabinet?

Our outlets come in a variety of sizes that offer different ranges of extensions. To find the size that works for you, first measure your cabinet.

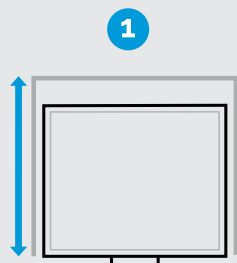

1 Start your project by measuring the cabinet's depth.

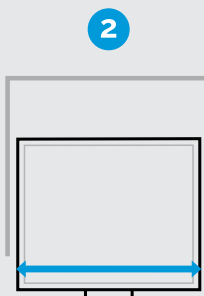

2 Measure the drawer box width (OD).

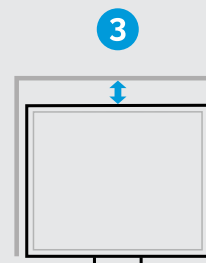

3 Then measure space available behind the drawer box.

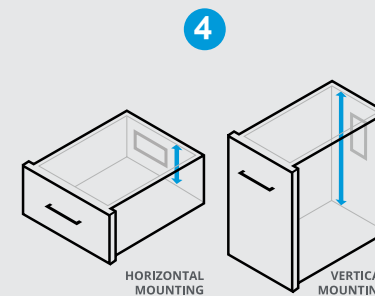

4 Then measure the interior drawer box height.

Horizontal Mounting Cabinet Specifications

1 Cabinet Depth	24" or less (635mm or less)
2 Minimum Drawer Box Width (OD)	13.5" or more (343mm or more)
3 Minimum space behind drawer box	5" (127mm)
4 Minimum interior drawer box height	4" (102mm)

Have a narrow drawer or want to mount the outlet vertically?
Our modified cabinet specs are on the [next page](#).

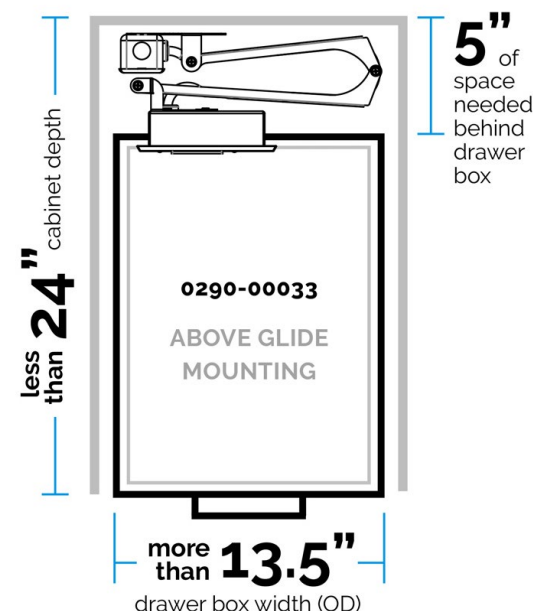

Style Drawer 24 Flush part #: 0290-00033

Vertical Mounting Cabinet Specifications

Cabinet Depth	24" or less (635mm or less)
Minimum Drawer Box Width (OD)	4" (102mm)
Minimum space behind drawer box	5" (127mm)
Minimum interior drawer box height	13.5" or more (343mm or more)

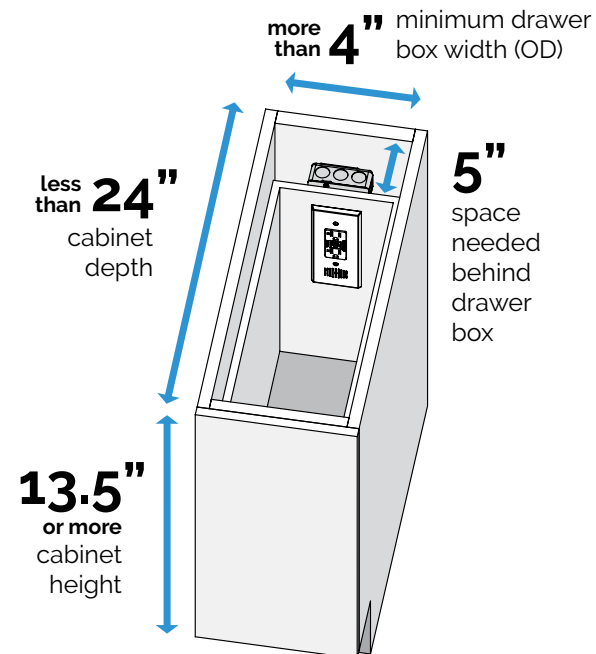

Narrow Drawer Cabinet Specifications

Cabinet Depth	24" or less (635mm or less)
Minimum Drawer Box Width (OD)	9" (229mm)
Minimum space behind drawer box	5" (127mm)
Minimum interior drawer box height	4" (102mm)
Minimum space needed for channel height	2" (51mm)

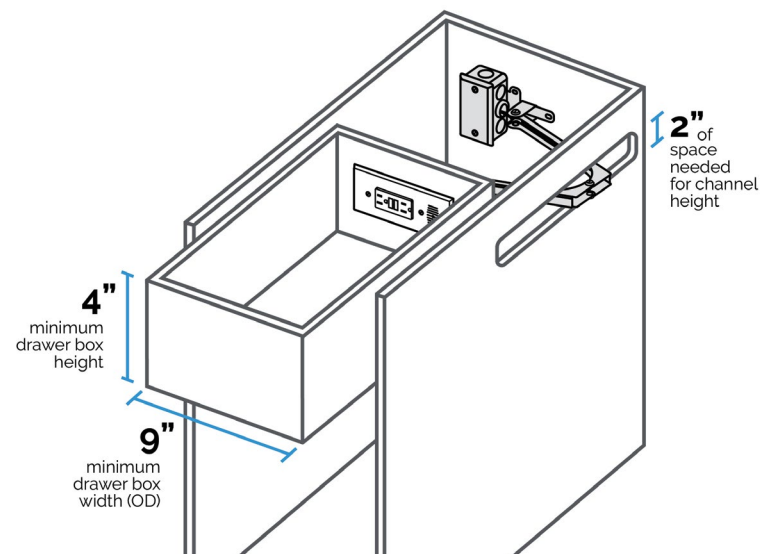

Only have 2" behind your drawer box? You may be interested in our **Style Drawer Blade** series of powering outlets.

Style Drawer 24 Flush part #: 0290-00033

In-Drawer Outlet Dimensions

Outlet Width	13.42" (341mm)
Outlet Height	4.2" (107mm)
Outlet Depth	6.15" (156mm)
Receptacle Box Depth	1.78" (45mm)
Cover Plate Height	3.08" (72mm)
Cover Plate Width	7.13" (181mm)

Front View

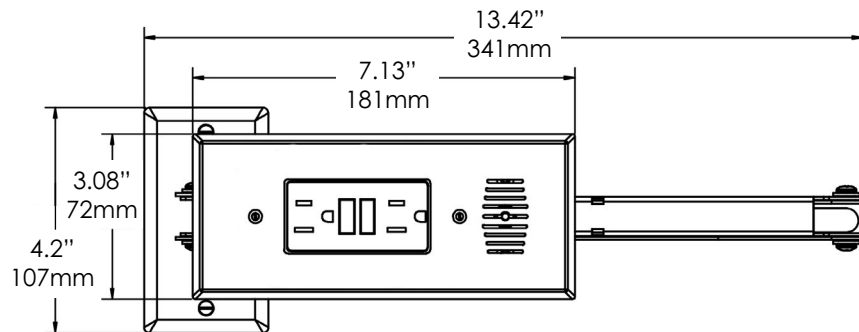

Top View

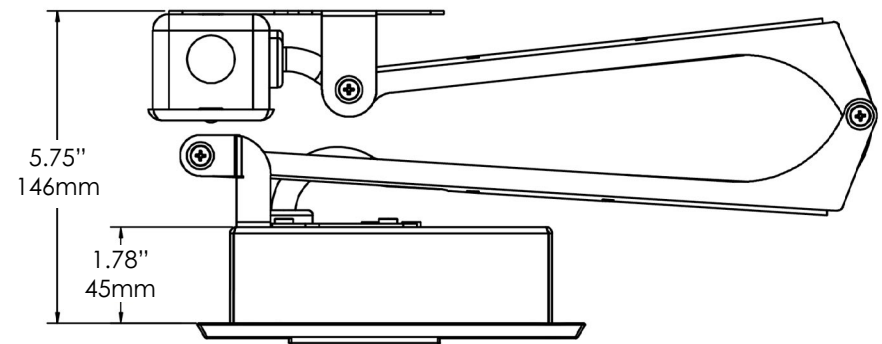

Style Drawer 24 Flush part #: 0290-00033

Cutout Template

Use the following cutout template for the receptacle box cutout on the back of your drawer box. For additional installation instructions, please reference the [Style Drawer Flush Installation Manual](#).

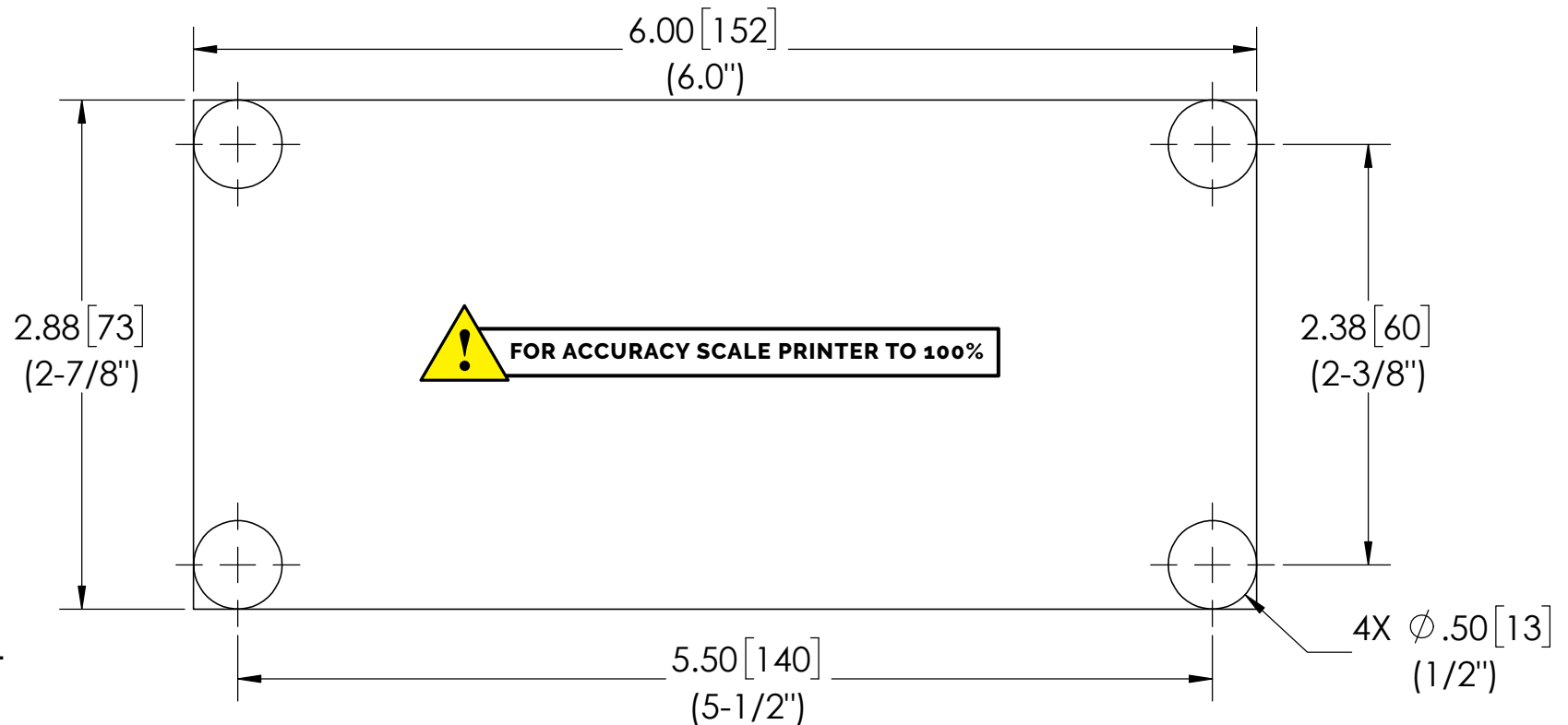

Measurements shown in:
inches [mm]
(inches fractional)

Style Drawer 24 Flush part #: 0290-00033

Electrical Planning Guide

Style Drawer Flush Powering Outlets are ETL Listed and comply with UL 962a when installed in accordance to the outlet's installation instructions. The following is a guide designed to provide steps for roughing-in an electrical supply for your outlet installation. Please also review the specific installation instructions for each outlet.

A licensed electrician needs to supply all electrical rough-ins to local building codes for your installation. All powering outlets come with 20A tamper proof outlets and require a 20 amp circuit. All wiring inside of a cabinet must be MC Cable.



Need to Access our Electrical Certifications?

All of our electrical listing can be found [online in our Support Library](#).

Where NOT to Locate the In-Cabinet Electrical Supply

One location that we caution is directly behind the drawer where the outlet is being installed. If this location is utilized, you must ensure that the in-cabinet outlet and wiring do not interfere with the Docking Drawer cable management arms or drawer slides.

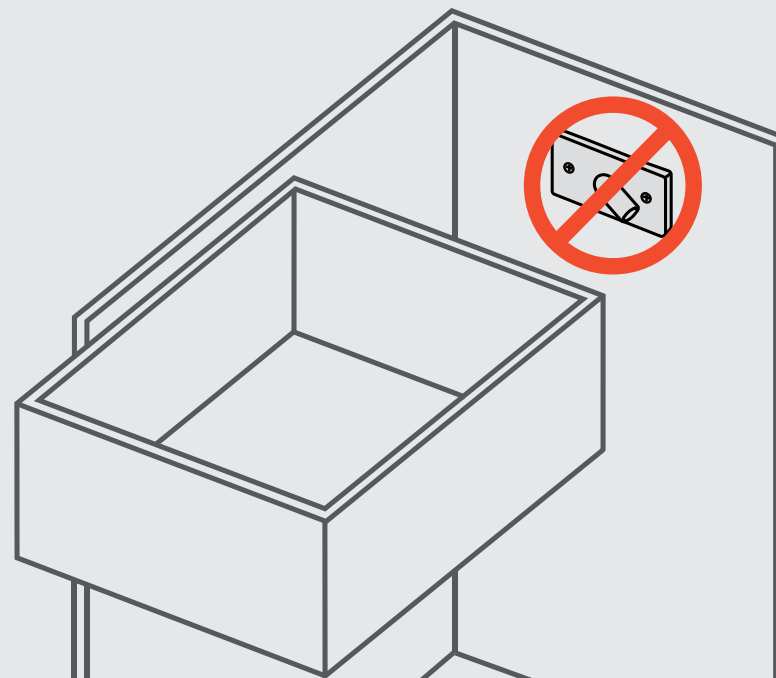

Style Drawer 24 Flush part #: 0290-00033

Electrical Planning Guide (continued)

Making the Electrical Connection from the In-Cabinet Outlet to the In-Drawer Outlet

Top Left or Right
(Cord running
under countertop)

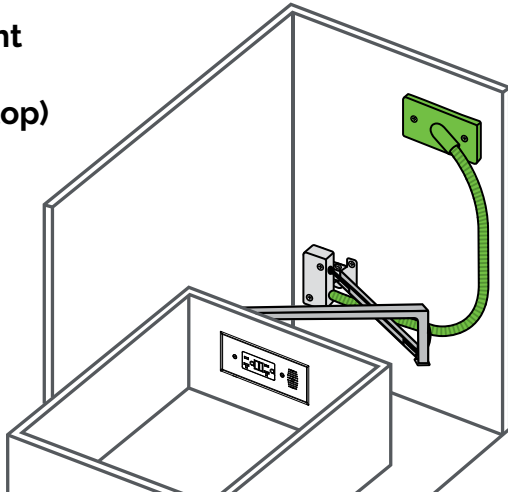

Right Under the
Drawer Box

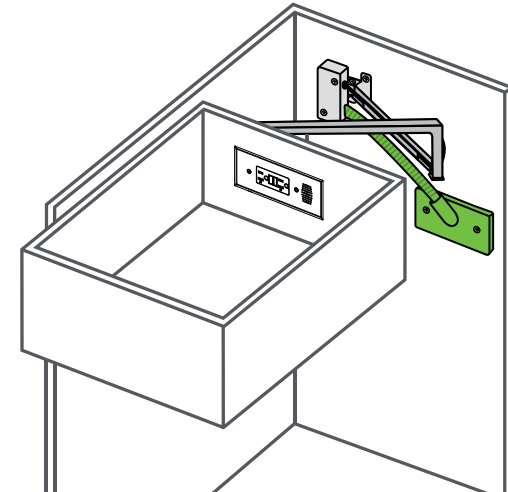

Bottom

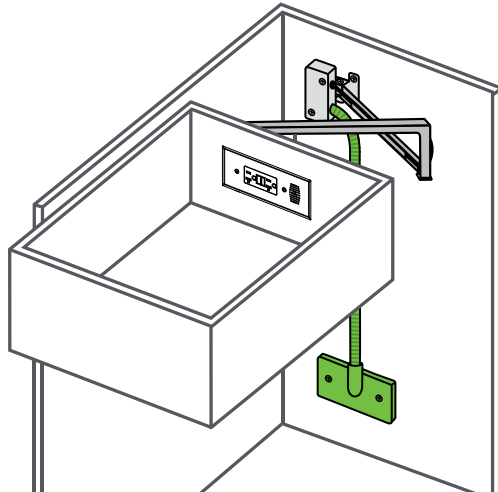

Left of the
Handy Box

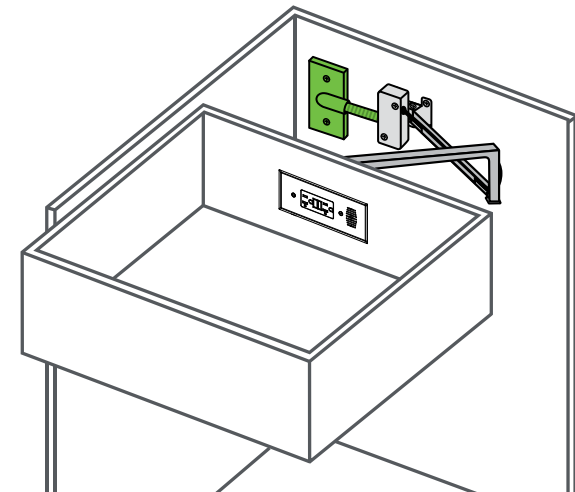

*Items marked in green are not included

Style Drawer 24 Flush part #: 0290-00033

Additional Resources



DXF & Step Files

<https://bit.ly/3dnFMKo>



Installation Manual

<https://bit.ly/3eqZyFT>



Electrical Certifications

<https://bit.ly/3dn1L3X>

We're Here to Help

sales@dockingdrawer.com

Email us here with your sales questions, help selecting the right outlet or to request any literature.



support@dockingdrawer.com

Email us here with your technical and project planning questions or any other specification questions.

Style Drawer 21 Flush

part #: 0290-00032



Style Drawer 21 Flush

Understanding Docking Drawer Part Numbers			
<div>0290-00032W-U</div> <div><div><div></div><div></div><div></div></div><div><div>1</div><div>2</div><div>3</div></div><div>Outlet SizeFinishConfiguration</div></div>	1 Outlet Size	2 Finish	3 Configuration
	00033 - Style Drawer 24 Flush	- Black	- 2 AC - GFCI
	00032 - Style Drawer 21 Flush	W - White	U - 2 AC & 2 USB-A
	00050 - Style Drawer 18 Flush	S - Stainless Steel	UC - 2 AC & 2 USB-C

Style Drawer 21 Flush Part Numbers		
	2 AC - GFCI	0290-00032
	2 AC & 2 USB-A	0290-00032-U
	2 AC & 2 USB-C	0290-00032-UC

Style Drawer 21 Flush part #: 0290-00032

Available Finishes

wonderful in
WHITE



beautiful in
BLACK



sexy in
STAINLESS



Style Drawer 21 Flush part #: 0290-00032

Features	
Electrical Listing	ETL Listed
Country of Use	Certified for use in the U.S.
Interlocking Safety Features	Interlock Thermostat - De-energizes outlet when the temperature exceeds 120°F (49°C)
Electrical Connection	Hardwired
Cable Protection	Ultra flexible cable jacket and cable strain reliefs prevent tension and wear
Available Outlet Finishes	White, Black or Stainless Steel
Warranty	2 Years
Country of Origin	Made in Mexico

Outlet Specifications	
Tamper Resistant	Yes
2 AC GFCI	2 AC: 20 amps @ 120 VAC
2 AC & 2 USB-A	2AC: 20 amps @ 120 VAC USB: 3.6 amps @ 5 VDC
2 AC & 2 USB-C	2AC: 20 amps @ 120 VAC USB-C (PD Device): 3 amps @ 9 VDC USB-C (Non-PD Device): 3 amps @ 5 VDC

Style Drawer 21 Flush part #: 0290-00032

Will it Fit in My Cabinet?

Our outlets come in a variety of sizes that offer different ranges of extensions. To find the size that works for you, first measure your cabinet.

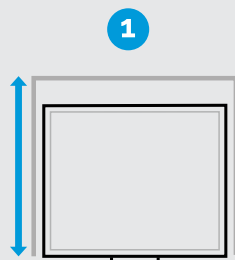

1 Start your project by measuring the cabinet's depth.

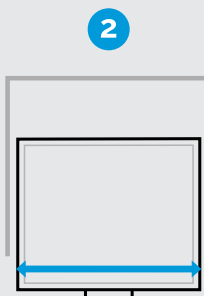

2 Measure the drawer box width (OD).

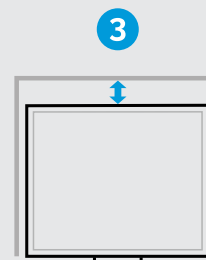

3 Then measure space available behind the drawer box.

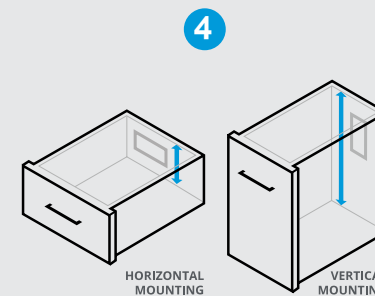

4 Then measure the interior drawer box height.

Horizontal Mounting Cabinet Specifications

1 Cabinet Depth	21" or less (559mm or less)
2 Minimum Drawer Box Width (OD)	12" or more (305mm or more)
3 Minimum space behind drawer box	5" (127mm)
4 Minimum interior drawer box height	4" (102mm)

Have a narrow drawer or want to mount the outlet vertically?
Our modified cabinet specs are on the [next page](#).

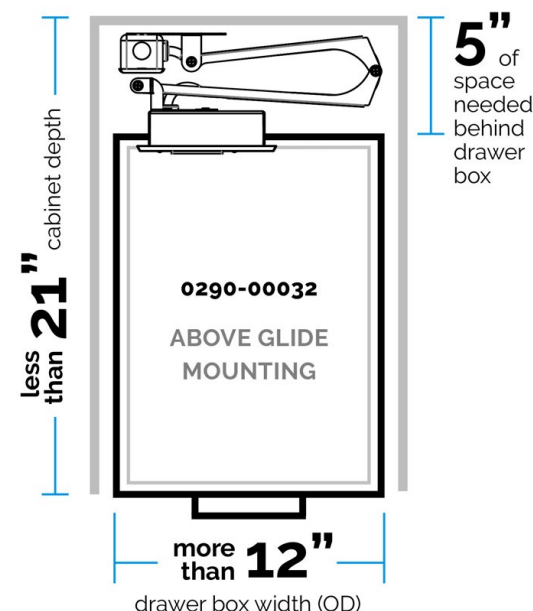

Style Drawer 21 Flush part #: 0290-00032

Vertical Mounting Cabinet Specifications

Cabinet Depth	21" or less (559mm or less)
Minimum Drawer Box Width (OD)	4" (102mm)
Minimum space behind drawer box	5" (127mm)
Minimum interior drawer box height	12" or more (305mm or more)

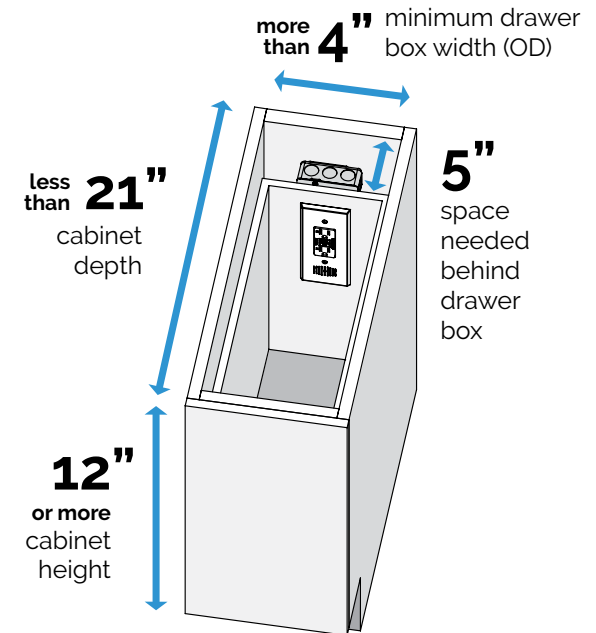

Narrow Drawer Cabinet Specifications

Cabinet Depth	21" or less (559mm or less)
Minimum Drawer Box Width (OD)	9" (229mm)
Minimum space behind drawer box	5" (127mm)
Minimum interior drawer box height	4" (102mm)
Minimum space needed for channel height	2" (51mm)

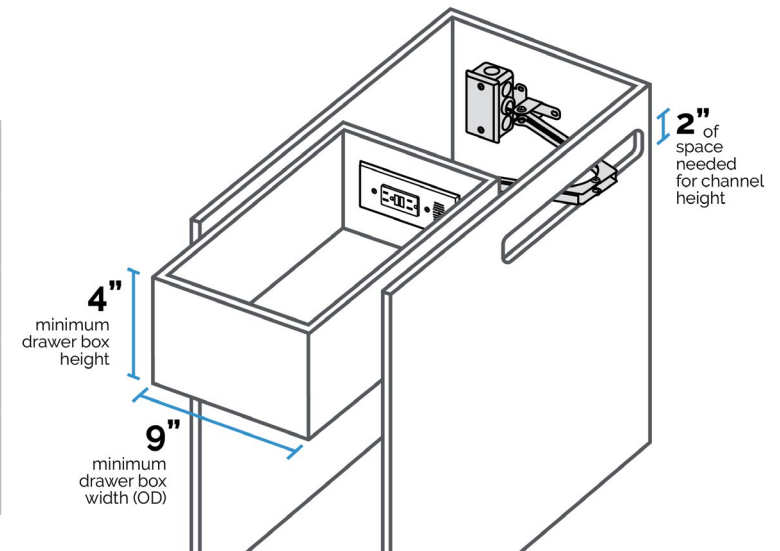

Only have 2" behind your drawer box? You may be interested in our **Style Drawer Blade** series of powering outlets.

Style Drawer 21 Flush part #: 0290-00032

In-Drawer Outlet Dimensions

Outlet Width	11.92" (303mm)
Outlet Height	4.2" (107mm)
Outlet Depth	5.75" (146mm)
Receptacle Box Depth	1.78" (45mm)
Cover Plate Height	3.08" (72mm)
Cover Plate Width	7.13" (181mm)

Front View

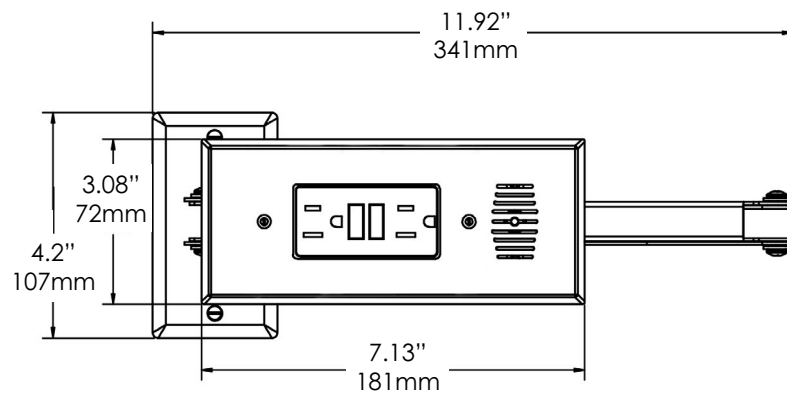

Top View

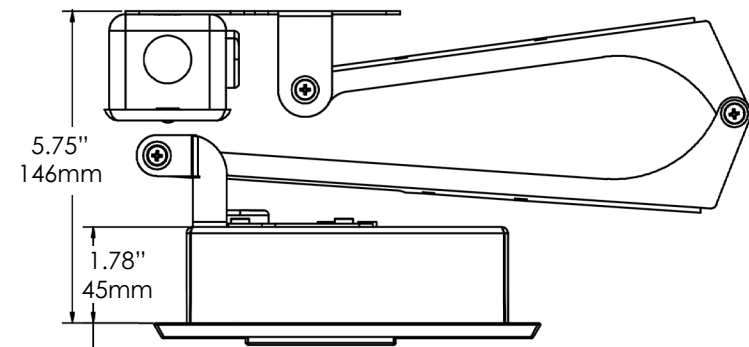

Style Drawer 21 Flush part #: 0290-00032

Cutout Template

Use the following cutout template for the receptacle box cutout on the back of your drawer box. For additional installation instructions, please reference the [Style Drawer Flush Installation Manual](#).

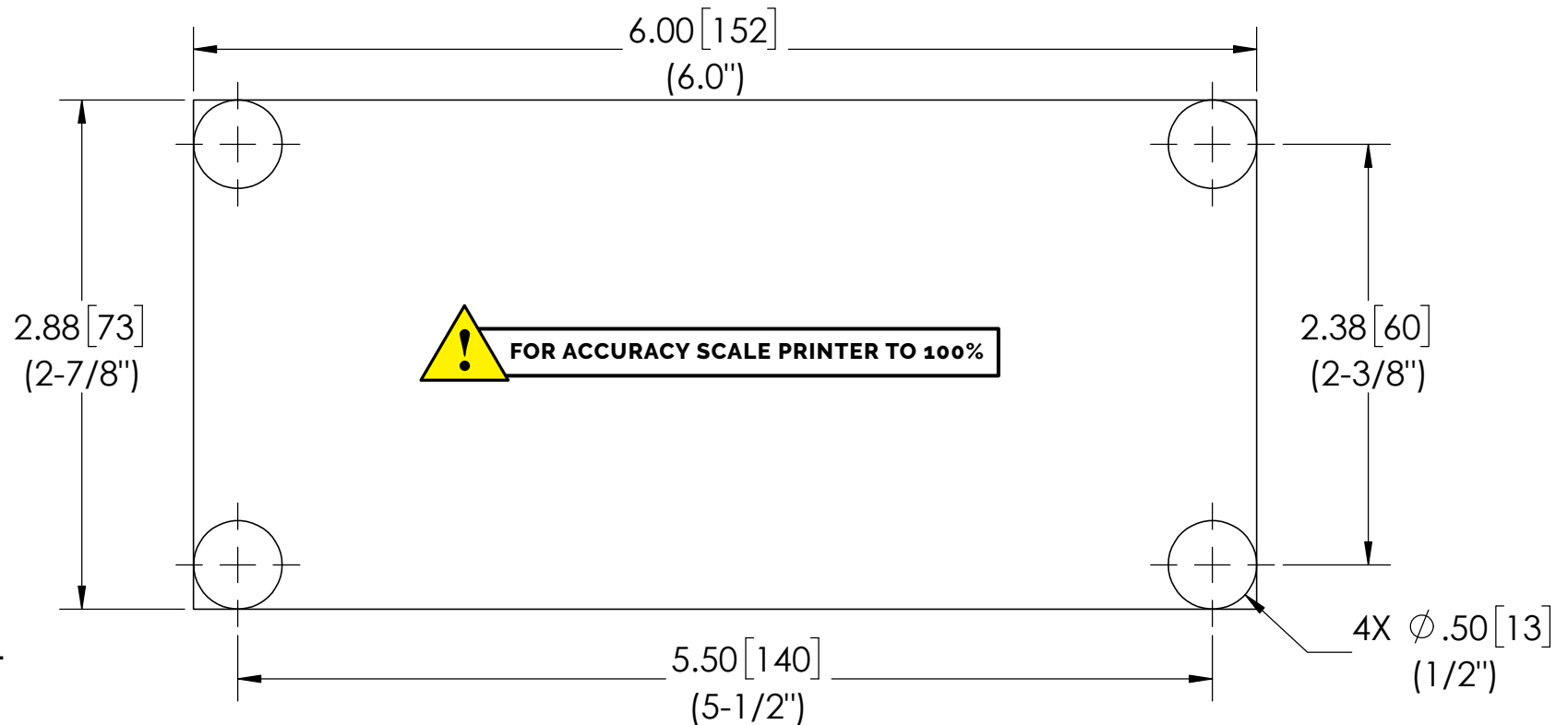

Measurements shown in:
inches [mm]
(inches fractional)

Style Drawer 21 Flush part #: 0290-00032

Electrical Planning Guide

Style Drawer Flush Powering Outlets are ETL Listed and comply with UL 962a when installed in accordance to the outlet's installation instructions. The following is a guide designed to provide steps for roughing-in an electrical supply for your outlet installation. Please also review the specific [installation instructions](#) for each outlet.

A licensed electrician needs to supply all electrical rough-ins to local building codes for your installation. All powering outlets come with 20A tamper proof outlets and require a 20 amp circuit. All wiring inside of a cabinet must be MC Cable.



Need to Access our Electrical Certifications?

All of our electrical listing can be found [online in our Support Library](#).

Where NOT to Locate the In-Cabinet Electrical Supply

One location that we caution is directly behind the drawer where the outlet is being installed. If this location is utilized, you must ensure that the in-cabinet outlet and wiring do not interfere with the Docking Drawer cable management arms or drawer slides.

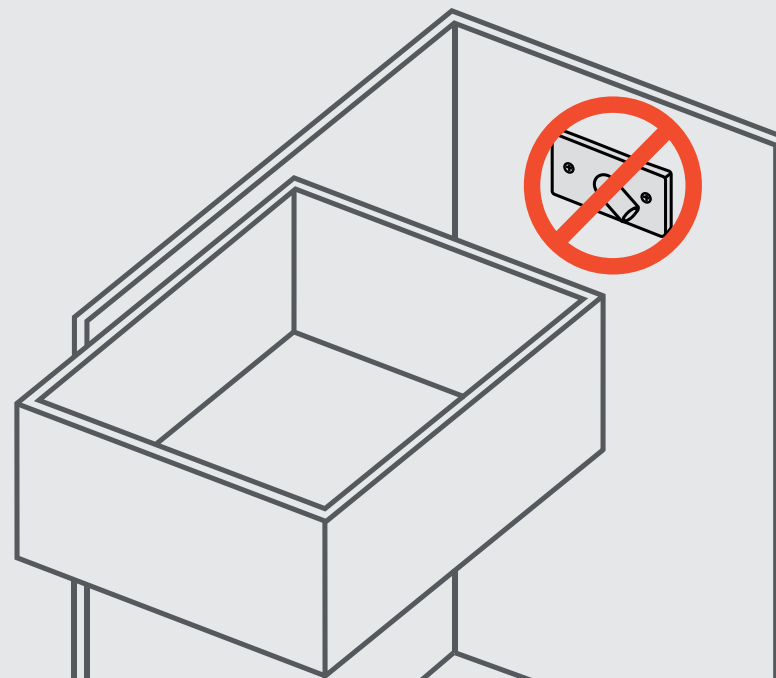

Style Drawer 21 Flush part #: 0290-00032

Electrical Planning Guide (continued)

Making the Electrical Connection from the In-Cabinet Outlet to the In-Drawer Outlet

Top Left or Right
(Cord running
under countertop)

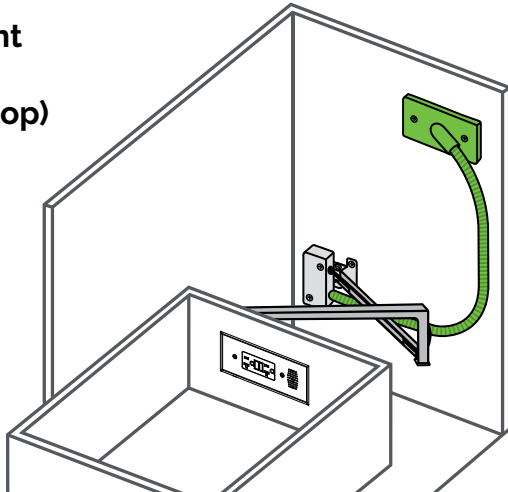

Right Under the
Drawer Box

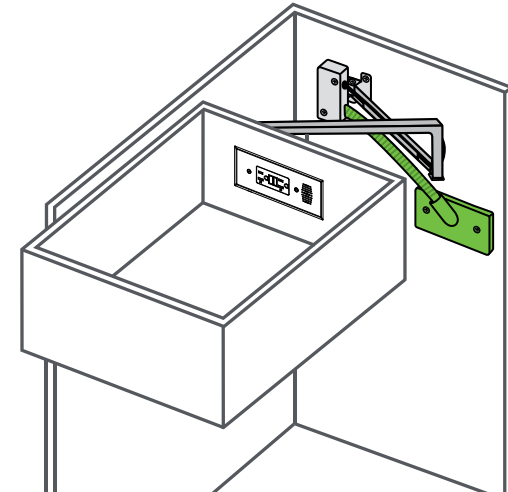

Bottom

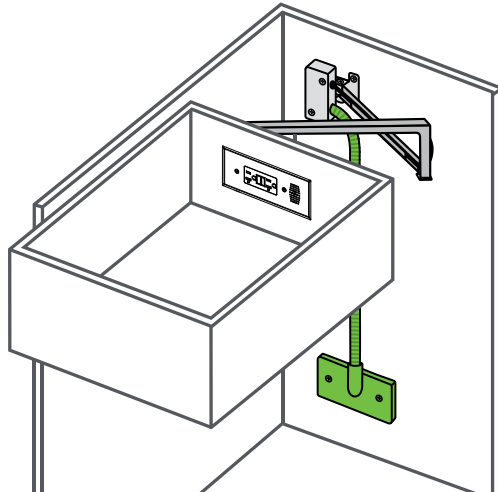

Left of the
Handy Box

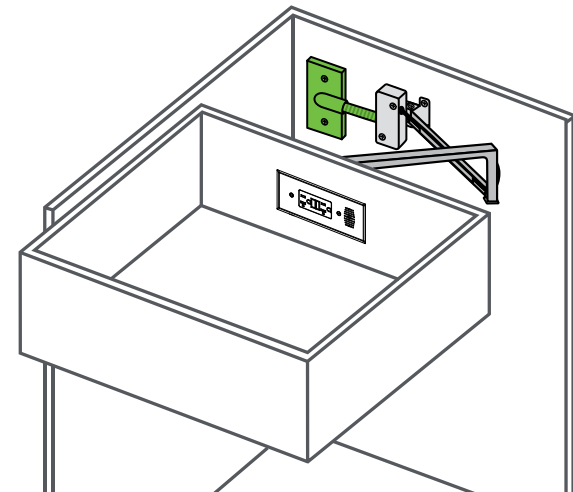

*Items marked in green are not included

Style Drawer 21 Flush part #: 0290-00032

Additional Resources



DXF & Step Files

<https://bit.ly/3dnFMKo>



Installation Manual

<https://bit.ly/3eqZyFT>



Electrical Certifications

<https://bit.ly/3dn1L3X>

We're Here to Help

sales@dockingdrawer.com

Email us here with your sales questions, help selecting the right outlet or to request any literature.



support@dockingdrawer.com

Email us here with your technical and project planning questions or any other specification questions.

Style Drawer 18 Flush

part #: 0290-00050



Style Drawer 18 Flush

Understanding Docking Drawer Part Numbers

0290-00050W-U



Outlet Size Finish Configuration

1 Outlet Size

00033 - Style Drawer 24 Flush

00032 - Style Drawer 21 Flush

00050 - **Style Drawer 18 Flush**

2 Finish

- Black

W - White

S - Stainless Steel

3 Configuration

- 2 AC - GFCI

U - 2 AC & 2 USB-A

UC - 2 AC & 2 USB-C

Style Drawer 18 Flush Part Numbers



2 AC - GFCI

0290-00050

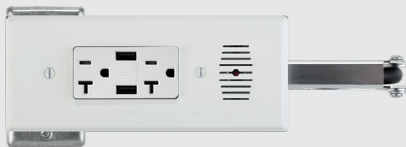

2 AC & 2 USB-A

0290-00050-U



2 AC & 2 USB-C

0290-00050-UC

Style Drawer 18 Flush part #: 0290-00050

Available Finishes

wonderful in
WHITE



beautiful in
BLACK



sexy in
STAINLESS



Style Drawer 18 Flush part #: 0290-00050

Features	
Electrical Listing	<u>ETL Listed</u>
Country of Use	Certified for use in the U.S.
Interlocking Safety Features	Interlock Thermostat - De-energizes outlet when the temperature exceeds 120°F (49°C)
Electrical Connection	Hardwired
Cable Protection	Ultra flexible cable jacket and cable strain reliefs prevent tension and wear
Available Outlet Finishes	White, Black or Stainless Steel
Warranty	2 Years
Country of Origin	Made in Mexico

Outlet Specifications	
Tamper Resistant	Yes
2 AC GFCI	2 AC: 20 amps @ 120 VAC
2 AC & 2 USB-A	2AC: 20 amps @ 120 VAC USB: 3.6 amps @ 5 VDC
2 AC & 2 USB-C	2AC: 20 amps @ 120 VAC USB-C (PD Device): 3 amps @ 9 VDC USB-C (Non-PD Device): 3 amps @ 5 VDC

Style Drawer 18 Flush part #: 0290-00050

Will it Fit in My Cabinet?

Our outlets come in a variety of sizes that offer different ranges of extensions. To find the size that works for you, first measure your cabinet.

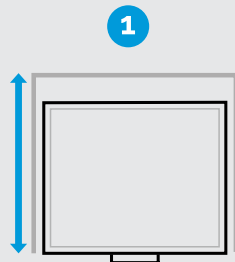

1 Start your project by measuring the cabinet's depth.

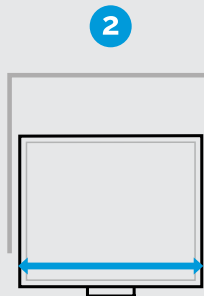

2 Measure the drawer box width (OD).

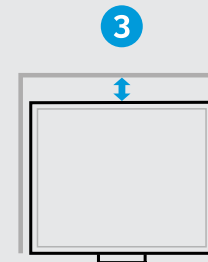

3 Then measure space available behind the drawer box.

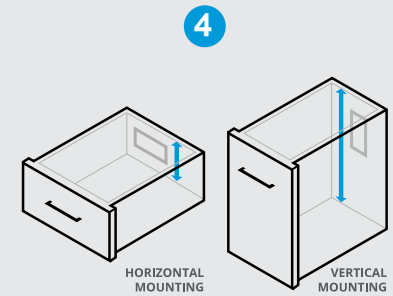

4 Then measure the interior drawer box height.

Horizontal Mounting Cabinet Specifications

1 Cabinet Depth	18" or less (483mm or less)
2 Minimum Drawer Box Width (OD)	10.5" or more (267mm or more)
3 Minimum space behind drawer box	5" (127mm)
4 Minimum interior drawer box height	4" (102mm)

Have a narrow drawer or want to mount the outlet vertically?
Our modified cabinet specs are on the [next page](#).

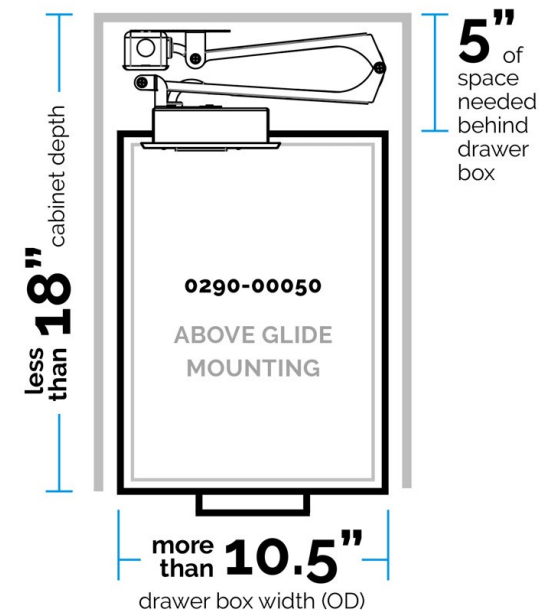

Style Drawer 18 Flush part #: 0290-00050

Vertical Mounting Cabinet Specifications

Cabinet Depth	18" or less (483mm or less)
Minimum Drawer Box Width (OD)	4" (102mm)
Minimum space behind drawer box	5" (127mm)
Minimum interior drawer box height	10.5" or more (267mm or more)

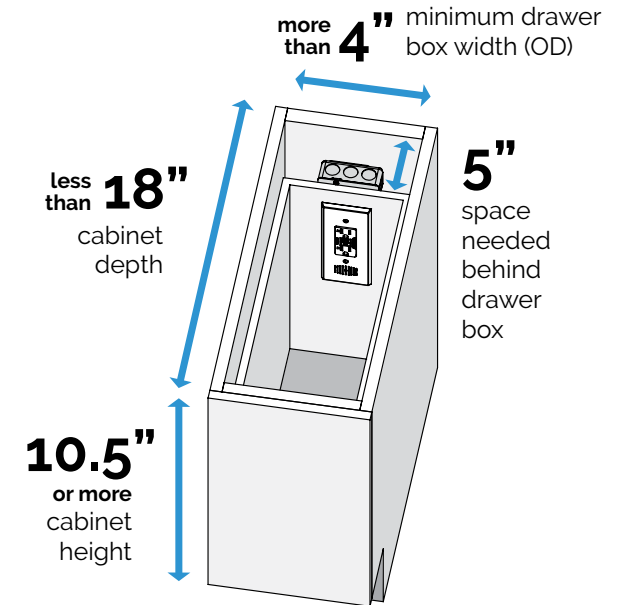

Narrow Drawer Cabinet Specifications

Cabinet Depth	18" or less (483mm or less)
Minimum Drawer Box Width (OD)	9" (229mm)
Minimum space behind drawer box	5" (127mm)
Minimum interior drawer box height	4" (102mm)
Minimum space needed for channel height	2" (51mm)

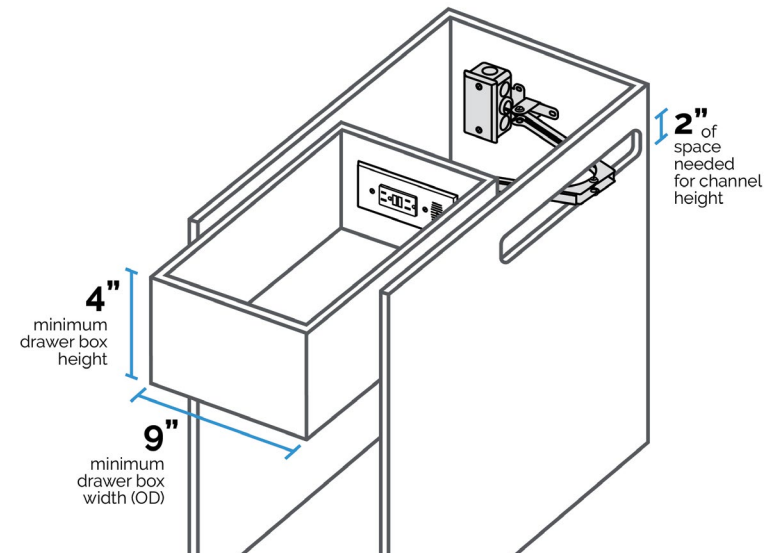

Only have 2" behind your drawer box? You may be interested in our **Style Drawer Blade** series of powering outlets.

Style Drawer 18 Flush part #: 0290-00050

In-Drawer Outlet Dimensions

Outlet Width	10.44" (265mm)
Outlet Height	4.2" (107mm)
Outlet Depth	5.75" (146mm)
Receptacle Box Depth	1.78" (45mm)
Cover Plate Height	3.08" (72mm)
Cover Plate Width	7.13" (181mm)

Front View

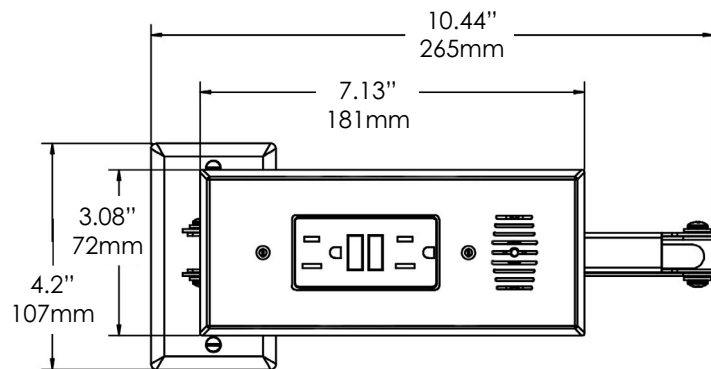

Top View

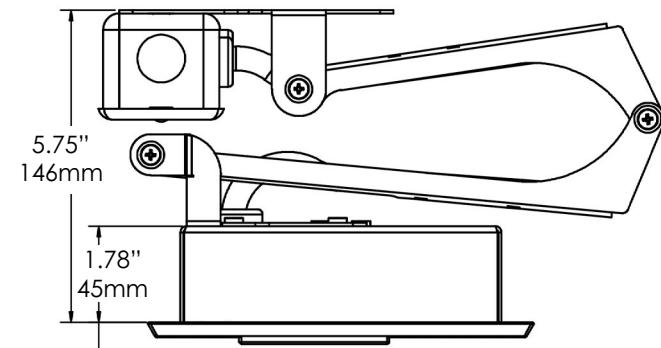

Style Drawer 18 Flush part #: 0290-00050

Cutout Template

Use the following cutout template for the receptacle box cutout on the back of your drawer box. For additional installation instructions, please reference the [Style Drawer Flush Installation Manual](#).

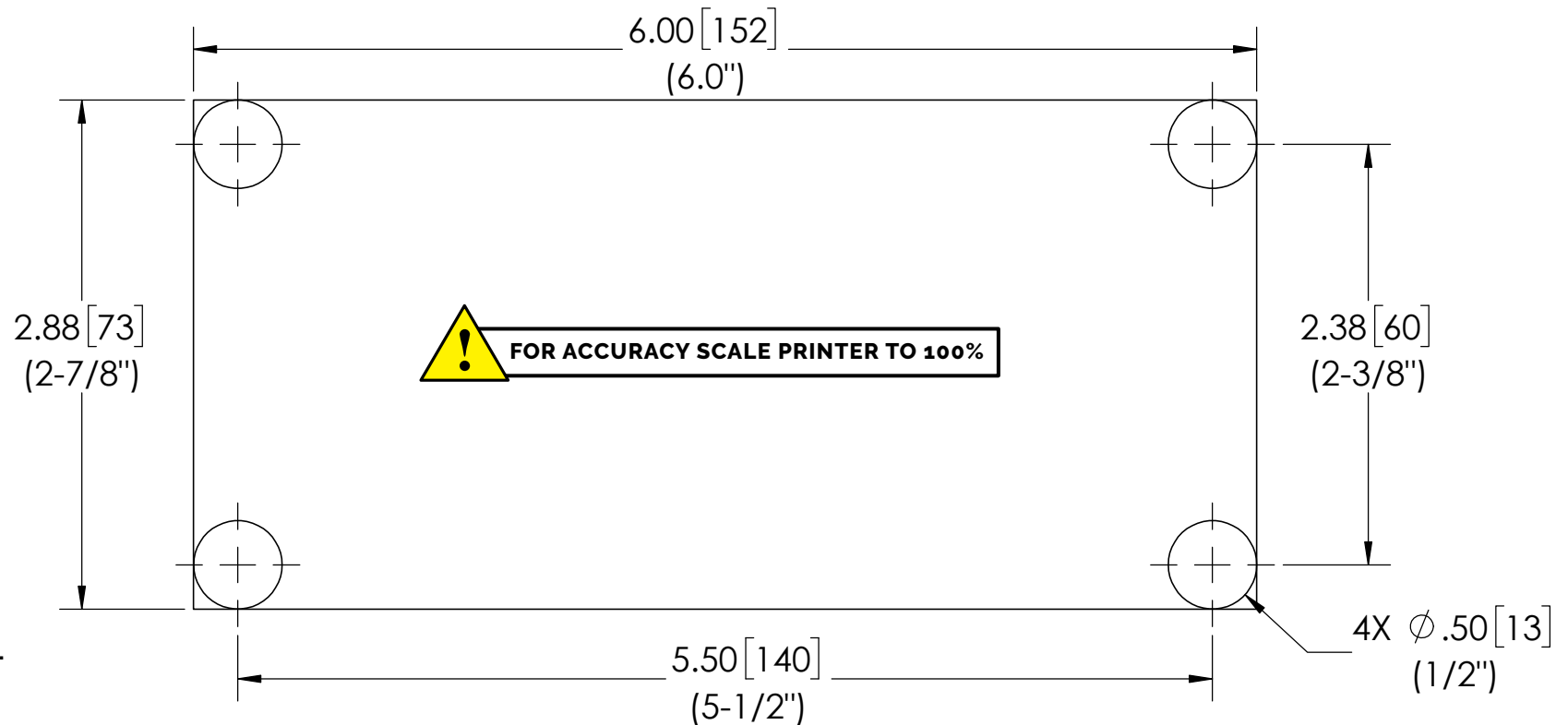

Measurements shown in:
inches [mm]
(inches fractional)

Style Drawer 18 Flush part #: 0290-00050

Electrical Planning Guide

Style Drawer Flush Powering Outlets are ETL Listed and comply with UL 962a when installed in accordance to the outlet's installation instructions. The following is a guide designed to provide steps for roughing-in an electrical supply for your outlet installation. Please also review the specific [installation instructions](#) for each outlet.

A licensed electrician needs to supply all electrical rough-ins to local building codes for your installation. All powering outlets come with 20A tamper proof outlets and require a 20 amp circuit. All wiring inside of a cabinet must be MC Cable.



Need to Access our Electrical Certifications?

All of our electrical listing can be found [online in our Support Library](#).

Where NOT to Locate the In-Cabinet Electrical Supply

One location that we caution is directly behind the drawer where the outlet is being installed. If this location is utilized, you must ensure that the in-cabinet outlet and wiring do not interfere with the Docking Drawer cable management arms or drawer slides.

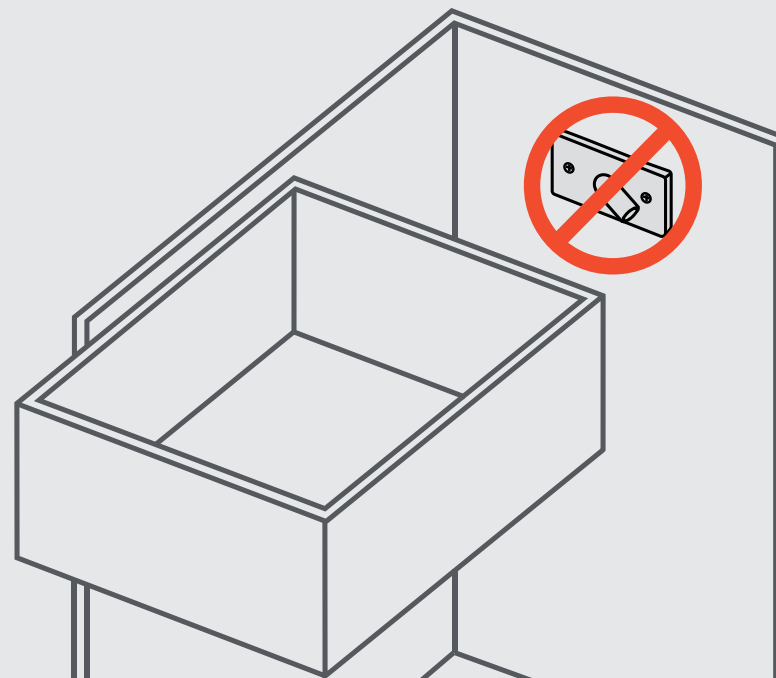

Style Drawer 18 Flush part #: 0290-00050

Electrical Planning Guide (continued)

Making the Electrical Connection from the In-Cabinet Outlet to the In-Drawer Outlet

Top Left or Right
(Cord running
under countertop)

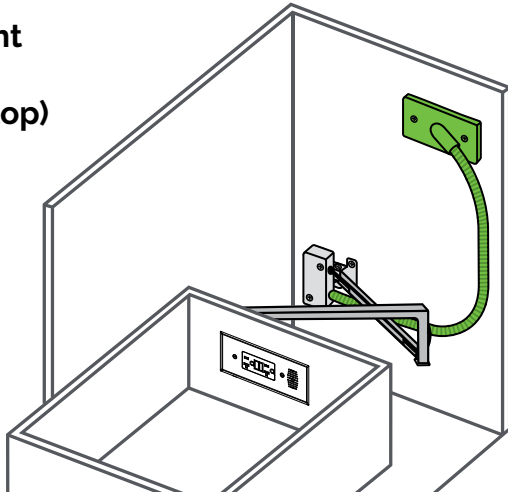

Right Under the
Drawer Box

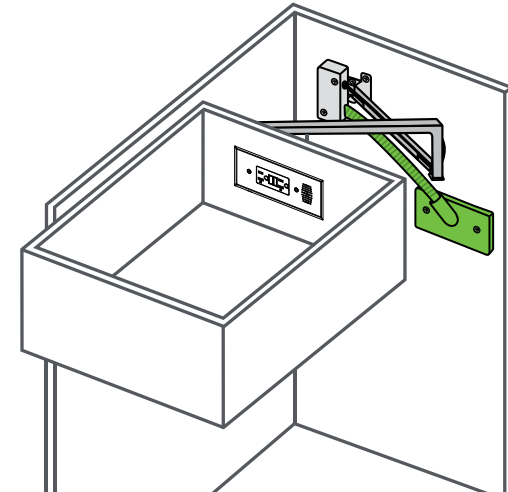

Bottom

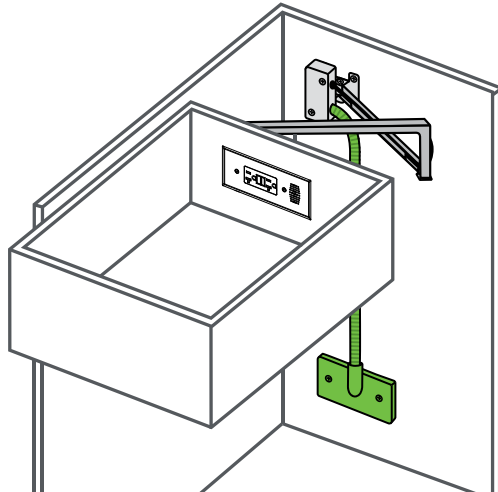

Left of the
Handy Box

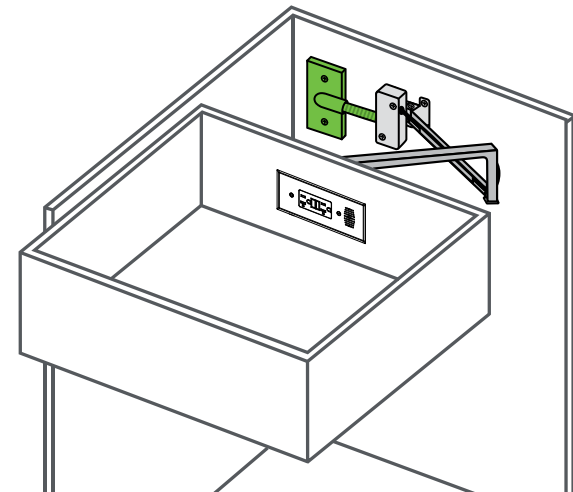

*Items marked in green are not included

Style Drawer 18 Flush part #: 0290-00050

Additional Resources



DXF & Step Files

<https://bit.ly/3dnFMKo>



Installation Manual

<https://bit.ly/3eqZyFT>



Electrical Certifications

<https://bit.ly/3dn1L3X>

We're Here to Help

sales@dockingdrawer.com

Email us here with your sales questions, help selecting the right outlet or to request any literature.



support@dockingdrawer.com

Email us here with your technical and project planning questions or any other specification questions.