

A white countertop with a docking drawer. On the countertop, there is a tray with three decorative items: a tall, dark, tiered object, a small dark jar with a white label, and a dark, tiered container with a lid. The docking drawer is partially open, revealing a white interior with a control panel on the right side. The control panel has a series of horizontal lines, a small circular indicator, and a switch.

Docking Drawer®

Style Drawer Blade Spec Sheets

Style Drawer 24 Blade..... 3

Part Numbers

Finishes

Features

Outlet Specifications

Cabinet Specifications

In-Drawer Outlet Dimensions

Cutout Template

Electrical Planning Guide

Style Drawer 21 Blade..... 15

Part Numbers

Finishes

Features

Outlet Specifications

Cabinet Specifications

In-Drawer Outlet Dimensions

Cutout Template

Electrical Planning Guide

Style Drawer Blade

Anatomy of a Style Drawer Blade

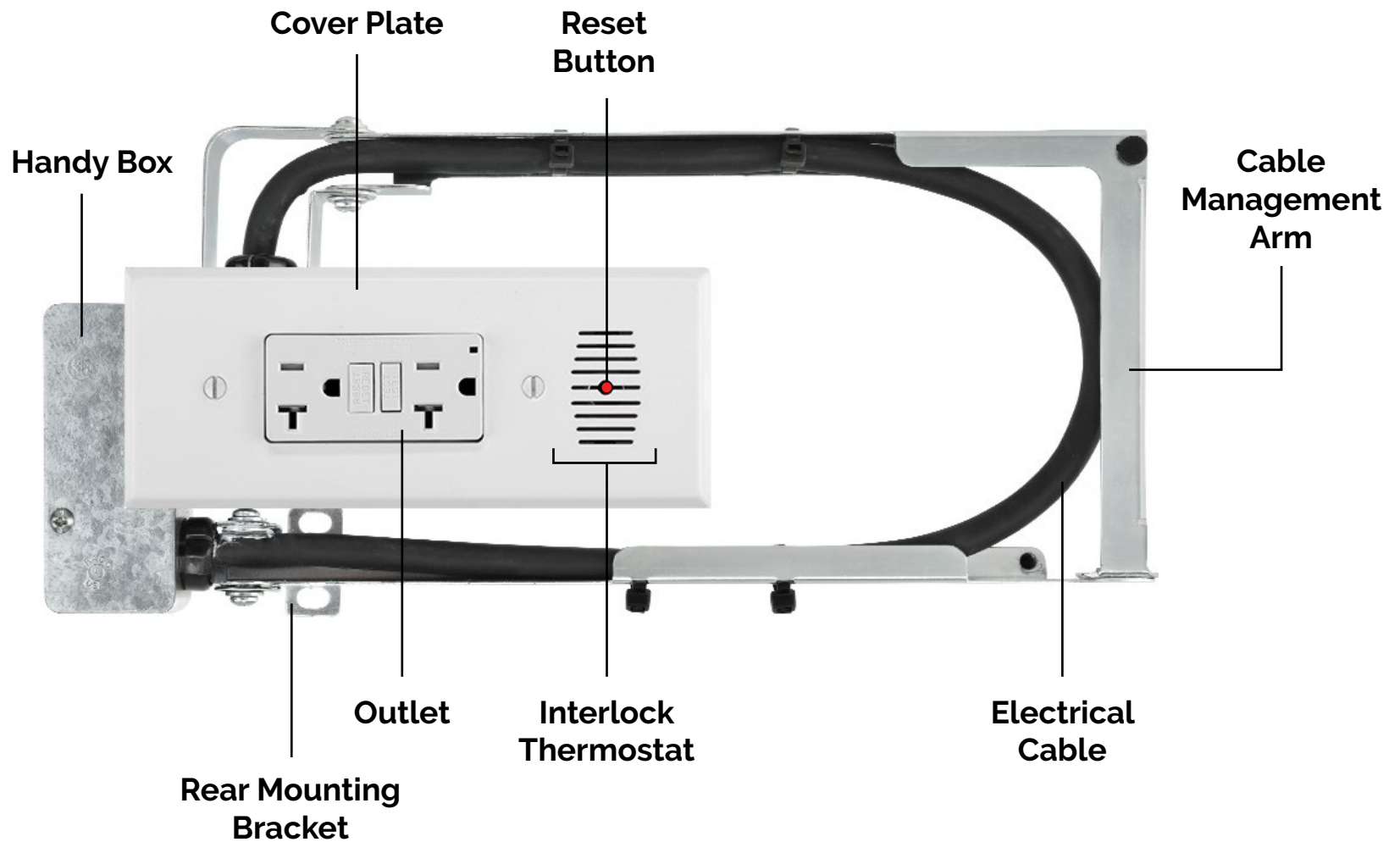

Style Drawer 24 Blade

part #: 0290-00324



Style Drawer 24 Blade

Understanding Docking Drawer Part Numbers

0290-00324W-U

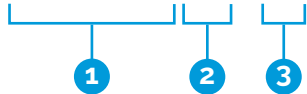

Outlet Size Finish Configuration

1 Outlet Size

00324 - Style Drawer 24 Blade

00321 - Style Drawer 21 Blade

2 Finish

- Black

W - White

S - Stainless Steel

3 Configuration

- 2 AC - GFCI

U - 2 AC & 2 USB-A

UC - 2 AC & 2 USB-C

I - 2 AC - GFCI with Interlock Box

UI - 2 AC & 2 USB-A with Interlock Box

UC-I - 2 AC & 2 USB-C with Interlock Box

Style Drawer 24 Blade Part Numbers

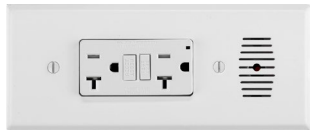

2 AC - GFCI

0290-00324

2 AC - GFCI with Interlock Box

0290-00324-I



2 AC & 2 USB-A

0290-00324-U

2 AC & 2 USB-A with Interlock Box

0290-00324-UI



2 AC & 2 USB-C

0290-00324-UC

2 AC & 2 USB-C with Interlock Box

0290-00324-UC-I

Style Drawer 24 Blade part #: 0290-00324

Available Finishes



Style Drawer 24 Blade part #: 0290-00324

Features	
Electrical Listing	ETL Listed, <u>CSA Listed</u> with <u>Interlock Box</u>
Country of Use	Certified for use in the U.S., Certified for use in Canada with Interlock Box
Interlocking Safety Features	Interlock Thermostat - De-energizes outlet when the temperature exceeds 120°F (49°C) Interlock Box - Microswitch de-energizes outlet when the drawer starts to close
Electrical Connection	Hardwired
Cable Protection	Ultra flexible cable jacket and cable strain reliefs prevent tension and wear
Available Outlet Finishes	White, Black or Stainless Steel
Warranty	2 Years
Country of Origin	Made in Mexico

Outlet Specifications	
Tamper Resistant	Yes
2 AC GFCI	2 AC: 20 amps @ 120 VAC
2 AC & 2 USB-A	2AC: 20 amps @ 120 VAC USB: 3.6 amps @ 5 VDC
2 AC & 2 USB-C	2AC: 20 amps @ 120 VAC USB-C (PD Device): 3 amps @ 9 VDC USB-C (Non-PD Device): 3 amps @ 5 VDC

Style Drawer 24 Blade part #: 0290-00324

Will it Fit in My Cabinet?

Our outlets come in a variety of sizes that offer different ranges of extensions. To find the size that works for you, first measure your cabinet.

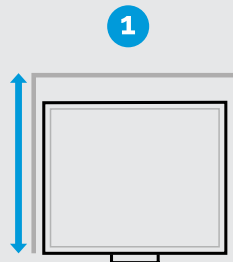

1 Start your project by measuring the cabinet's depth.

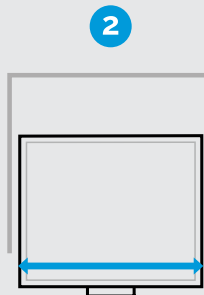

2 Measure the drawer box width (OD).

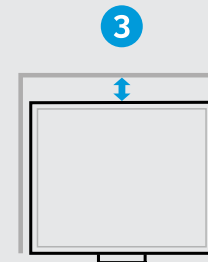

3 Then measure space available behind the drawer box.

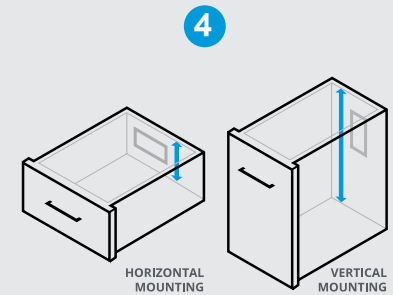

4 Then measure the interior drawer box height.

Horizontal Mounting Cabinet Specifications

1 Cabinet Depth	24" or less (635mm or less)
2 Minimum Drawer Box Width (OD)	16" or more (406mm or more) if drawer box height is more than 5.25" (133mm) 17.75" or more (451mm or more) if drawer box height is more than 4" (102mm)
3 Minimum space behind drawer box	2" or more (51mm or more)
4 Minimum interior drawer box height	4-5.25" (102-133mm)

Have a narrow drawer or want to mount the outlet vertically?
Our modified cabinet specs are on the [next page](#).

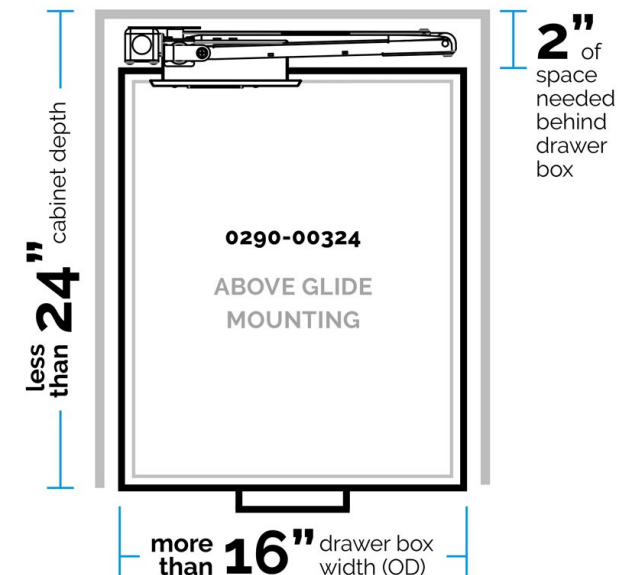

Style Drawer 24 Blade part #: 0290-00324

Vertical Mounting Cabinet Specifications

Cabinet Depth	24" or less (635mm or less)
Minimum Drawer Box Width (OD)	8" or more (203mm)
Minimum space behind drawer box	2" or more (51mm)
Minimum interior drawer box height	16" or more (406mm or more)

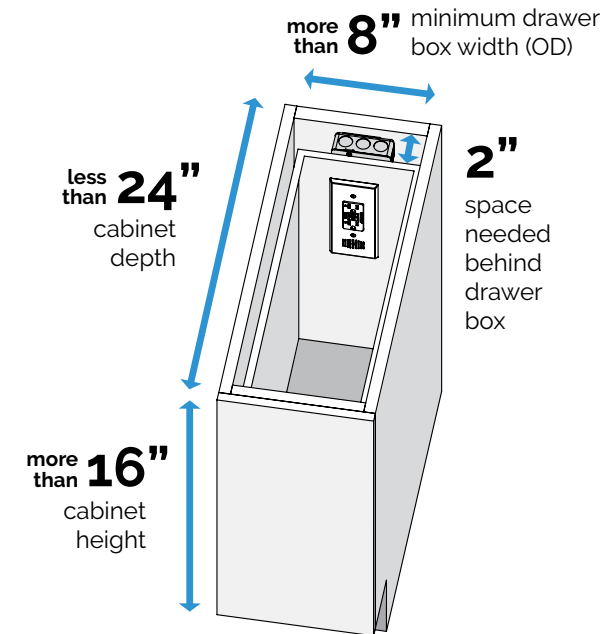

Narrow Drawer Cabinet Specifications

Cabinet Depth	24" or less (635mm or less)
Minimum Drawer Box Width (OD)	9" (229mm)
Minimum space behind drawer box	2" (51mm)
Minimum interior drawer box height	5.25" (133mm)
Minimum space needed for channel height	6.5" (165mm)

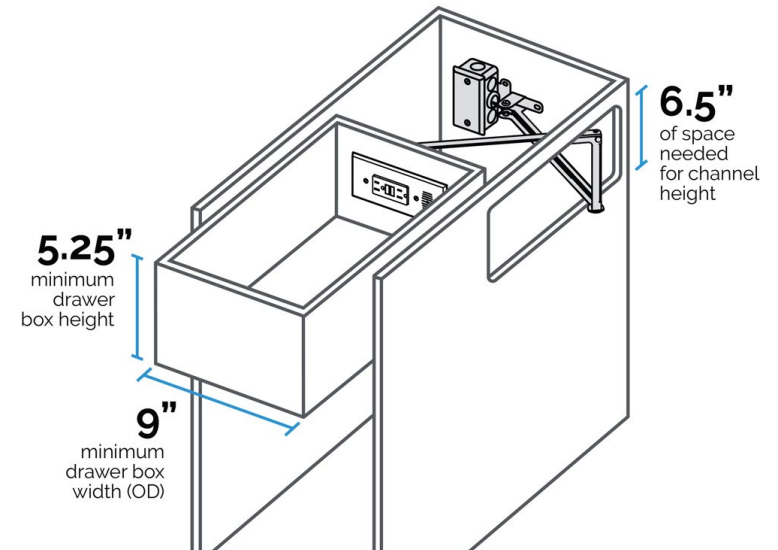

Want to power more devices? You may be interested in our Style Drawer Blade Duo series of powering outlets.

Style Drawer 24 Blade part #: 0290-00324

In-Drawer Outlet Dimensions

Outlet Width	15.59" (396mm)
Outlet Height	6.5" (165mm)
Outlet Depth	2.5" (64mm)
Receptacle Box Depth	2.03" (52mm)
Cover Plate Height	3.08" (78mm)
Cover Plate Width	7.13" (181mm)

Front View

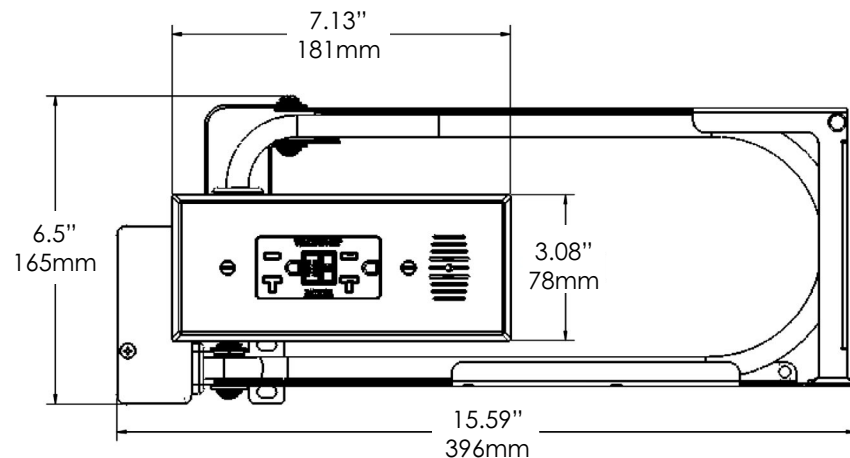

Top View

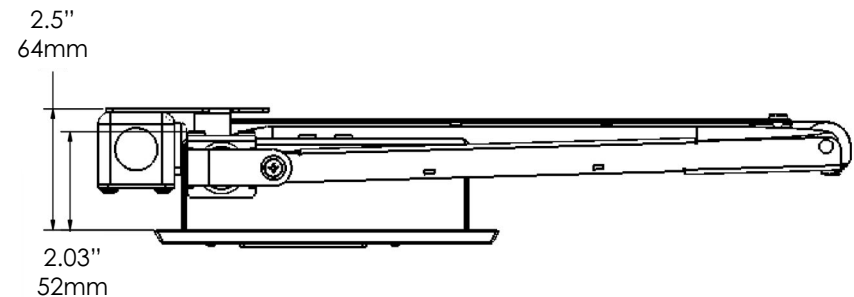

Style Drawer 24 Blade part #: 0290-00324

Cutout Template

Use the following cutout template for the receptacle box cutout on the back of your drawer box. For additional installation instructions, please reference the [Style Drawer Blade Installation Manual](#).

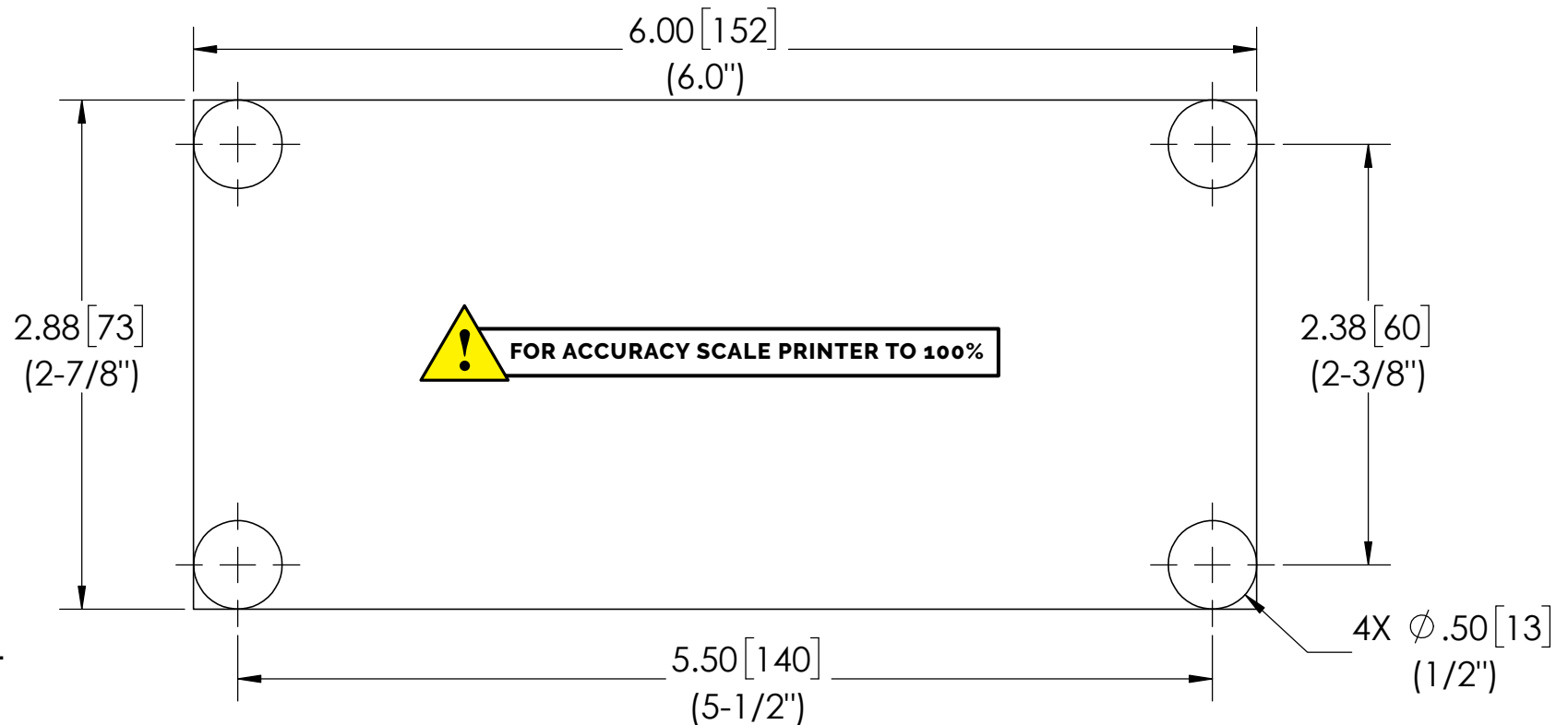

Measurements shown in:
inches [mm]
(inches fractional)

Style Drawer 24 Blade part #: 0290-00324

Electrical Planning Guide (Overview)

Style Drawer Blade Powering Outlets are ETL & CSA Listed and comply with UL 962a when installed in accordance to the outlet's installation instructions. The following is a guide designed to provide steps for roughing-in an electrical supply for your outlet installation. Please also review the specific installation instructions for each outlet.

A licensed electrician needs to supply all electrical rough-ins to local building codes for your installation. All powering outlets come with 20A tamper proof outlets and require a 20 amp circuit. All wiring inside of a cabinet must be MC Cable.



Need to Access our Electrical Certifications?

All of our electrical listing can be found [online in our Support Library](#).

Where NOT to Locate the In-Cabinet Electrical Supply

One location that we caution is directly behind the drawer where the outlet is being installed. If this location is utilized, you must ensure that the in-cabinet outlet and wiring do not interfere with the Docking Drawer cable management arms or drawer slides.

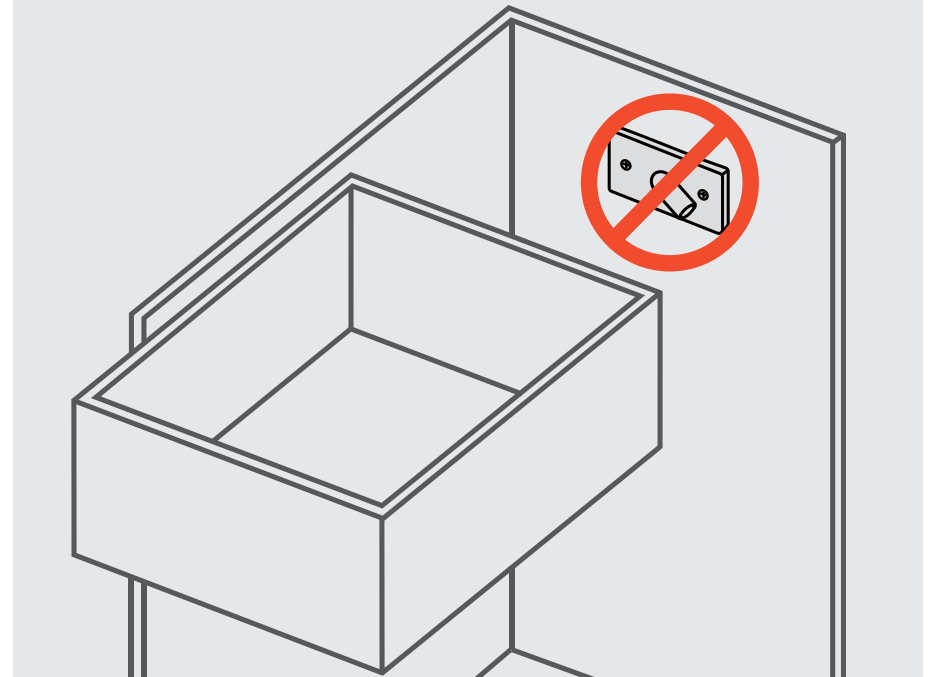

Style Drawer 24 Blade part #: 0290-00324

Electrical Planning Guide (Making the Electrical Connection)

Making the Electrical Connection from the In-Cabinet Outlet to the In-Drawer Outlet

Top Left or Right
(Cord running
under countertop)

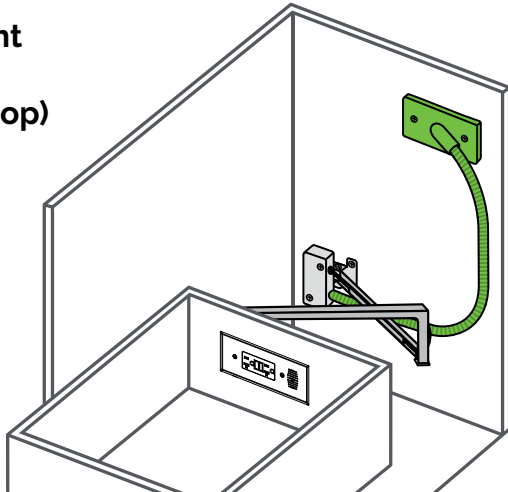

Right Under the
Drawer Box

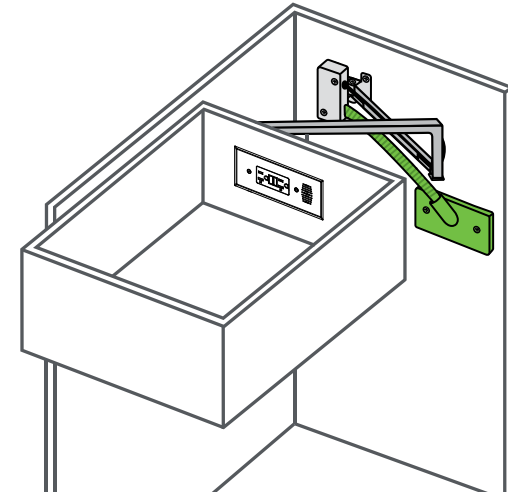

Bottom

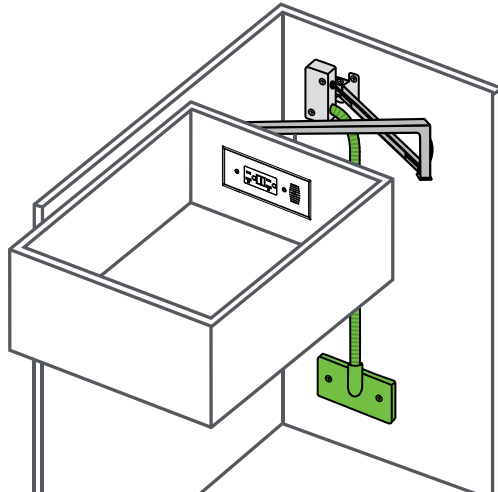

Left of the
Handy Box

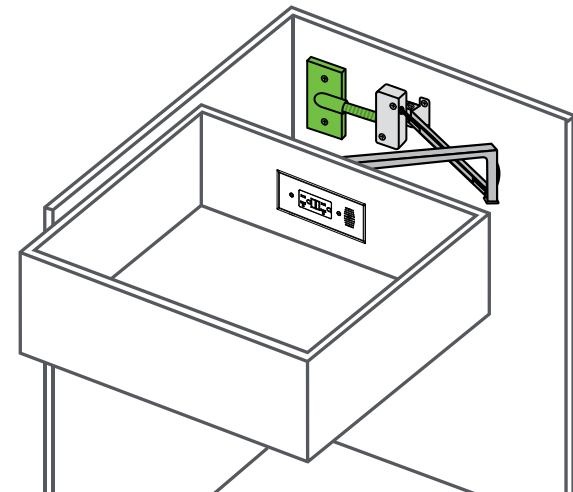

*Items marked in green are not included

Style Drawer 24 Blade part #: 0290-00324-I, 0290-00324-UI and 0290-00324-UC-I

Electrical Planning Guide (Interlock Box)

Style Drawer Interlock Box

What Does it Do?

The Interlock Box serves as a safety interlock which de-energizes the outlet when the drawer starts to close.

The micro switch detects the position of the drawer box causing the Style Drawer Blade Interlock Box to de-energize the outlet when the drawer starts to close. And as with all our products, this low voltage switch has been extensively cycle tested to ensure trouble-free use.

For our customers in the United States and Mexico, the Style Drawer Interlock Box is not required to pass electrical inspections; however, it can be used to provide an additional level of safety.

For our Canadian customers, the Style Drawer Interlock Box satisfies the requirements listed in section 26-710 of the Canadian Electrical Code (CEC) that stipulates the outlet is de-energized when a drawer is closed. Style Drawer Blade outlets with Interlock Box are CSA Listed and Approved for installation in Canada.

Outlet De-energized

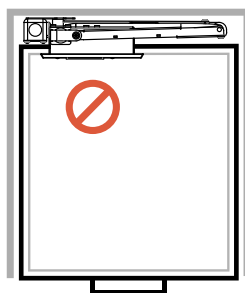

Outlet Energized

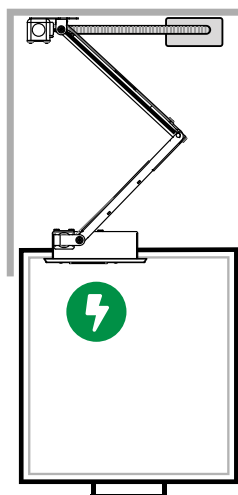

Installation

The Style Drawer Interlock Box is easily installed between the cabinet's electrical supply and the Style Drawer Blade handy box.

For additional instructions, please reference our Style Drawer Interlock Box installation manual.

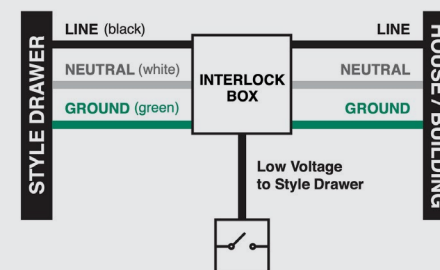
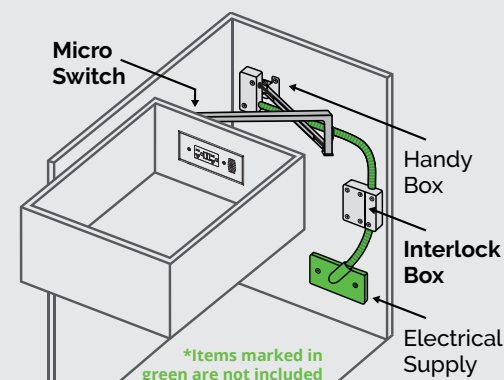

Style Drawer 24 Blade part #: 0290-00324

Additional Resources



DXF & Step Files

<https://bit.ly/3dnFMKo>



Installation Manual

<https://bit.ly/3eqZyFT>



Electrical Certifications

<https://bit.ly/3dn1L3X>

We're Here to Help

sales@dockingdrawer.com

Email us here with your sales questions, help selecting the right outlet or to request any literature.



support@dockingdrawer.com

Email us here with your technical and project planning questions or any other specification questions.

Style Drawer 21 Blade

part #: 0290-00321



Style Drawer 21 Blade

Understanding Docking Drawer Part Numbers

0290-00321W-U



Outlet Size Finish Configuration

1 Outlet Size

00324 - Style Drawer 24 Blade

00321 - Style Drawer 21 Blade

2 Finish

- Black

W - White

S - Stainless Steel

3 Configuration

- 2 AC - GFCI

U - 2 AC & 2 USB-A

UC - 2 AC & 2 USB-C

I - 2 AC - GFCI with Interlock Box

UI - 2 AC & 2 USB-A with Interlock Box

UC-I - 2 AC & 2 USB-C with Interlock Box

Style Drawer 21 Blade Part Numbers

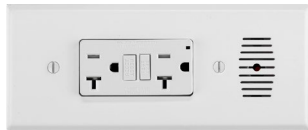

2 AC - GFCI

0290-00321

BEST
SELLER



2 AC - GFCI with Interlock Box

0290-00321-I



2 AC & 2 USB-A

0290-00321-U



2 AC & 2 USB-A with Interlock Box

0290-00321-UI



2 AC & 2 USB-C

0290-00321-UC



2 AC & 2 USB-C with Interlock Box

0290-00321-UC-I

Style Drawer 21 Blade part #: 0290-00321

Available Finishes

wonderful in
WHITE



beautiful in
BLACK



sexy in
STAINLESS



Style Drawer 21 Blade part #: 0290-00321

Features	
Electrical Listing	ETL Listed, <u>CSA Listed</u> with <u>Interlock Box</u>
Country of Use	Certified for use in the U.S., Certified for use in Canada with Interlock Box
Interlocking Safety Features	Interlock Thermostat - De-energizes outlet when the temperature exceeds 120°F (49°C) Interlock Box - Microswitch de-energizes outlet when the drawer starts to close
Electrical Connection	Hardwired
Cable Protection	Ultra flexible cable jacket and cable strain reliefs prevent tension and wear
Available Outlet Finishes	White, Black or Stainless Steel
Warranty	2 Years
Country of Origin	Made in Mexico

Outlet Specifications	
Tamper Resistant	Yes
2 AC GFCI	2 AC: 20 amps @ 120 VAC
2 AC & 2 USB-A	2AC: 20 amps @ 120 VAC USB: 3.6 amps @ 5 VDC
2 AC & 2 USB-C	2AC: 20 amps @ 120 VAC USB-C (PD Device): 3 amps @ 9 VDC USB-C (Non-PD Device): 3 amps @ 5 VDC

Style Drawer 21 Blade part #: 0290-00321

Will it Fit in My Cabinet?

Our outlets come in a variety of sizes that offer different ranges of extensions. To find the size that works for you, first measure your cabinet.

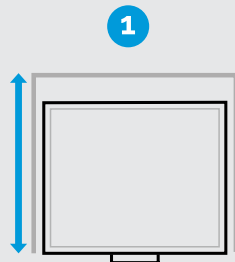

Start your project by measuring the cabinet's depth.

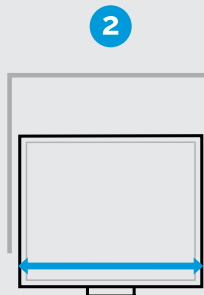

Measure the drawer box width (OD).

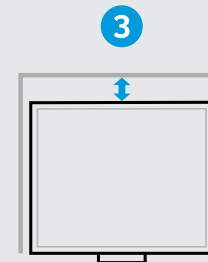

Then measure space available behind the drawer box.

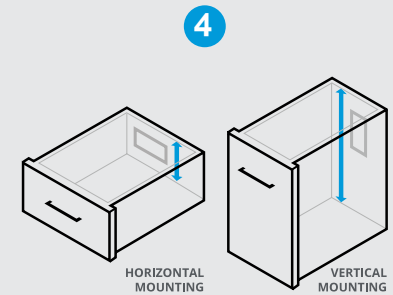

Then measure the interior drawer box height.

Horizontal Mounting Cabinet Specifications

1 Cabinet Depth	21" or less (533mm or less)
2 Minimum Drawer Box Width (OD)	14.5" or more (368mm or more) if drawer box height is more than 5.25" (133mm) 16.25" or more (413mm or more) if drawer box height is more than 4" (102mm)
3 Minimum space behind drawer box	2" or more (51mm or more)
4 Minimum interior drawer box height	4-5.25" (102-133mm)

Have a narrow drawer or want to mount the outlet vertically?
Our modified cabinet specs are on the [next page](#).

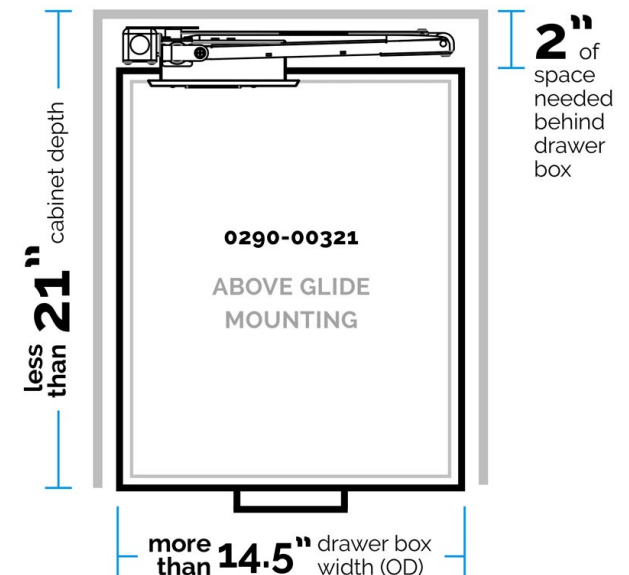

Style Drawer 21 Blade part #: 0290-00321

Vertical Mounting Cabinet Specifications

Cabinet Depth	21" or less (533mm or less)
Minimum Drawer Box Width (OD)	8" or more (203mm)
Minimum space behind drawer box	2" or more (51mm)
Minimum interior drawer box height	14.5" or more (368mm or more)

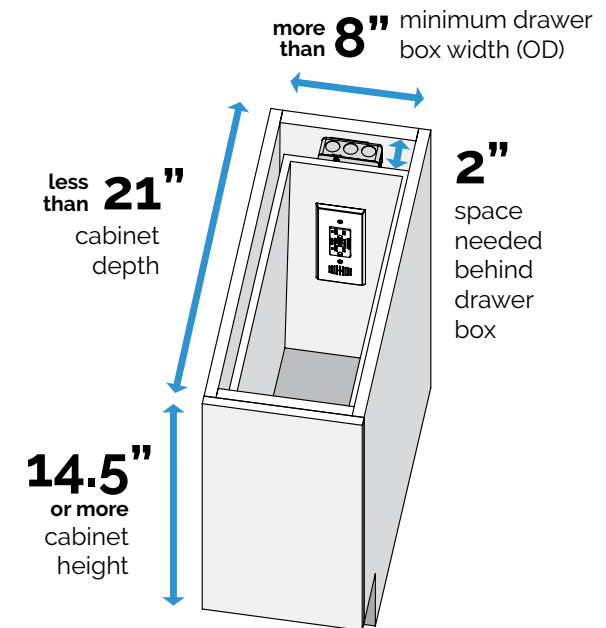

Narrow Drawer Cabinet Specifications

Cabinet Depth	21" or less (533mm or less)
Minimum Drawer Box Width (OD)	9" (229mm)
Minimum space behind drawer box	2" (51mm)
Minimum interior drawer box height	5.25" (133mm)
Minimum space needed for channel height	6.5" (165mm)

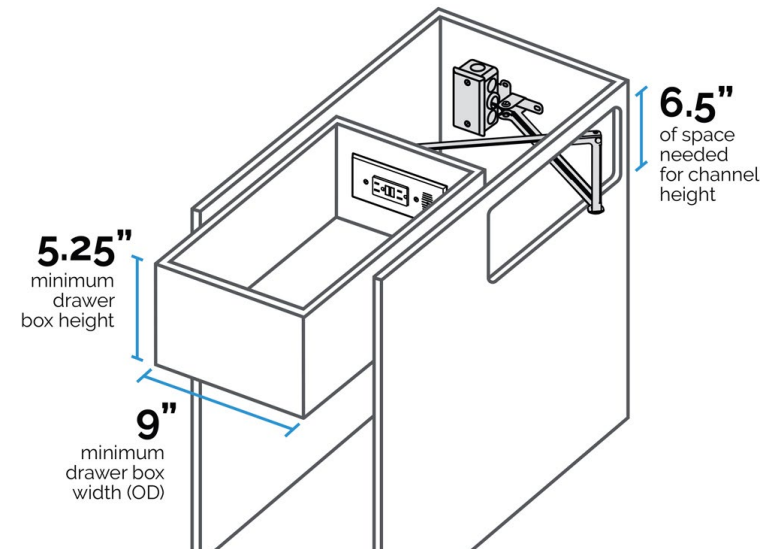

Want to power more devices? You may be interested in our Style Drawer Blade Duo series of powering outlets.

Style Drawer 21 Blade part #: 0290-00321

In-Drawer Outlet Dimensions

Outlet Width	14.09" (358mm)
Outlet Height	6.5" (165mm)
Outlet Depth	2.5" (64mm)
Receptacle Box Depth	2.03" (52mm)
Cover Plate Height	3.08" (78mm)
Cover Plate Width	7.13" (181mm)

Front View

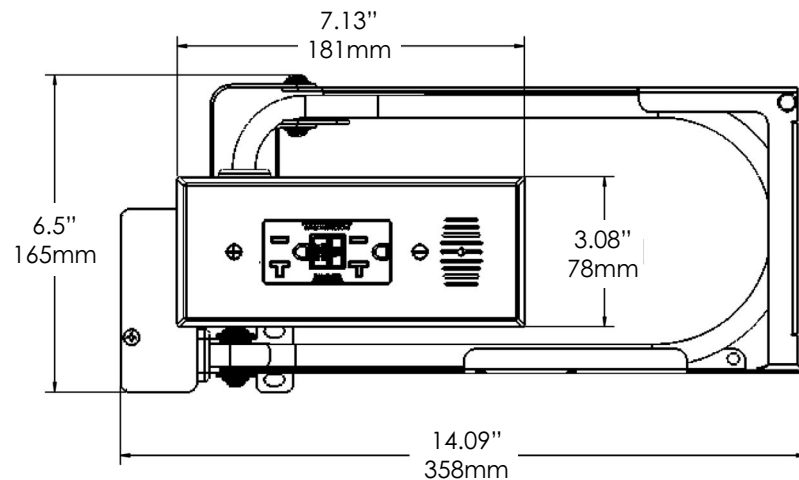

Top View

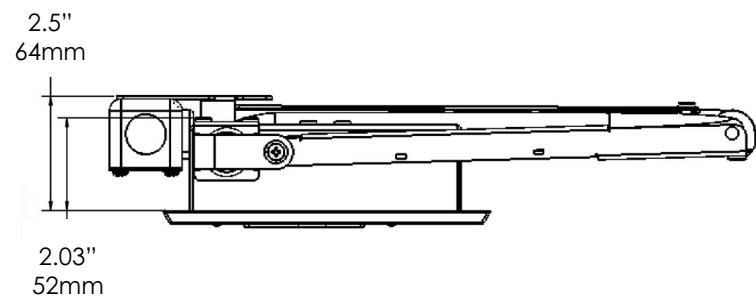

Style Drawer 21 Blade part #: 0290-00321

Cutout Template

Use the following cutout template for the receptacle box cutout on the back of your drawer box. For additional installation instructions, please reference the [Style Drawer Blade Installation Manual](#).

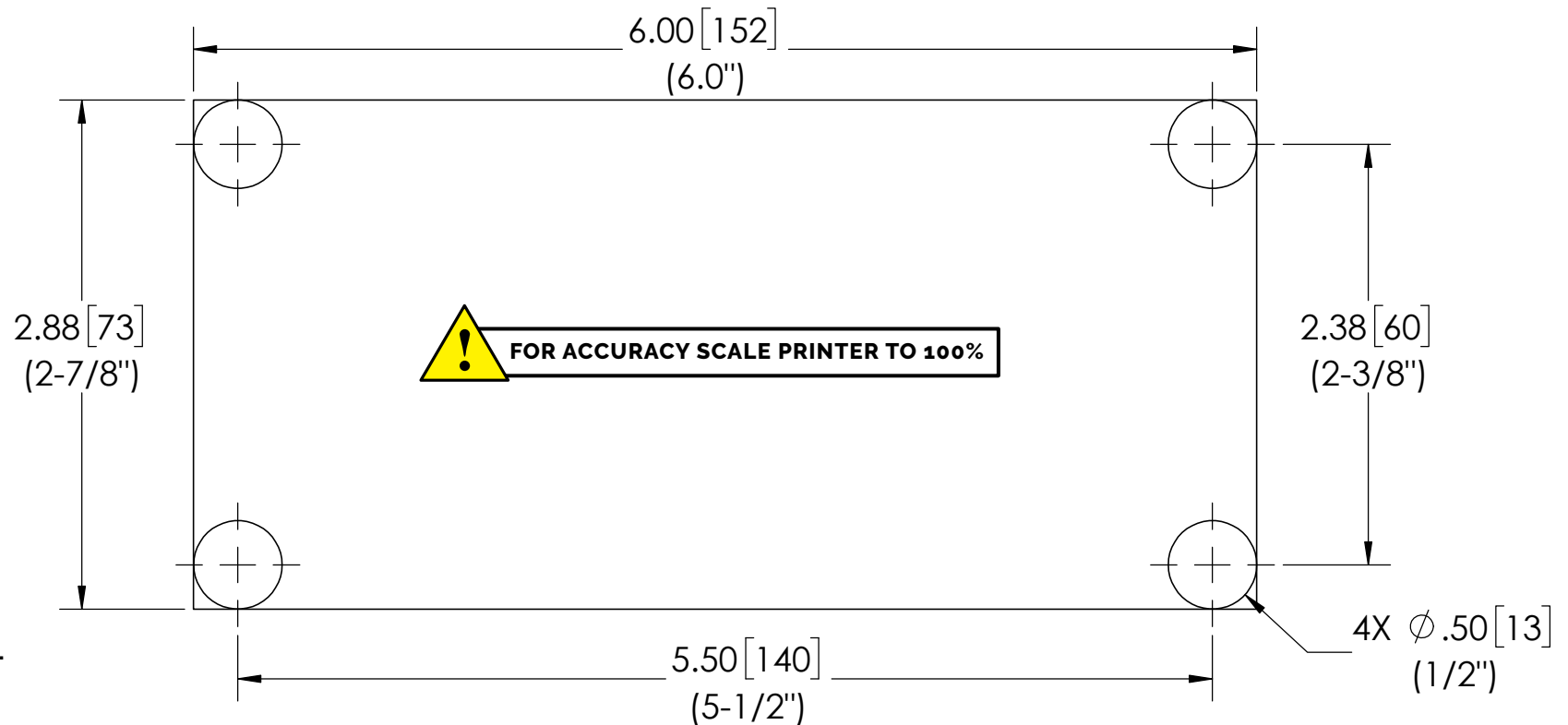

Measurements shown in:
inches [mm]
(inches fractional)

Style Drawer 21 Blade part #: 0290-00321

Electrical Planning Guide (Overview)

Style Drawer Blade Powering Outlets are ETL & CSA Listed and comply with UL 962a when installed in accordance to the outlet's installation instructions. The following is a guide designed to provide steps for roughing-in an electrical supply for your outlet installation. Please also review the specific [installation instructions](#) for each outlet.

A licensed electrician needs to supply all electrical rough-ins to local building codes for your installation. All powering outlets come with 20A tamper proof outlets and require a 20 amp circuit. All wiring inside of a cabinet must be MC Cable.



Need to Access our Electrical Certifications?

All of our electrical listing can be found [online in our Support Library](#).

Where NOT to Locate the In-Cabinet Electrical Supply

One location that we caution is directly behind the drawer where the outlet is being installed. If this location is utilized, you must ensure that the in-cabinet outlet and wiring do not interfere with the Docking Drawer cable management arms or drawer slides.

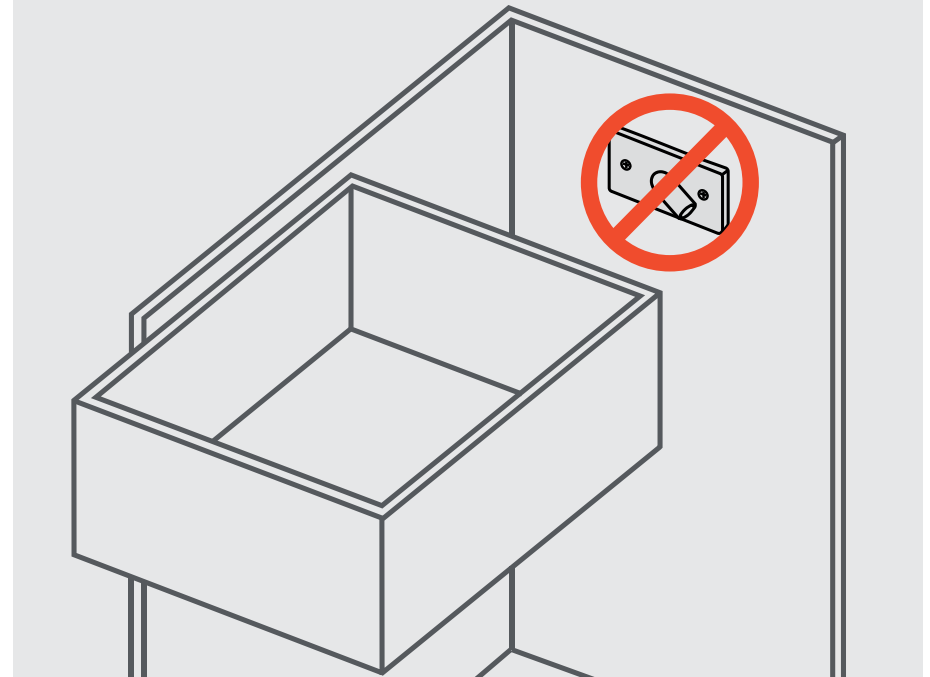

Electrical Planning Guide (Making the Electrical Connection)

Making the Electrical Connection from the In-Cabinet Outlet to the In-Drawer Outlet

Top Left or Right
(Cord running
under countertop)

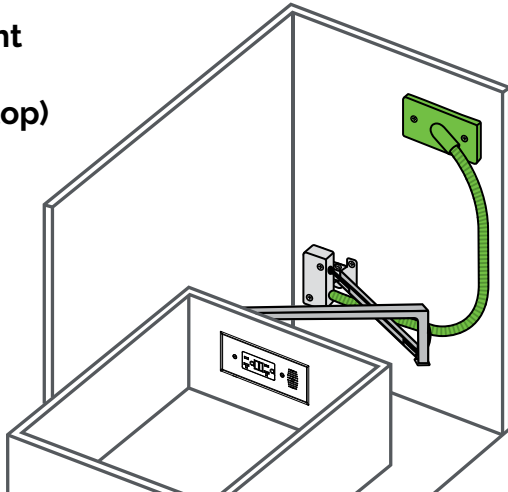

Right Under the
Drawer Box

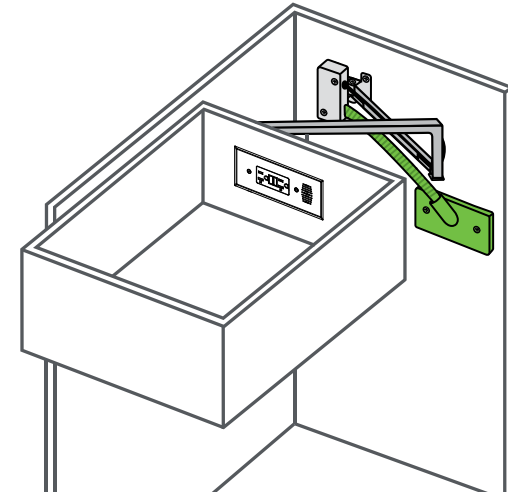

Bottom

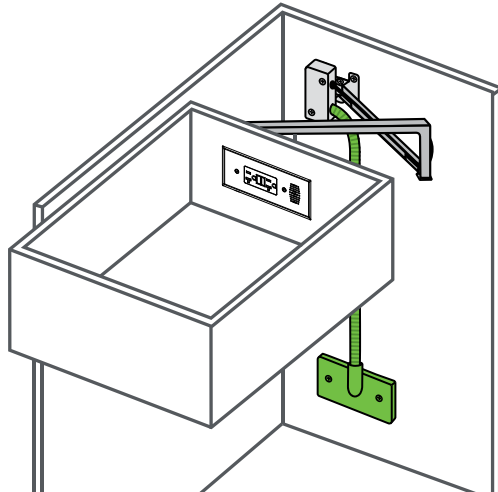

Left of the
Handy Box

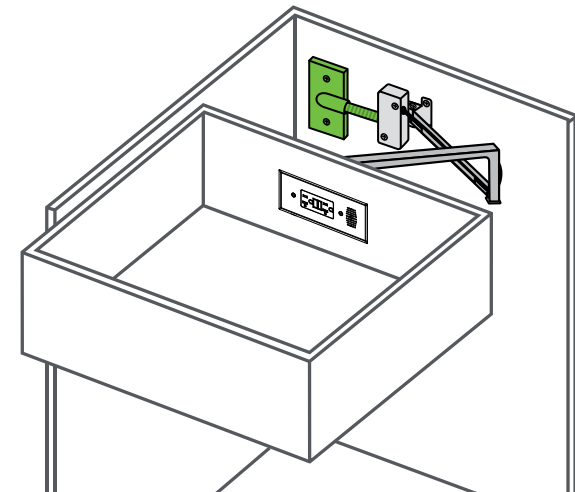

*Items marked in green are not included

Style Drawer 21 Blade part #: 0290-00321-I, 0290-00321-UI and 0290-00321-UC-I

Electrical Planning Guide (Interlock Box)

Style Drawer Interlock Box

What Does it Do?

The Interlock Box serves as a safety interlock which de-energizes the outlet when the drawer starts to close.

The micro switch detects the position of the drawer box causing the Style Drawer Blade Interlock Box to de-energize the outlet when the drawer starts to close. And as with all our products, this low voltage switch has been extensively cycle tested to ensure trouble-free use.

For our customers in the United States and Mexico, the Style Drawer Interlock Box is not required to pass electrical inspections; however, it can be used to provide an additional level of safety.

For our Canadian customers, the Style Drawer Interlock Box satisfies the requirements listed in section 26-710 of the Canadian Electrical Code (CEC) that stipulates the outlet is de-energized when a drawer is closed. Style Drawer Blade outlets with Interlock Box are CSA Listed and Approved for installation in Canada.

Outlet De-energized

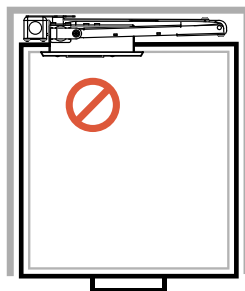

Outlet Energized

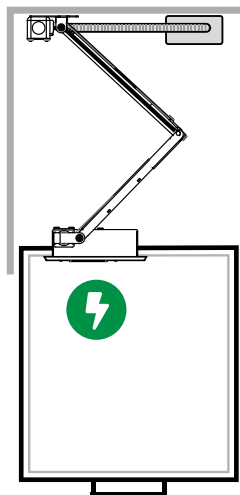

Installation

The Style Drawer Interlock Box is easily installed between the cabinet's electrical supply and the Style Drawer Blade handy box.

For additional instructions, please reference our Style Drawer Interlock Box installation manual.

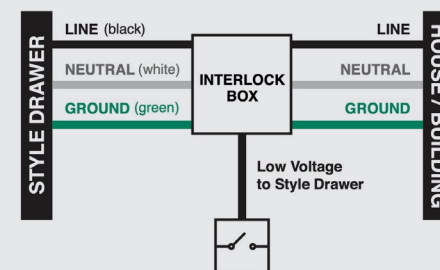
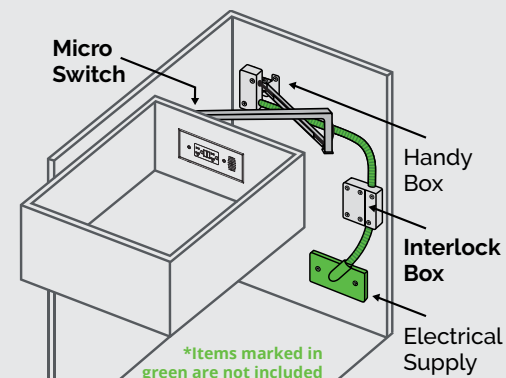

Style Drawer 21 Blade part #: 0290-00321

Additional Resources



DXF & Step Files

<https://bit.ly/3dnFMKo>



Installation Manual

<https://bit.ly/3eqZyFT>



Electrical Certifications

<https://bit.ly/3dn1L3X>

We're Here to Help

sales@dockingdrawer.com

Email us here with your sales questions, help selecting the right outlet or to request any literature.



support@dockingdrawer.com

Email us here with your technical and project planning questions or any other specification questions.