

Docking Drawer®

Blade Series

PROJECT PLANNING CARDS

2	Kitchens
15	Bathrooms
38	Closets
31	Offices
36	Bedrooms
40	Entryways
43	Living Rooms
47	Commercial
52	Installation Tips

Kitchens

- 3 Shallow Drawer
- 4 Island Drawer
- 5 Appliance Garage
- 6 Appliance Drawer
- 7 Above Counter Drawer
- 8 Message Center
- 9 Broom Pull Out
- 10 Waste Pull Out
- 11 Sideboard
- 12 Booth
- 13 Bench
- 14 Nook



Docking Drawer Blade Series outlets can be specified into the top, often shallow kitchen cabinet drawer to create a dedicated drawer charging station and keep tech devices and cord clutter off of kitchen countertops.

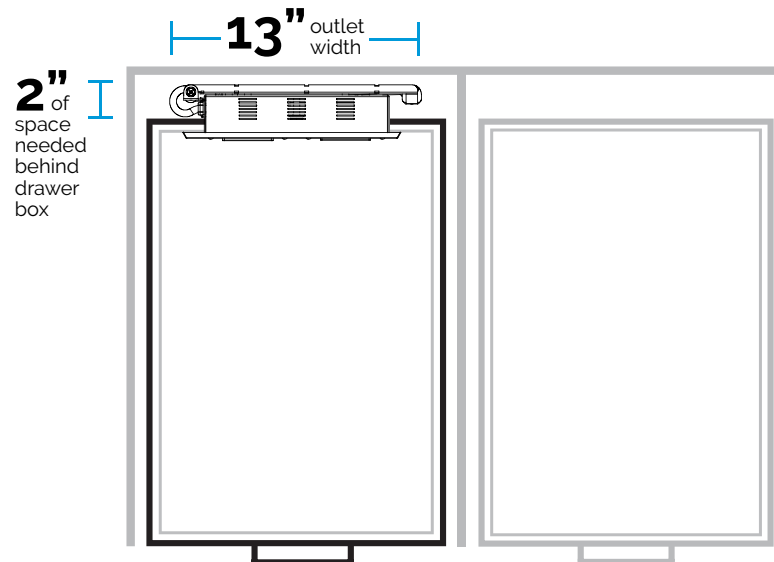
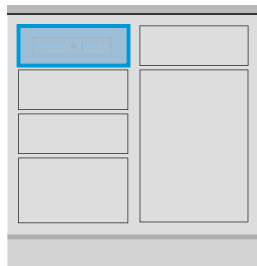

Pro Tip

Docking Drawer Blade Duo outlets can be center mounted in a 15" (OD) wide drawer box and Docking Drawer Blade outlets can be center mounted in a 20" (OD) wide drawer box.

Most Popular Outlet:
15 amp Blade Duo In
Drawer Outlet-1514-232



Docking Drawer Blade Series outlets can be specified into wide kitchen island drawers to create a dedicated drawer charging station and keep tech devices and cord clutter off of kitchen island surfaces.

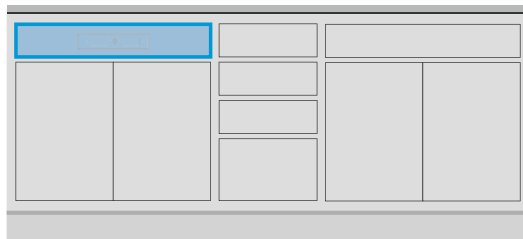

2" of space needed behind drawer box

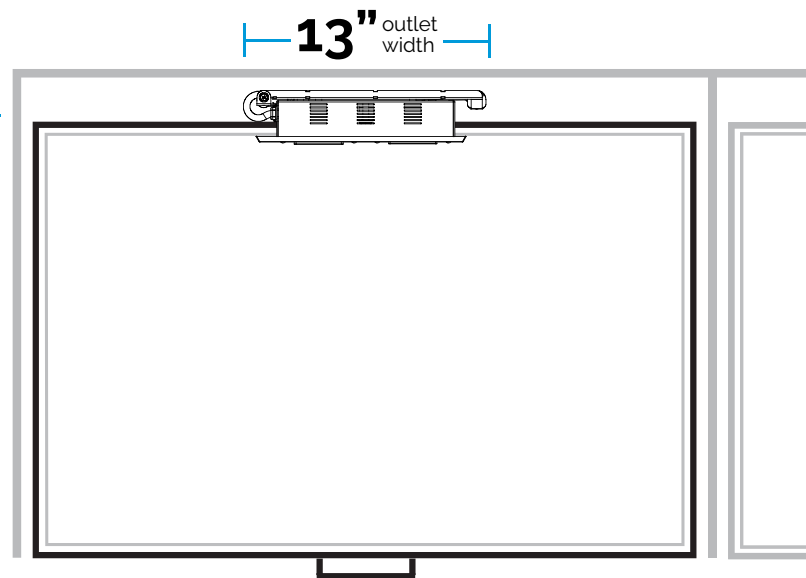

Pro Tip

Large kitchen islands maximize storage by utilizing 24 - 27" deep drawer boxes. To add a Blade Series outlet into this type of drawer, see Docking Drawer Blade Series Deep Cabinet outlets.

Most Popular Outlet:
15 amp Blade Duo In
Drawer Outlet-1514-232



Docking Drawer Blade Series outlets can be specified into kitchen cabinet pull outs to create an appliance garage, commonly used to stow and power small kitchen appliances.

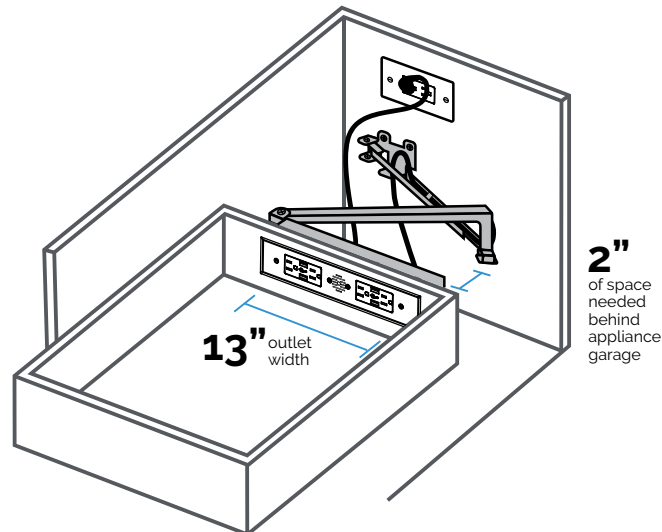
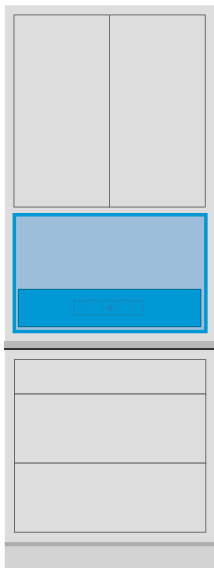

Pro Tip

All Docking Drawer Blade Series outlets can be configured with a Safety Interlock Box (available from Docking Drawer and sold separately) which de-energizes the outlet when the drawer starts to close. The Safety Interlock Box is commonly used in Canada and in appliance garage applications.

Most Popular Outlet:
15 amp Blade Duo In
Drawer Outlet-1514-266



Docking Drawer Blade Series outlets can be specified into kitchen appliance drawers to create a dedicated space to stow and power small kitchen appliances.

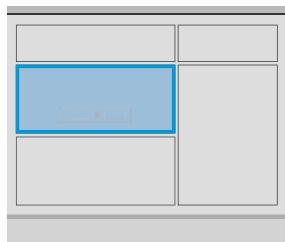

2" of space needed behind drawer box

13" outlet width

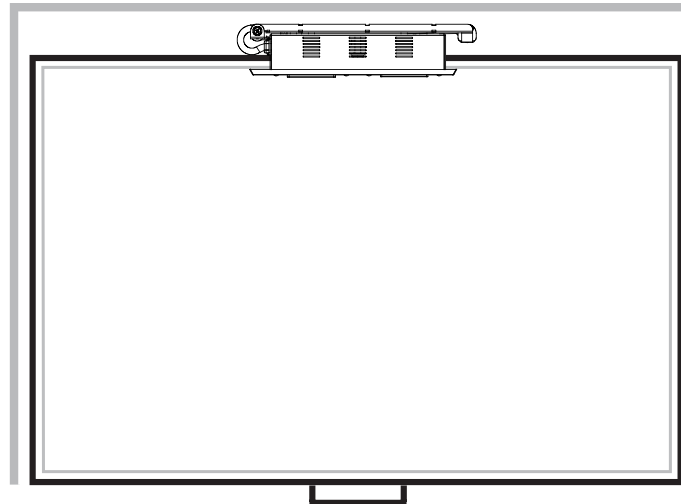

Pro Tip

All Docking Drawer Blade Series outlets can be configured with a Safety Interlock Box (Available from Docking Drawer and sold separately) which de-energizes the outlet when the drawer starts to close. The Safety Interlock Box is commonly used in Canada and in appliance garage applications.

Most Popular Outlet:
15 amp Blade Duo In Drawer Outlet-1514-266



Docking Drawer Blade Series outlets can be specified into above counter drawers to create a dedicated charging station for phones, tablets and other everyday tech while keeping countertops clear of cord and device clutter.

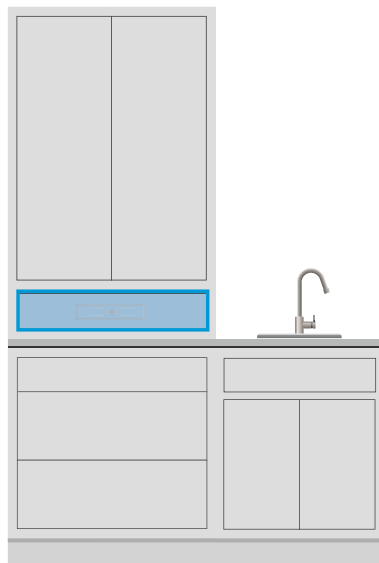

2" of space needed behind drawer box

13" outlet width

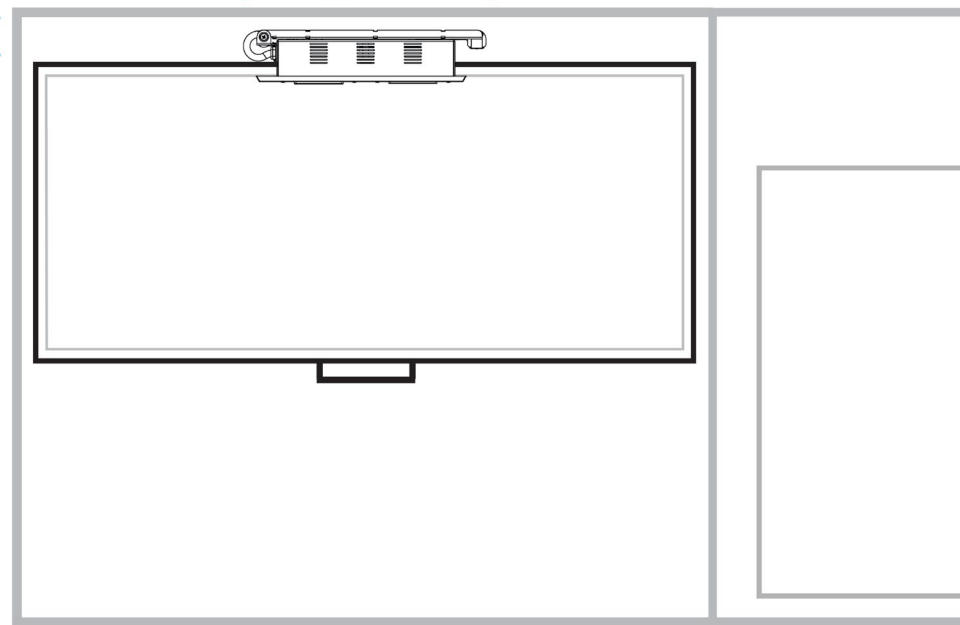

Pro Tip

Above counter drawers are typically 15" or 18" deep. Blade Series outlets extend up to 24" and fit this application perfectly.

Most Popular Outlet:
15 amp Blade In Drawer
Outlet-1514-160



Docking Drawer Blade Series outlets can be specified into kitchen cabinet drawers to create a dedicated message center to charge laptops, tablets, phones and other technology while remaining tucked out of sight and clear of spills and other countertop hazards.

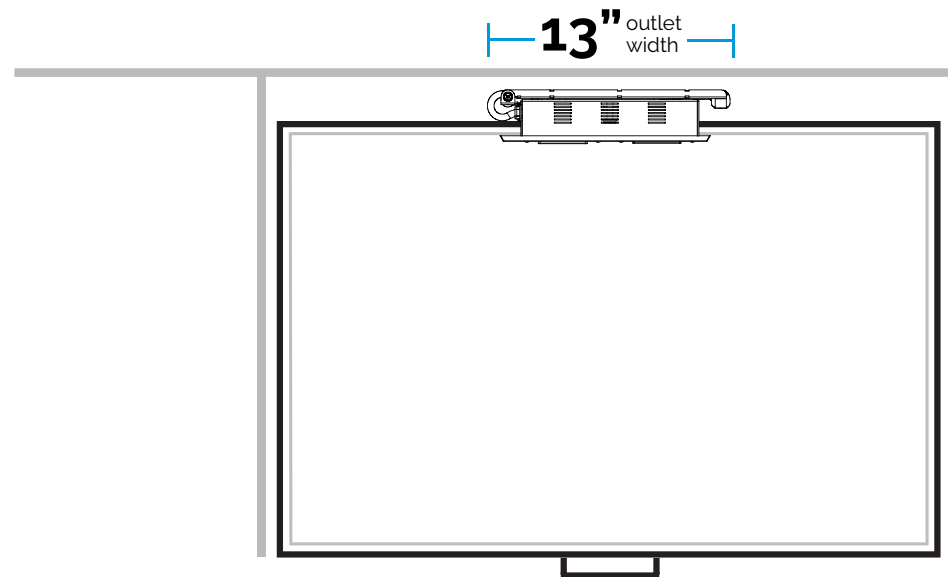
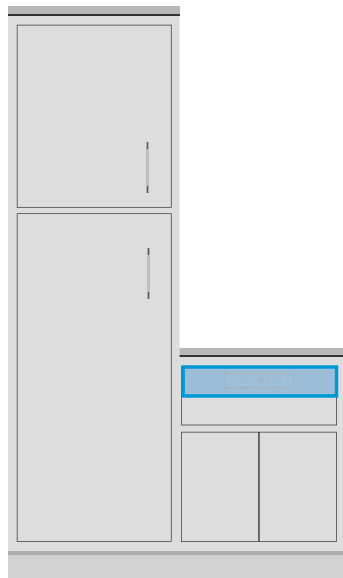

2" of
space
needed
behind
drawer
box

Need Mounting Diagrams?

Download resources at
[dockingdrawer.com/
downloads](https://dockingdrawer.com/downloads)

Most Popular Outlet:
15 amp Blade Duo In
Drawer Outlet-1514-232



Docking Drawer Blade Series outlets can be specified into kitchen broom closets to charge cordless vacuums and other cleaning accessories while remaining neatly tucked away and out of sight.

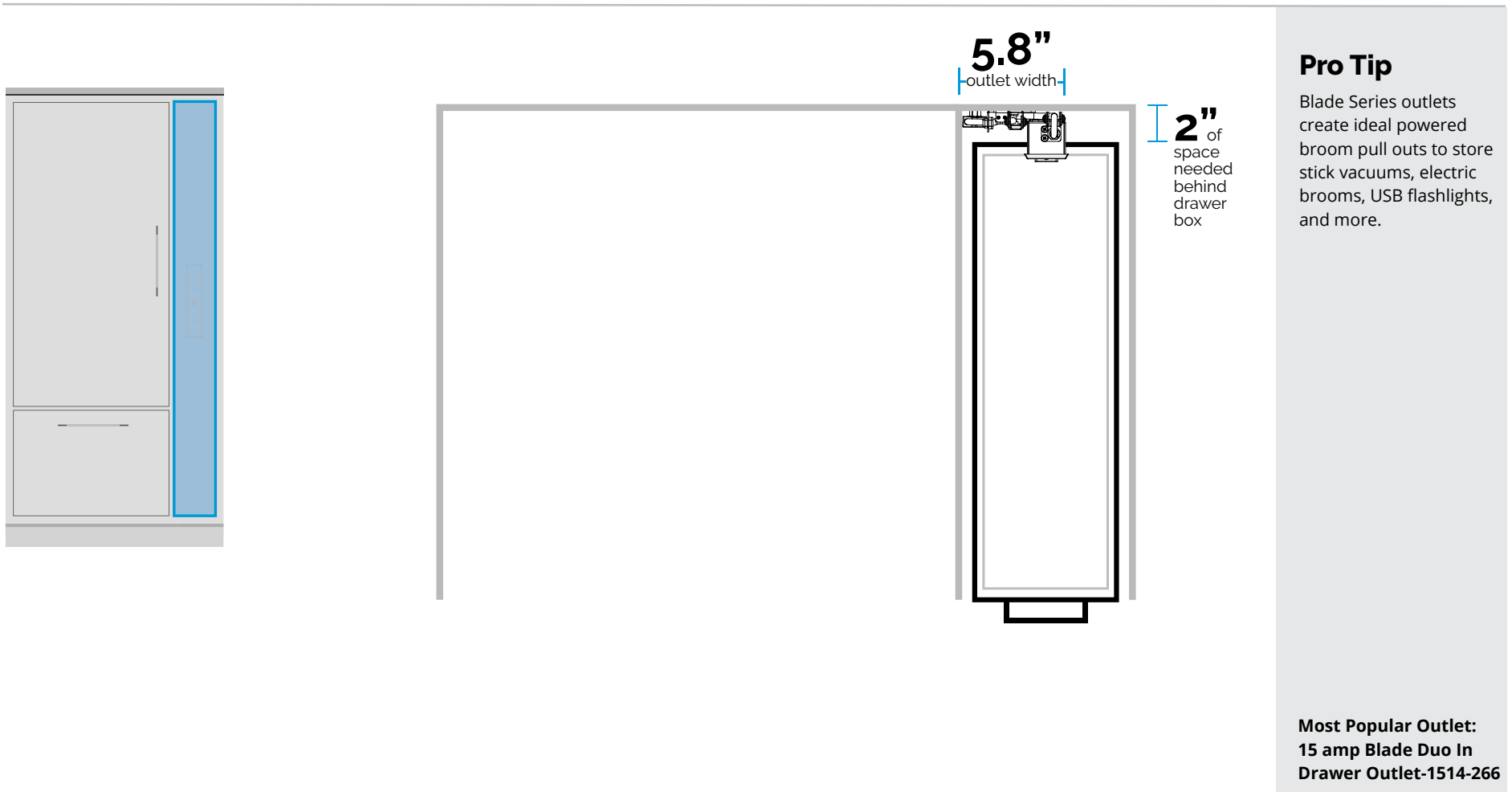



Docking Drawer Blade Series outlets can be specified into kitchen waste pull outs to power automated drawer opening/closing functions, air fresheners and other custom features.

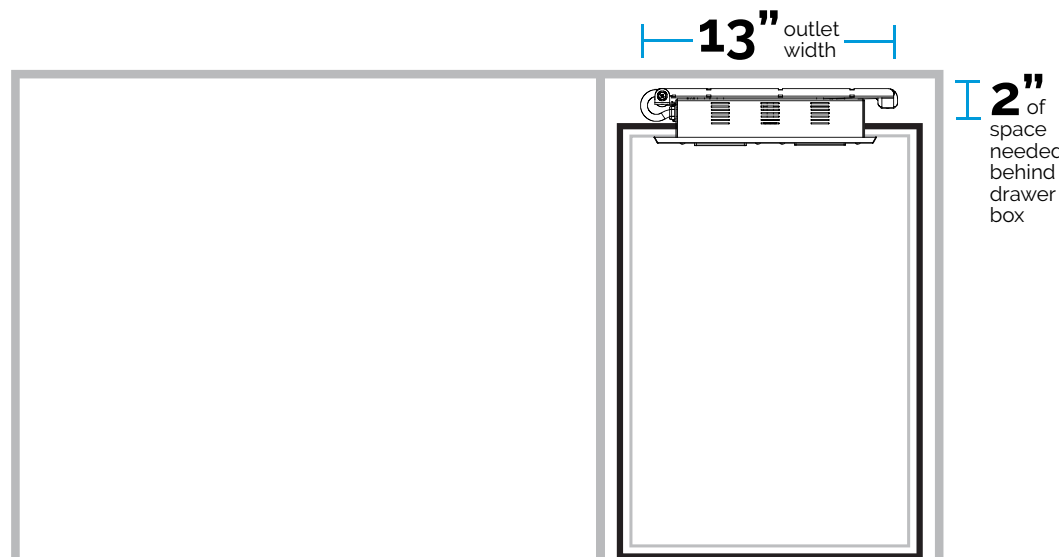
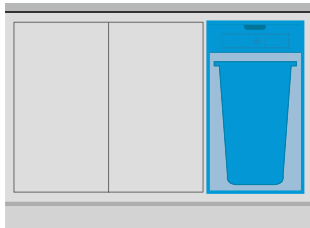

Need Mounting Diagrams?

Download resources at dockingdrawer.com/downloads

Most Popular Outlet:
15 amp Blade Duo In
Drawer Outlet-1514-232



Docking Drawer Blade Series outlets can be specified into kitchen sideboard drawers to create a dedicated space to plug tech and other devices, keeping them organized and charged while eliminating cord and device clutter from countertop surfaces.

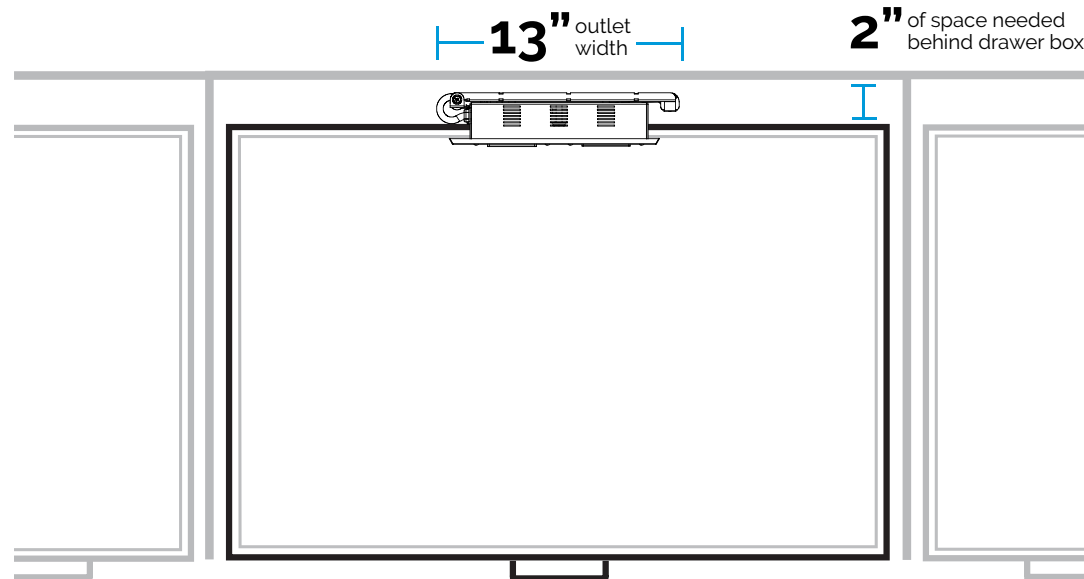
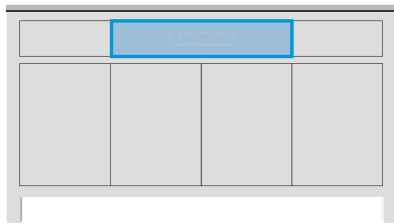

Pro Tip

In furniture projects, sometimes longer cords are desired to run discreetly across the furniture and down the side to an electrical outlet. If your project requires a longer or shorter cord than the standard 4.5' Blade Series cord, call us to learn more about custom lengths.

Most Popular Outlet:
15 amp Blade Duo In
Drawer Outlet-1514-232



Docking Drawer Blade Series outlets can be specified into kitchen booth drawers, creating a convenient space to charge tech and other devices nearby without taking over valuable table top space.

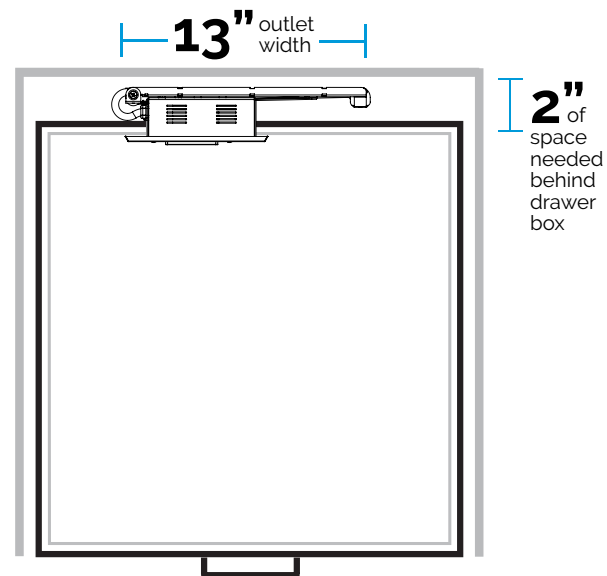
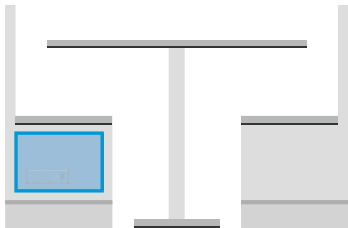

Need Mounting Diagrams?

Download resources at dockingdrawer.com/downloads

Most Popular Outlet:
15 amp Blade In Drawer
Outlet-1514-160



Docking Drawer Blade Series outlets can be specified into kitchen bench drawers, creating a convenient power source for charging tech and other devices nearby without taking over valuable table top space.

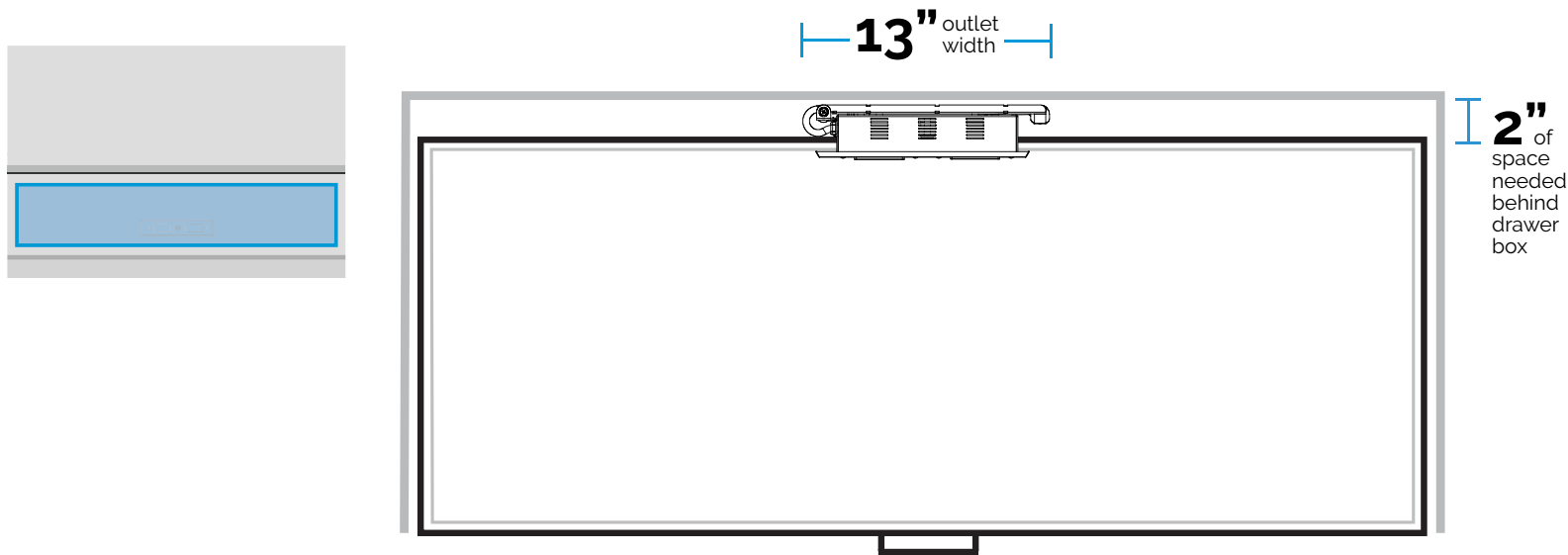

Need Mounting Diagrams?

Download resources at
dockingdrawer.com/downloads

Most Popular Outlets:
15 amp Blade Duo In
Drawer Outlet-1514-232

15 amp Blade Duo In
Drawer Outlet-1514-266



Docking Drawer Blade Series outlets can be specified into kitchen nooks to charge and power phones, bluetooth speakers and more while keeping surface areas clear of cord and device clutter.

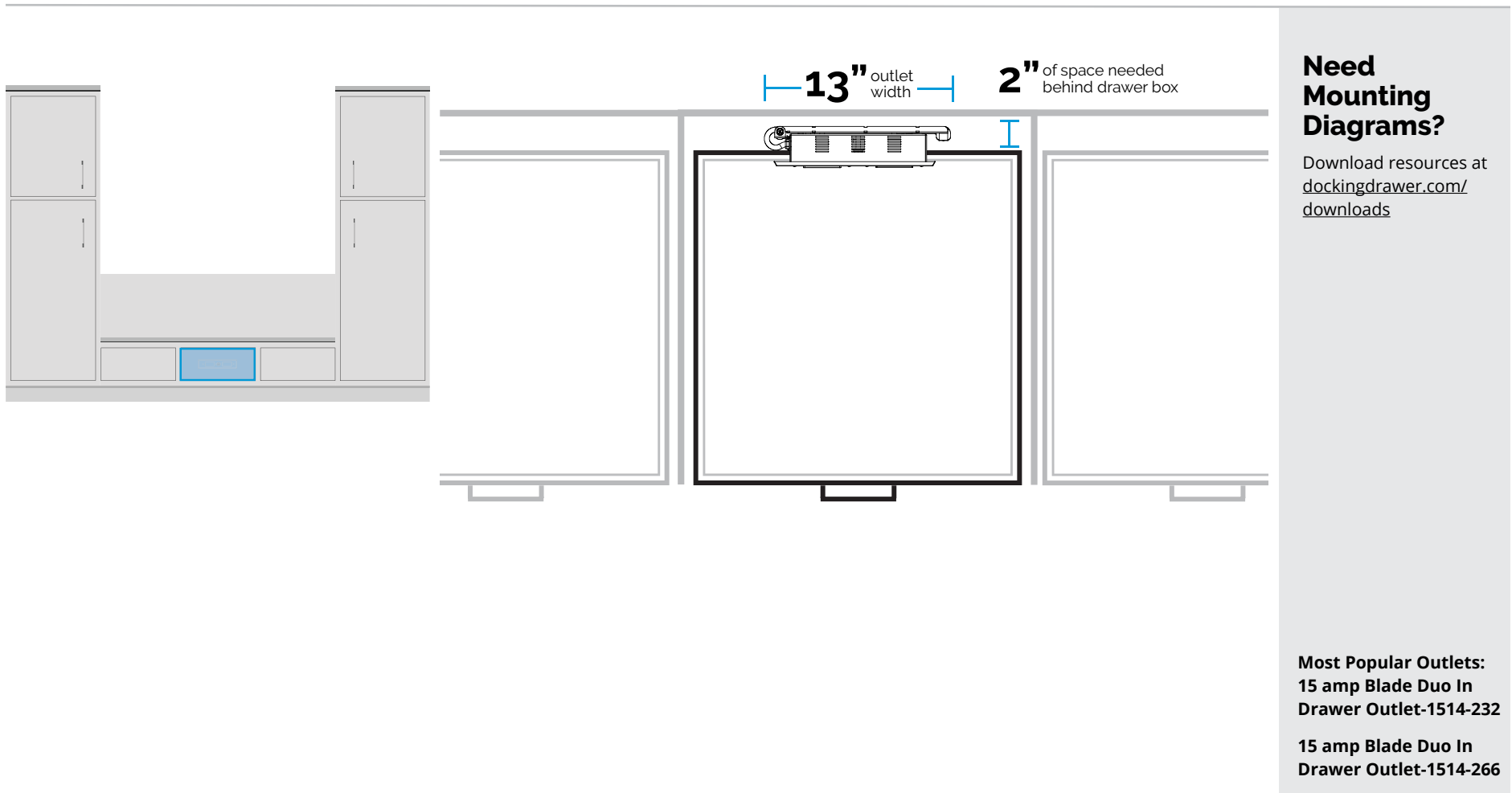



Bathrooms

- 16** Tall Vanity Drawer
- 17** Narrow Vanity Drawer
- 20** Short Vertical Drawer
- 21** Pull Out Organizer: Option 1
- 22** Pull Out Organizer: Option 2
- 23** U-Shaped Drawer
- 24** L-Shaped Pull Out
- 25** Powered Pull Out Shelf
- 26** Makeup Styling Desk: Option 1
- 27** Makeup Styling Desk: Option 2

Bathrooms Tall Vanity Drawer

[Download the Spec Book for more detailed specifications](#)



Docking Drawer Blade Series outlets can be specified into tall vanity drawers to stow and power hair dryers and other styling tools while keeping vanity surfaces clear of cord and device clutter.

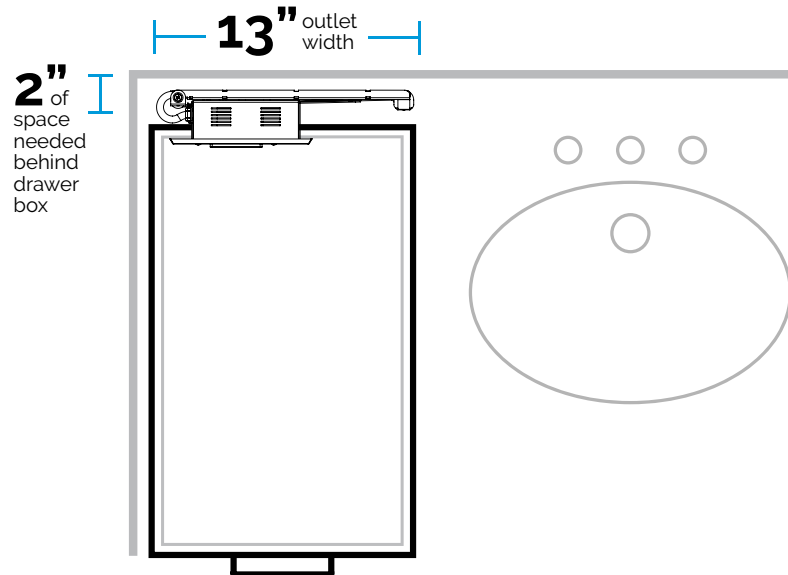
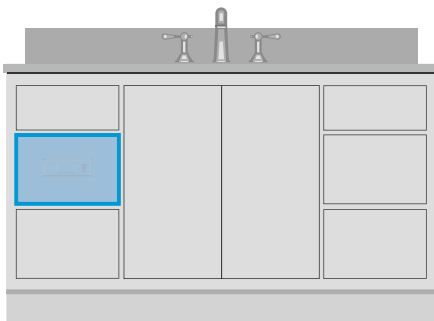

Pro Tip

Have narrow drawers? Refer to the following page for more detailed information on how to install Blade Series outlets into drawers as narrow as 9" wide.

Most Popular Outlet:
15 amp Blade In Drawer
Outlet-1514-160

Bathrooms Narrow Vanity Drawer

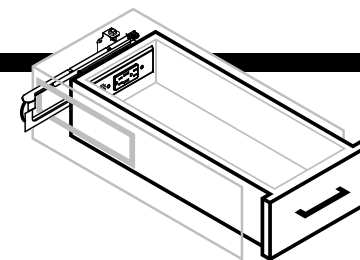

Docking Drawer Blade Series outlets can be specified into vanity drawers as narrow as 9" by creating a channel in the cabinet sidewall to allow space for the cable management arms to move freely.

Double Sink Vanity

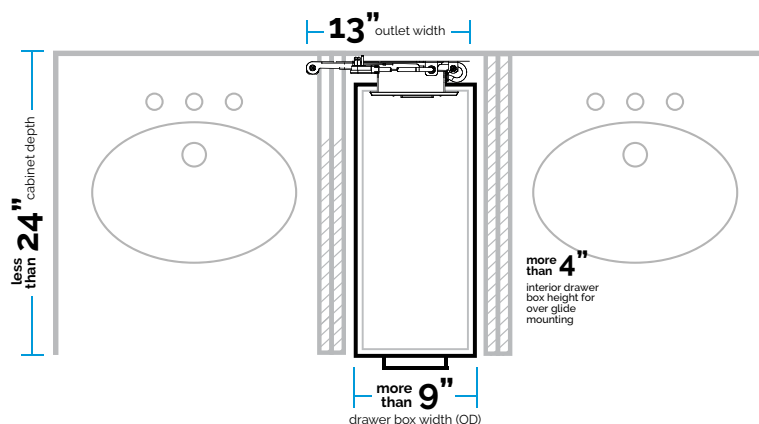
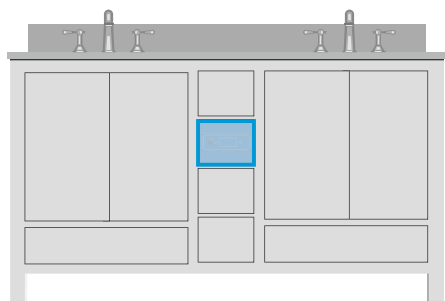

Pro Tip

Make sure the narrow drawer is tall enough to hold hot tools.

Studies show the top drawer is used for everyday items like a toothbrush, comb, etc. while the second drawer is the most popular drawer for hot tools, such as hair dryers and curling irons.

Single Sink Vanity

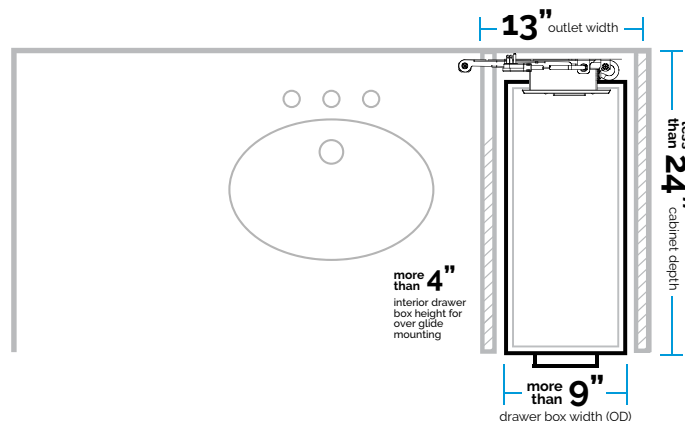
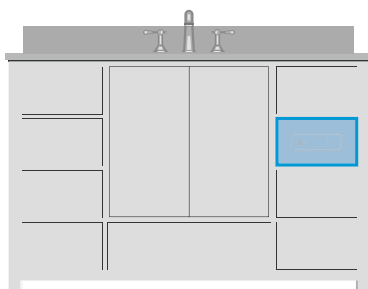

Need GFCI?

Plug a Blade Series outlet into a GFCI wall receptacle and pass on the GFCI properties to the in-drawer outlet.

Most Popular Outlet:
15 amp Blade In Drawer
Outlet-1514-160

Bathrooms Narrow Vanity Drawer: Left Mounting

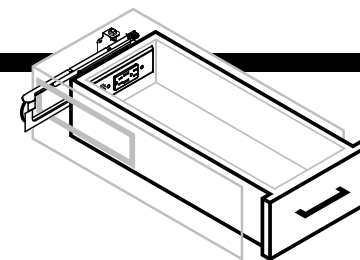

Docking Drawer Blade Series outlets can be left mounted into vanity drawers as narrow as 9" by flipping the outlet and creating a channel in the left cabinet sidewall to allow space for the cable management arms to move freely.

Left Side Channel

The outlet may be flipped so that the channel is on the left side of the cabinet wall.

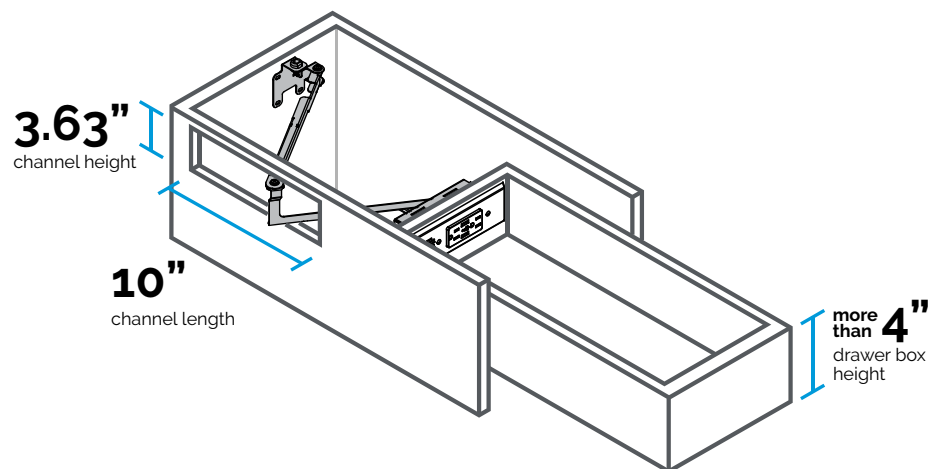

Pro Tip

Make sure the outlet is mounted high enough in the drawer box to ensure the cable management arms clear the drawer glides.

If the drawer is over 9" wide, the channel length can be less than 10" in length.

Rear View

Ensure the cable management guides are mounted high enough to clear the drawer glides.

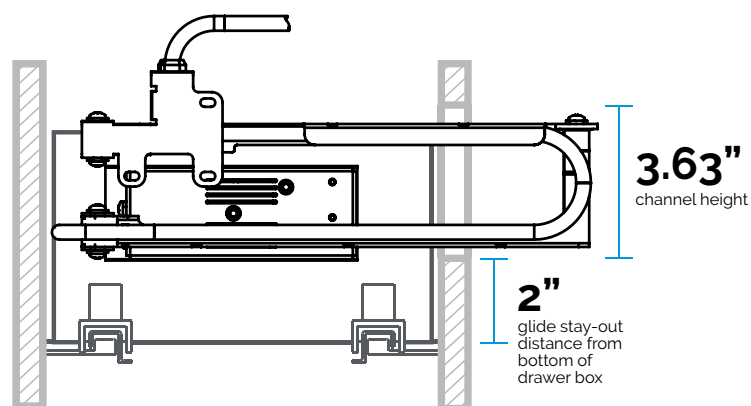

Docking Drawer Blade is ideal for Narrow Drawer installations. The Blade cover plate is 7.18" wide and it fits into a 9" wide (OD) drawer box. Docking Drawer Blade Duo cover plate is 11.26" wide and fits best into 13" wide tall drawer boxes or 15" wide shallow drawer boxes.

Most Popular Outlet:
15 amp Blade In Drawer
Outlet-1514-160

Bathrooms

Narrow Vanity Drawer: Right Mounting

Docking Drawer Blade Series outlets can be right mounted into vanity drawers as narrow as 9" by creating a channel on the right cabinet sidewall to allow space for the cable management arms to move freely.

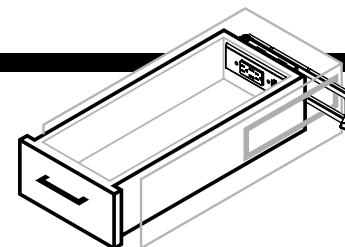

Right Side Channel

The channel dimensions for the cable management arms vary depending on your cabinet layout. In this example, the channel space needed is 3.63" x 10".

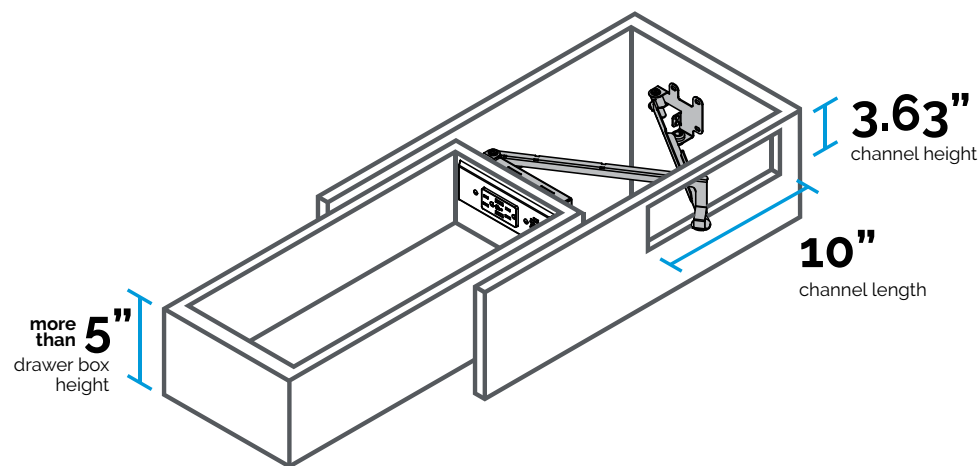

Pro Tip

Make sure the outlet is mounted high enough in the drawer box to ensure the cable management arms clear the drawer glides.

If the drawer is over 9" wide, the channel length can be less than 10" in length.

Docking Drawer Blade outlets are ideal for Narrow Drawer installations. The Blade cover plate is 7.18" wide and it fits into a 9" wide (OD) drawer box. Docking Drawer Blade Duo cover plate is 11.26" wide and fits best into 13" wide tall drawer boxes or 15" wide shallow drawer boxes.

Rear View

Ensure the cable management guides are mounted high enough to clear the drawer glides.

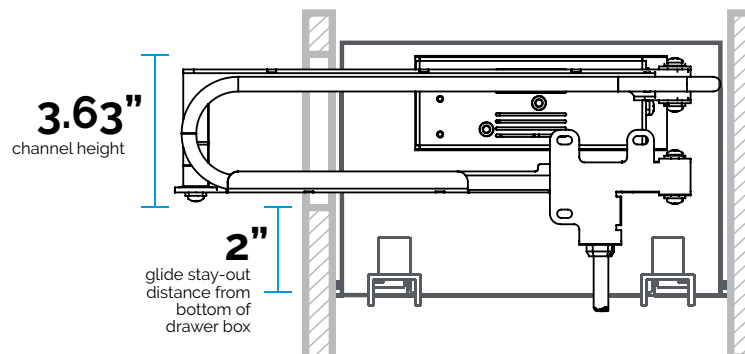

Most Popular Outlet:
15 amp Blade In Drawer
Outlet-1514-160

Bathrooms Short Vertical Drawer

[Download the Spec Book for more detailed specifications](#)



Docking Drawer Blade Series outlets can be specified into bathroom drawers as short as 10" by creating a channel on the bottom of the cabinet to allow space for the cable management arms.

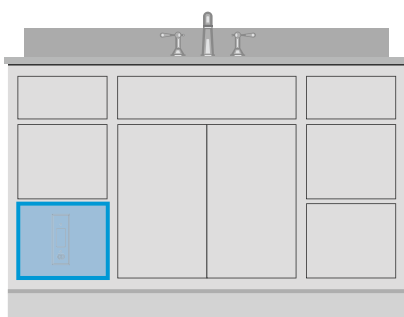

Option 1
without channel

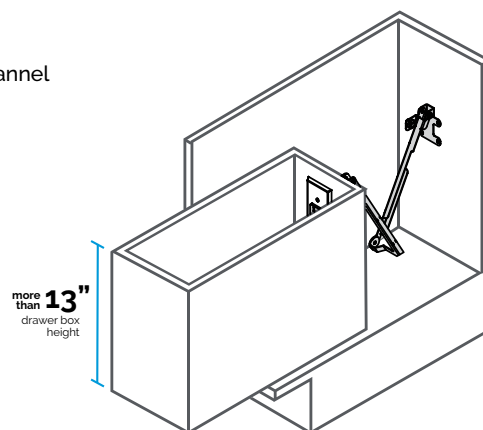

Option 2
with channel

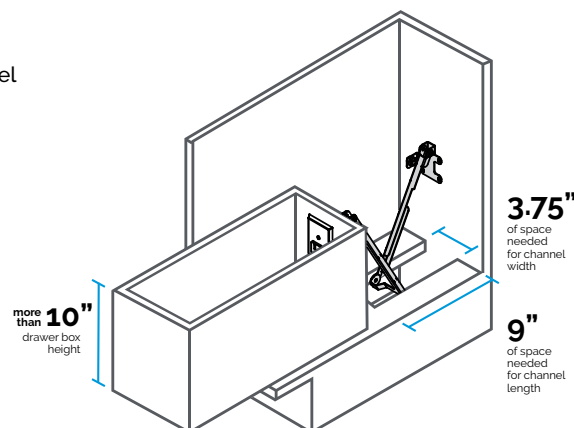

Pro Tip

The ideal location for in-cabinet power supply is the lower left or right corner of the cabinet. This ensures that the cord does not interfere with the in-drawer outlet or the slides.

To install the in-drawer outlet into a shallow vertical drawer, utilize the empty space in the toe kick as seen in Option 2 to make room for the cable management arms to function.

Most Popular Outlet:
15 amp Blade In Drawer
Outlet-1514-160

Bathrooms Pull Out Organizer: Option 1

[Download the Spec Book for more detailed specifications](#)



Docking Drawer Blade Series outlets can be specified into vanity pull out organizers to create a dedicated space to stow and power hair dryers and other accessories while keeping vanity countertops clear of cord and device clutter.

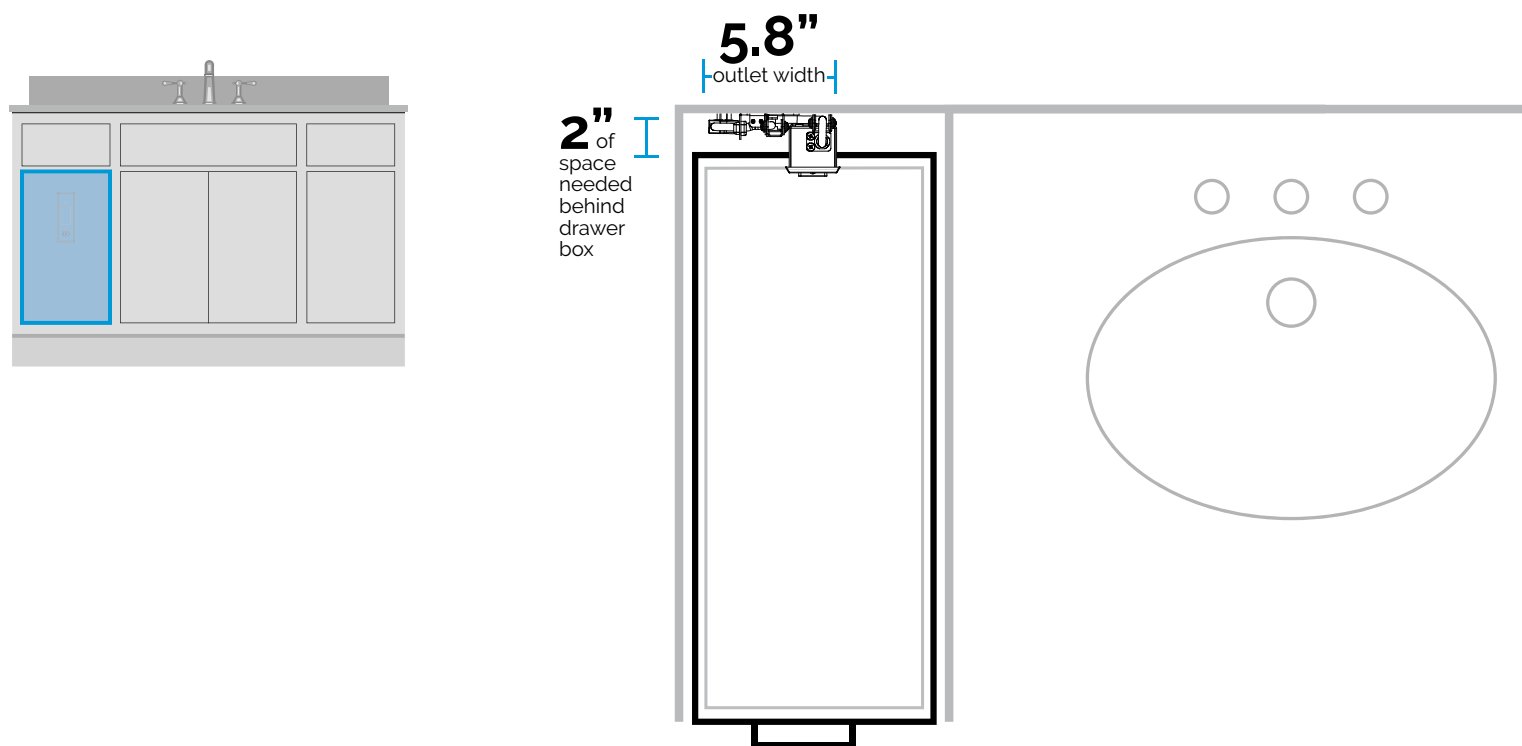

Pro Tip

The ideal location for in-cabinet power supply is the lower left or right corner of the cabinet. This ensures that the cord does not interfere with the in-drawer outlet or the slides.

Docking Drawer Canisters are perfect for creating functional spaces while safely storing hot tools. [Shop Now](#)

Using a Rev-A-Shelf Grooming Organizer [like this](#)? Refer to our How To Guide [here](#).

Need mounting diagrams? Download resources at dockingdrawer.com/downloads

Most Popular Outlet:
15 amp Blade In Drawer Outlet-1514-160

Bathrooms Pull Out Organizer: Option 2

[Download the Spec Book for more detailed specifications](#)



Docking Drawer Blade Series outlets can be specified into vanity pull out organizers to create a dedicated space to stow and power hair dryers and other accessories while keeping vanity countertops clear of cord and device clutter.

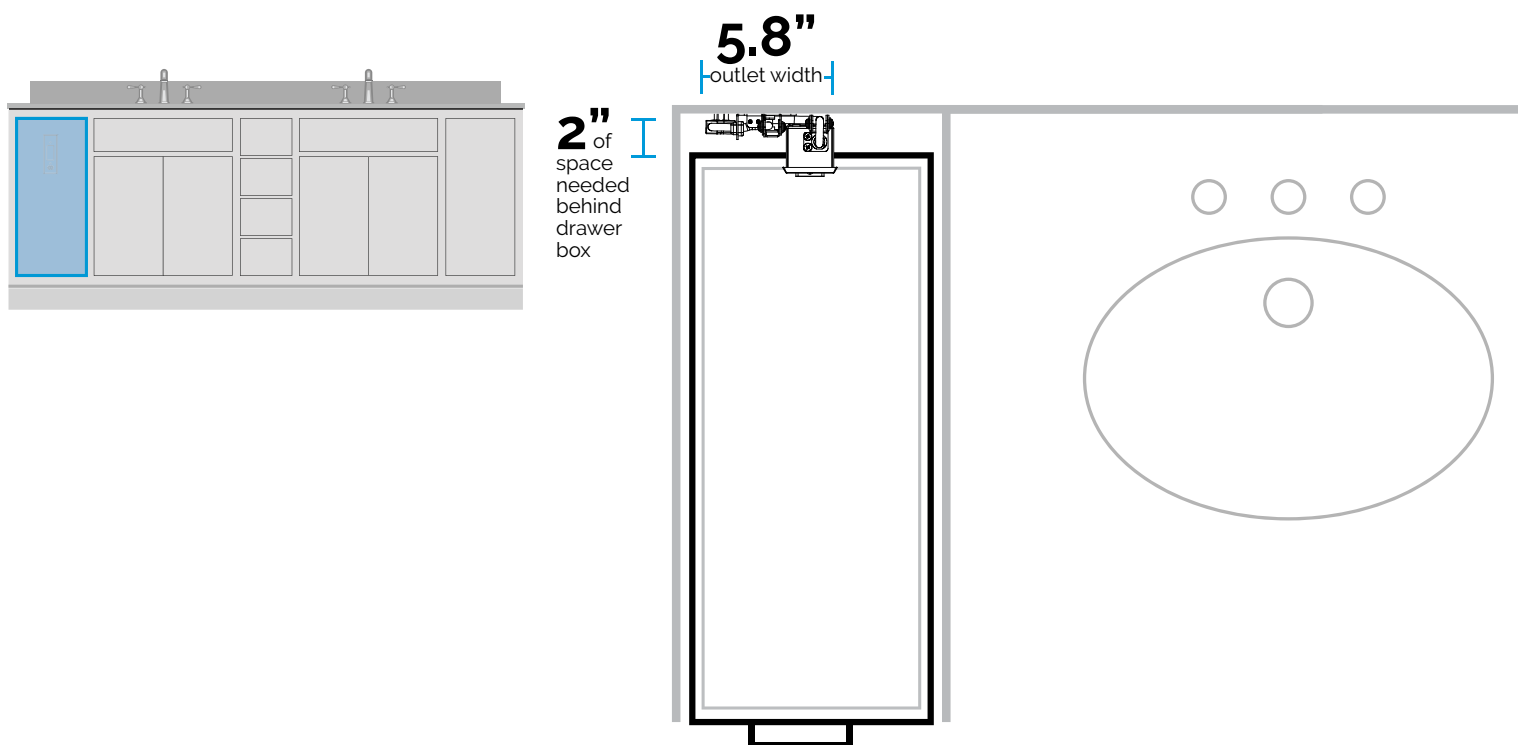

Pro Tip

The ideal location for in-cabinet power supply is the lower left or right corner of the cabinet. This ensures that the cord does not interfere with the in-drawer outlet or the slides.

Docking Drawer Canisters are perfect for creating functional spaces while safely storing hot tools. [Shop Now](#)

Using a Rev-A-Shelf Grooming Organizer [like this?](#) Refer to our How To Guide [here](#).

Need mounting diagrams? Download resources at dockingdrawer.com/downloads

Most Popular Outlet:
15 amp Blade In Drawer Outlet-1514-160

Bathrooms U-Shaped Drawer

[Download the Spec Book for more detailed specifications](#)



Docking Drawer Blade Series outlets can be specified into U-shaped drawers to help utilize awkward drawer space created by sink plumbing fixtures.

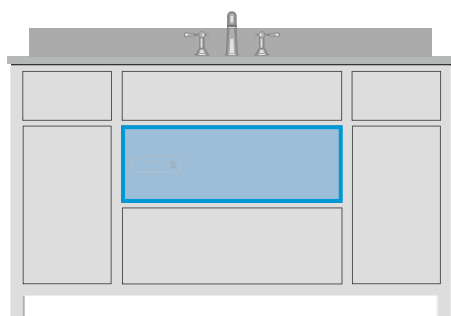

Option 1
without channel

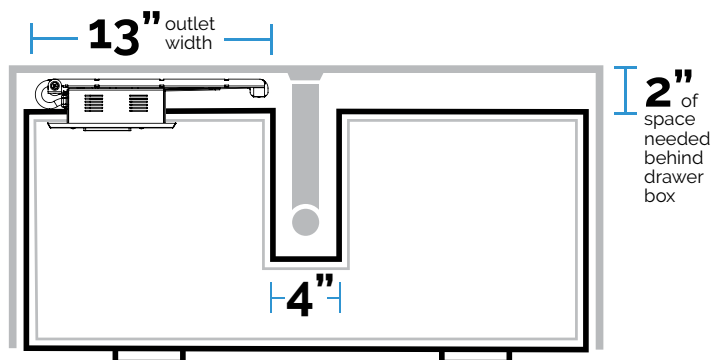

Option 2
with channel

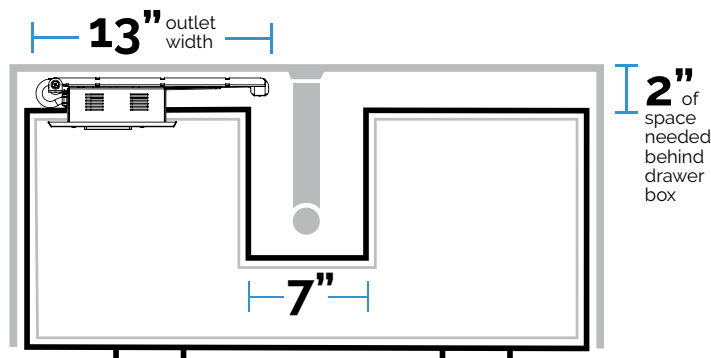

Pro Tip

The back of the U-Shaped drawer box can be less than 13" assuming the cable management arms do not interfere with any plumbing fixtures, as seen in Option 2.

Most Popular Outlet:
15 amp Blade In Drawer
Outlet-1514-160

Bathrooms L-Shaped Pull Out

[Download the Spec Book for more detailed specifications](#)



Docking Drawer Blade Series outlets can be specified into L-shaped vanity pull outs to create purposeful space to stow and power styling tools and other accessories while keeping countertops clear of cord and device clutter.

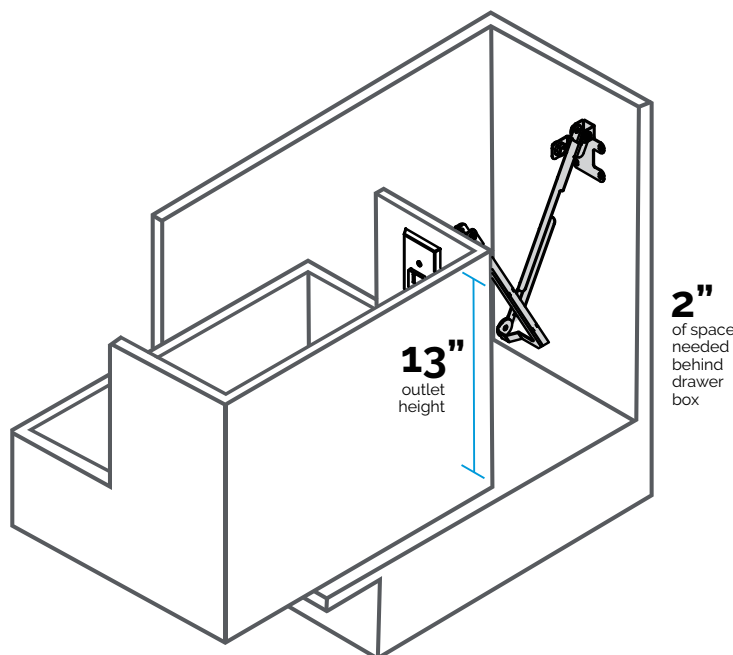
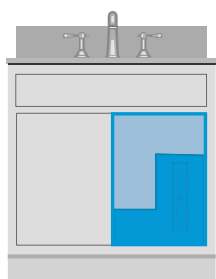

Pro Tip

The ideal location for the in-cabinet power supply is in the lower left or right corner of the cabinet. This ensures that the cord does not interfere with the in-drawer outlet or the slides.

Docking Drawer Canisters are perfect for creating functional spaces while safely storing hot tools.

The Rev-A-Shelf Maple L-Shaped Vanity organizer PT#441-15VSBSC-1 is frequently used in conjunction with a Blade Series outlet to create a powered pull out. The outlet is commonly installed in the back panel underneath the storage shelves.

Most Popular Outlet:
15 amp Blade In Drawer Outlet-1514-160

Bathrooms Powered Pull Out Shelf

[Download the Spec Book for more detailed specifications](#)



Docking Drawer Blade Series outlets can be specified into vanity pull out shelves to create purposeful space to stow and power styling tools and other accessories while keeping countertops clear of cord and device clutter.

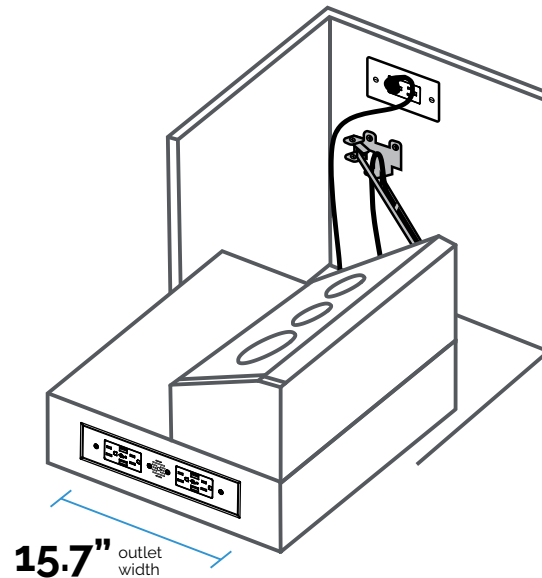
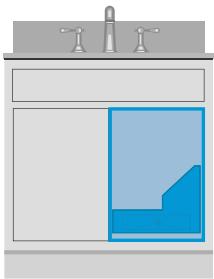

Pro Tip

Sliding shelves are commonly created using 15" deep slides and drawer box widths over 16". This allows the powered pull out shelf to extend beyond the face of the cabinet.

Specify a Deep Cabinet Outlet in powered pull out shelves when the Blade Series outlet is mounted to the front of the shelf to ensure it open completely.

Most Popular Outlet:
15 amp Blade In
Drawer Deep Cabinet
Outlet-1514-160-X30

Bathrooms Makeup Styling Desk: Option 1

[Download the Spec Book for more detailed specifications](#)



Docking Drawer Blade Series outlets can be specified vertically into makeup styling desks to create a dedicated space to stow and power hot tools and other styling accessories while keeping surfaces clear of cords and devices.

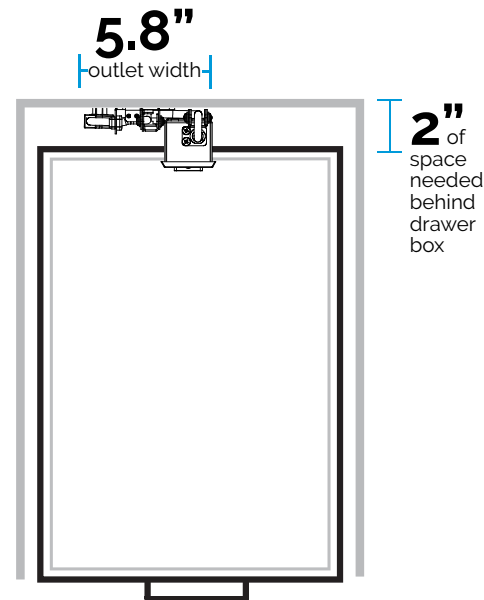
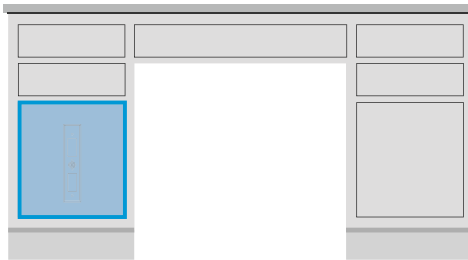

Need Mounting Diagrams?

Download resources at dockingdrawer.com/downloads

Most Popular Outlet:
15 amp Blade Duo In
Drawer Outlet-1514-266

Bathrooms Makeup Styling Desk: Option 2

[Download the Spec Book for more detailed specifications](#)



Docking Drawer Blade Series outlets can be specified horizontally into makeup styling desks to create a dedicated space to stow and power hot tools and other styling accessories while keeping surfaces clear of cords and devices.

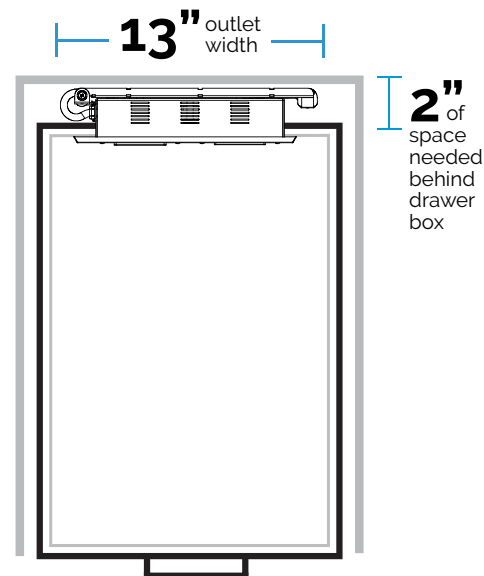
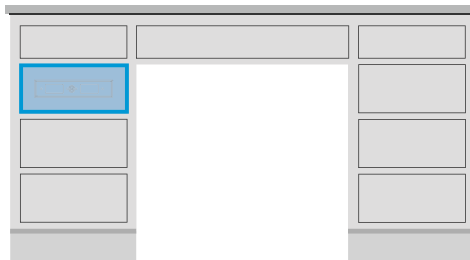

Need Mounting Diagrams?

Download resources at dockingdrawer.com/downloads

Most Popular Outlet:
15 amp Blade Duo In
Drawer Outlet-1514-266

Closets

29

Built In

30

Island





Docking Drawer Blade Series outlets can be specified into built in closet drawers to create a dedicated space to charge wearable technology and other everyday devices.

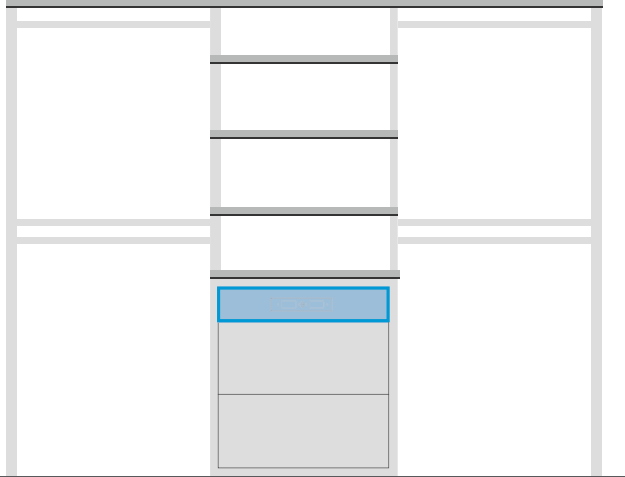

2" of space needed behind drawer box

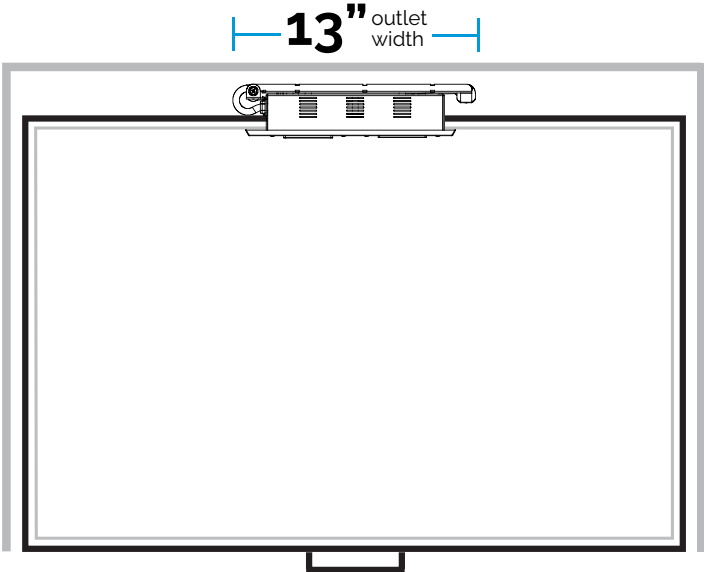

Pro Tips

Think beyond cell phones! Charge headphones, flashlights, reflective safety lights, pet collars and more.

Install multiple Blade Series outlets to create drawers for different purposes such as technology drawers, sports drawers, pet drawers etc.

Specify a 1514-232 so your outlet has fast charging USB-C ports for your newer devices and USB-A for all of your other devices that come with USB-A cords.

Most Popular Outlet:
15 amp Blade Duo In Drawer Outlet-1514-232



Docking Drawer Blade Series outlets can be specified into closet island drawers to create dedicated space to charge wearable technology and other everyday devices.

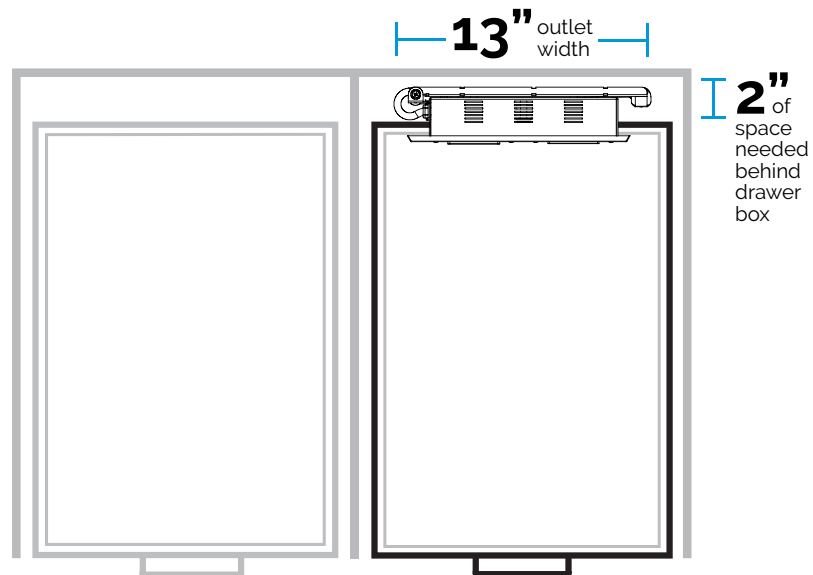
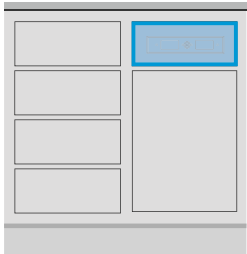

Need Mounting Diagrams?

Download resources at
dockingdrawer.com/downloads

Most Popular Outlet:
15 amp Blade Duo In
Drawer Outlet-1514-232

Offices

- 32 Printer Pullout
- 33 Desk Drawer
- 34 Credenza
- 35 Craft Room Storage



Docking Drawer Blade Series outlets can be specified into printer pull outs to create a dedicated space to power and stow printers and other bulky home office equipment.

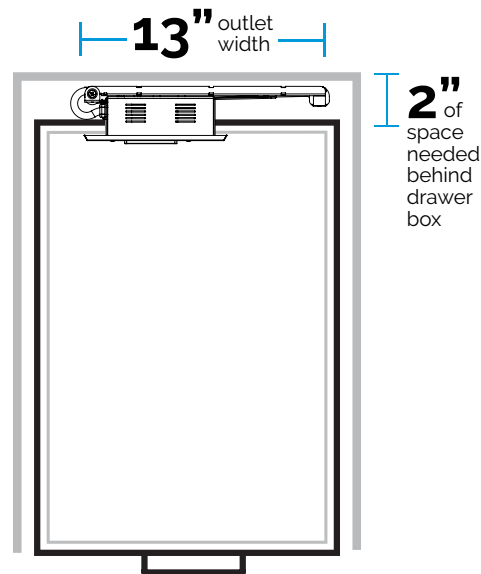

Need Mounting Diagrams?

Download resources at
dockingdrawer.com/downloads

Most Popular Outlet:
15 amp Blade In Drawer
Outlet-1514-160



Docking Drawer Blade Series outlets can be specified into office desk drawers to create a dedicated space to charge tablets, phones, wireless headphones and other accessories while keeping desktop surfaces clear of cord and device clutter.

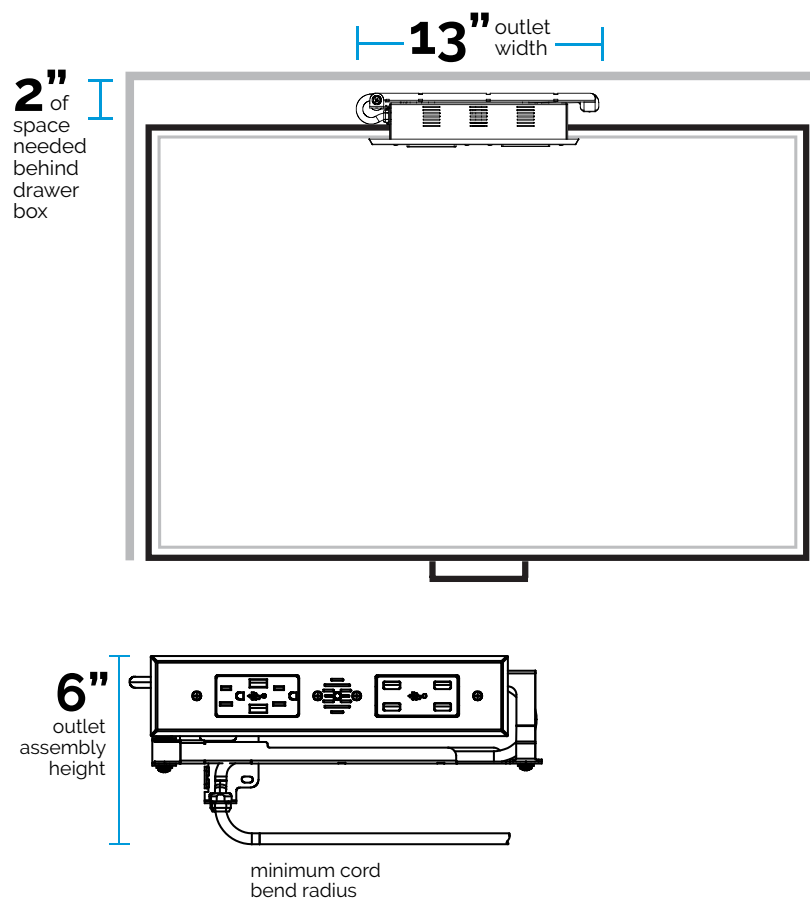
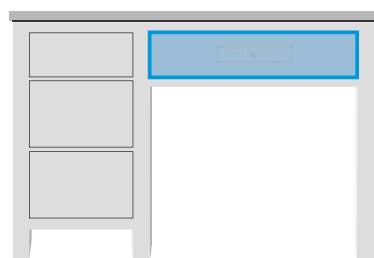

Pro Tip

The Blade Series cord can bend to the side to fit in constrained desk drawer spaces.

The illustration to the left demonstrates the minimum cord bend radius.

Blade Series outlet assembly height is 6" when the cord is bent to the side.

Most Popular Outlet:
15 amp Blade Duo In
Drawer Outlet-1514-232



Docking Drawer Blade Series outlets can be specified into home office credenzas to create hidden charging stations and printer pull out drawers to keep accessories and equipment out of sight while still charged and at the ready.

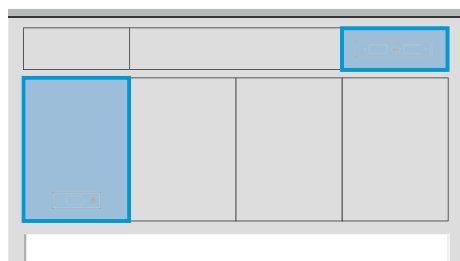

Option 1
charging drawer

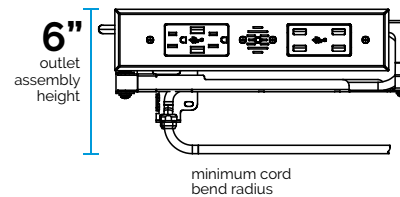
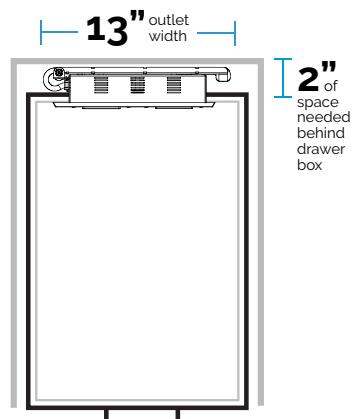

Option 2
printer pullout

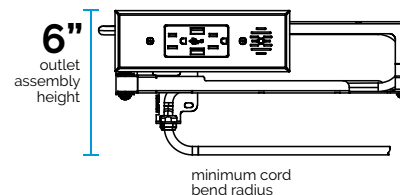
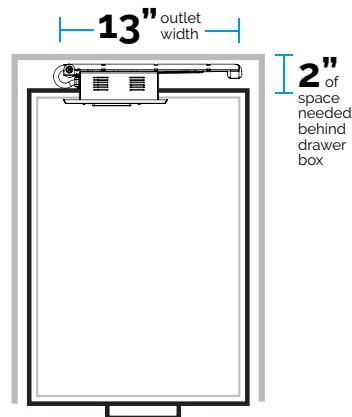

Pro Tips

Every Blade Series outlet can power any device in your office, from tech devices, such as phones and tablets, to laser and inkjet printers.

The Blade Series cord can bend to the side to fit in constrained credenza drawer spaces.

The illustration to the left demonstrates the minimum cord bend radius.

Blade Series outlet assembly height is 6" when the cord is bent to the side.

Most Popular Outlets:
15 amp Blade Duo In Drawer Outlet-1514-232
15 amp Blade In Drawer Outlet-1514-160



Docking Drawer Blade Series outlets can be specified into craft room drawers to hold and power glue guns, tools and other crafting accessories while leaving surface areas clear for crafting projects.

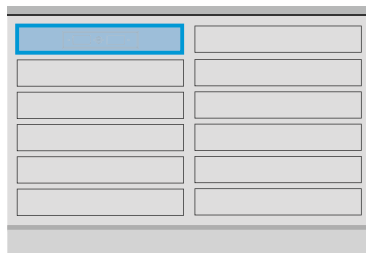

2" of space needed behind drawer box

13" outlet width

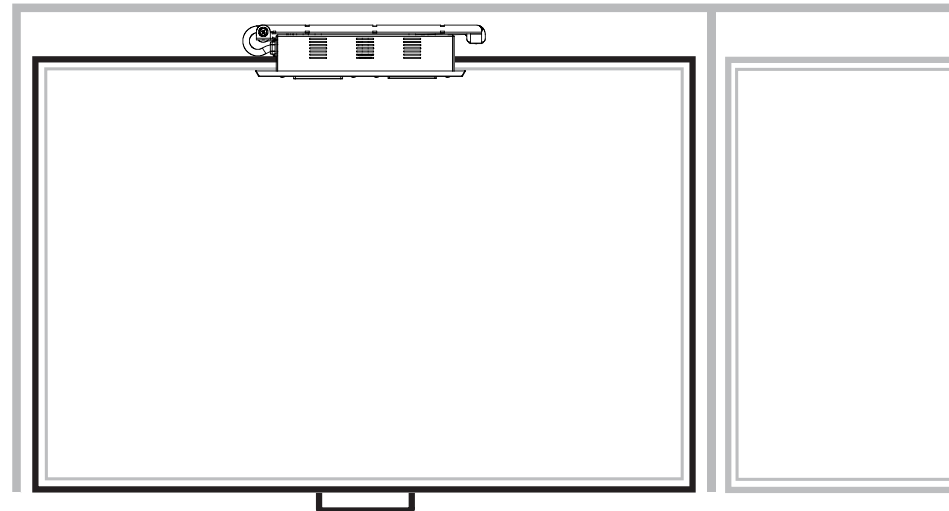

6" outlet assembly height

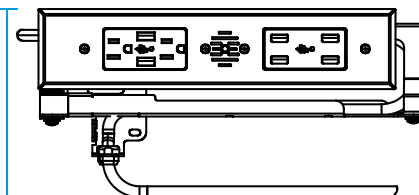

minimum cord bend radius

Pro Tips

The Blade Series cord can bend to the side to fit in constrained craft room drawer spaces.

The illustration to the left demonstrates the minimum cord bend radius.

Blade Series outlet assembly height is 6" when the cord is bent to the side.

Most Popular Outlet:
15 amp Blade Duo In
Drawer Outlet-1514-232

Bedrooms

37

Nightstand

38

Floating Nightstand





Docking Drawer Blade Series outlets can be specified into nightstand drawers to create hidden bedside charging stations and dedicated space to stow and power CPAP machines and other accessories.

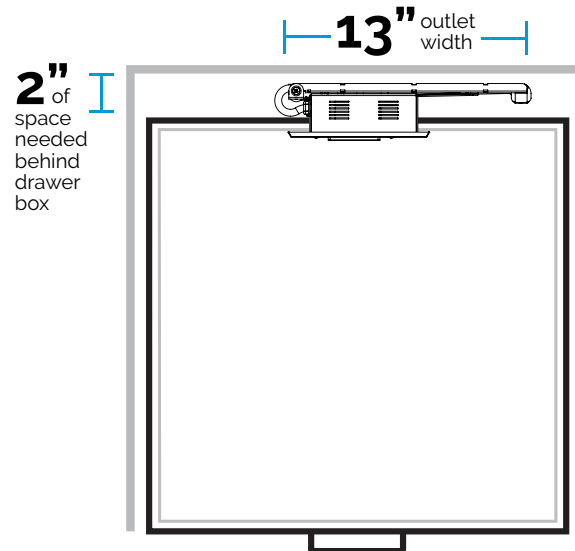
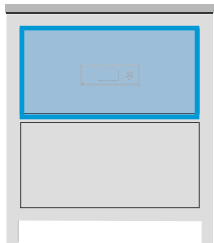

Pro Tips

Blade Series cable management arms can be used to manage other low voltage cables such as networking and telephone cables. Make sure the cables are stranded and designed to be used in a movable location. Solid cables are not meant to be used in a movable location.

Most Popular Outlet: 15 amp Blade In Drawer Outlet-1514-110

Bedrooms Tall Floating Nightstands

[Download the Spec Book for more detailed specifications](#)



Docking Drawer Blade Series outlets can be specified into floating nightstands to create a convenient power source to charge phones, wearable tech, e-readers and other devices overnight while remaining within reach.

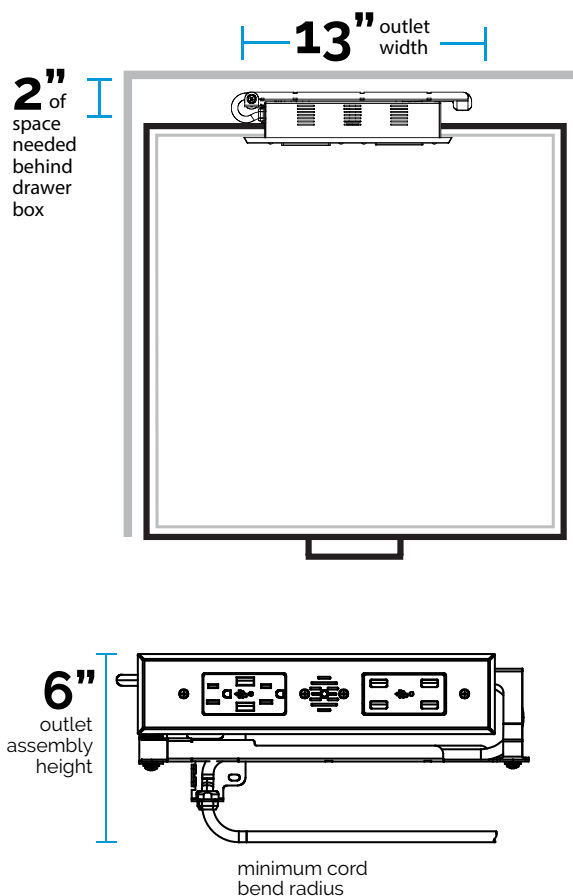
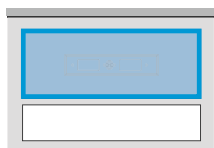

Pro Tips

Blade Series cable management arms can be used to manage other low voltage cables such as networking and telephone cables. Make sure the cables are stranded and designed to be used in a movable location. Solid cables are not meant to be used in a movable location.

The Blade Series cord can bend to the side to fit in constrained nightstand drawer spaces.

The illustration to the left demonstrates the minimum cord bend radius.

Blade Series outlet assembly height is 6" when the cord is bent to the side.

Most Popular Outlet:
15 amp Blade Duo In
Drawer Outlet-1514-232

Bedrooms Shallow Floating Nightstands

[Download the Spec Book for more detailed specifications](#)



Docking Drawer Blade Series outlets can be specified into floating nightstands to create a convenient power source to charge phones, wearable tech, e-readers and other devices overnight while remaining within reach.

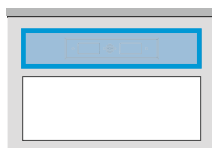

Top View

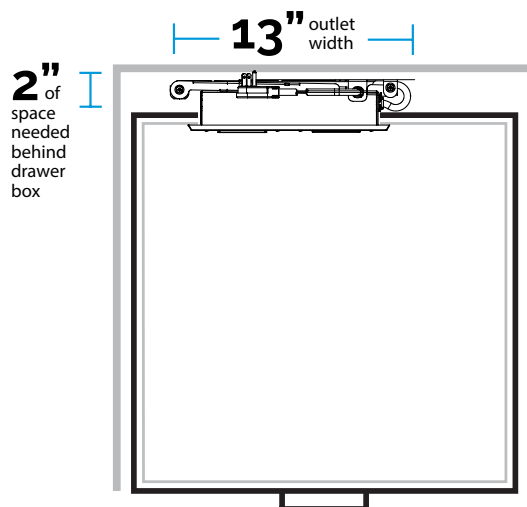

Rear View

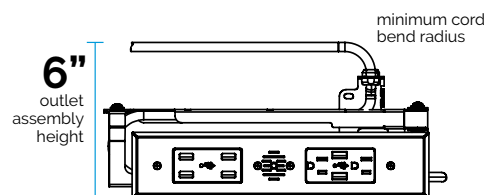
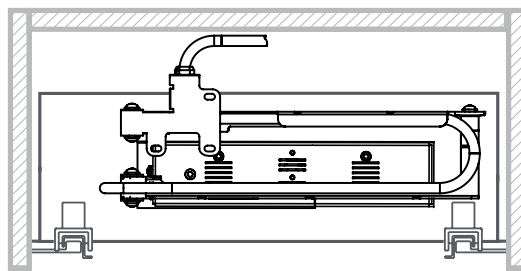

Pro Tips

The Blade Series cord can bend to the side to fit in constrained nightstand drawer spaces.

The illustration to the left demonstrates the minimum cord bend radius.

Blade Series outlet assembly height is 6" when the cord is bent to the side.

When installed in shallower drawers, it is possible to install the outlet upside down and utilize extra space above the drawer box.

Most Popular Outlet:
15 amp Blade Duo In
Drawer Outlet-1514-232

Entryways

40

Mudroom

41

Laundry Room





Docking Drawer Blade Series outlets can be specified into mudroom built ins to create dedicated space to charge wearable tech, pet accessories and other devices you may want to drop and grab on your way in and out of the house each day.

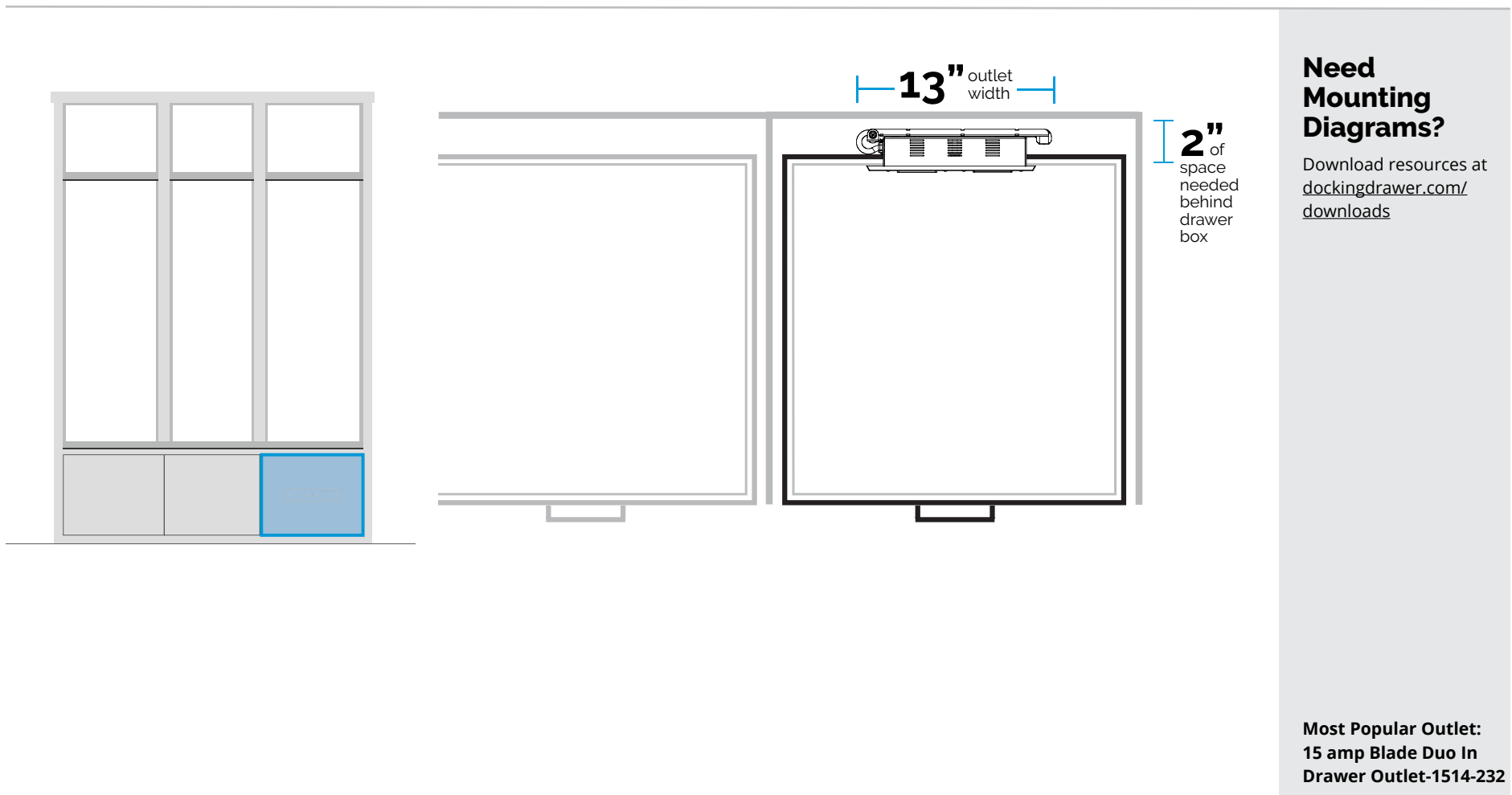



Docking Drawer Blade Series outlets can be specified into laundry room cabinets to create a dedicated space to charge fitness watches, pet accessories and other technology while keeping countertops clear of cord and device clutter.

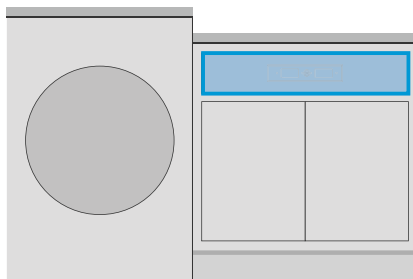

2" of space needed behind drawer box

13" outlet width

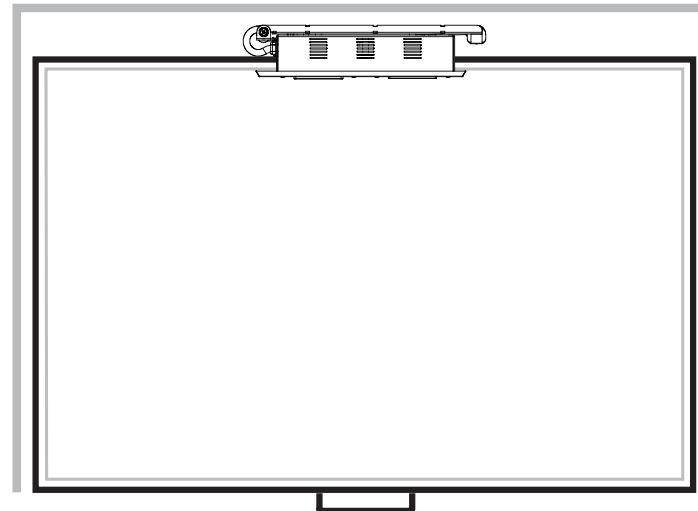

Need Mounting Diagrams?

Download resources at dockingdrawer.com/downloads

Most Popular Outlet:
15 amp Blade Duo In Drawer Outlet-1514-232

Living Rooms

- 43 Side Table
- 44 Entertainment Center
- 45 Console





Docking Drawer Blade Series outlets can be specified into living room side and end table drawers to create a dedicated charging station for bluetooth speakers, phones and other technology while keeping furniture surfaces clear of visible cord and device clutter.

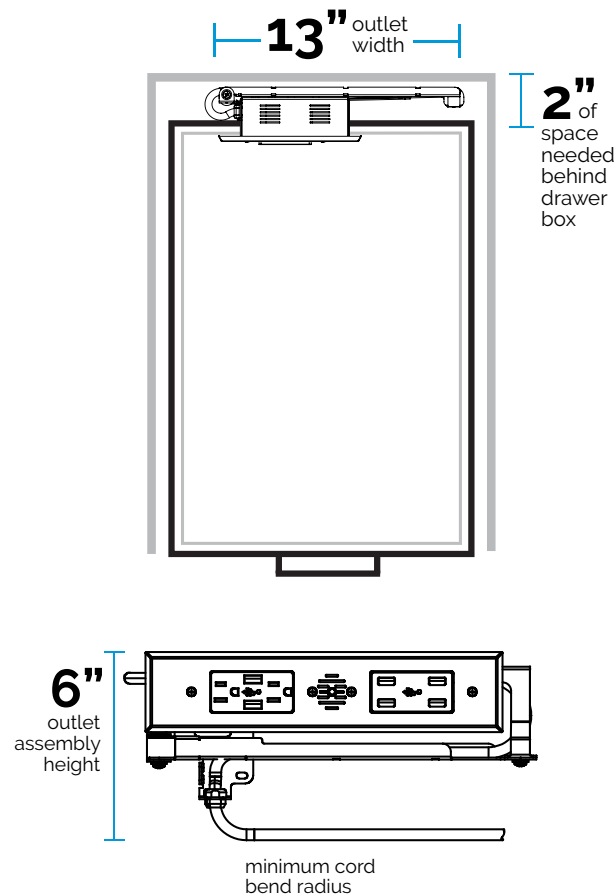
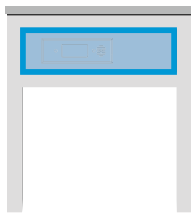

Pro Tip

The Blade Series cord can bend to the side to fit in constrained side table drawer spaces.

The illustration to the left demonstrates the minimum cord bend radius.

Blade Series outlet assembly height is 6" when the cord is bent to the side.

Need Mounting Diagrams?

Download resources at dockingdrawer.com/downloads

Most Popular Outlet: 15 amp Blade In Drawer Outlet-1514-110

Living Rooms Entertainment Center

[Download the Spec Book for more detailed specifications](#)



Docking Drawer Blade Series outlets can be specified into living room entertainment center drawers to neatly stow and power gaming consoles, bluetooth speaks and other devices.

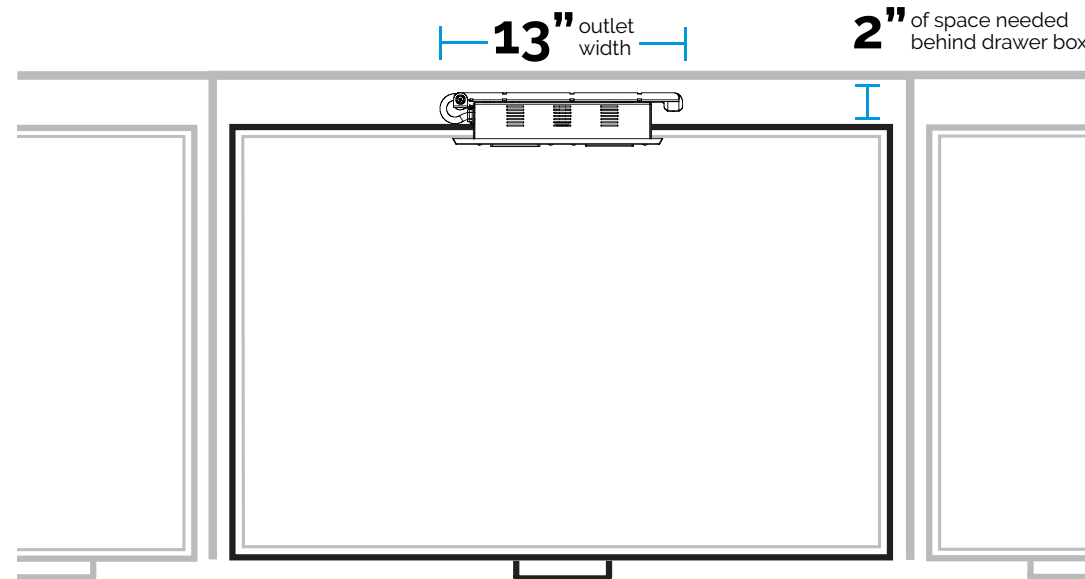
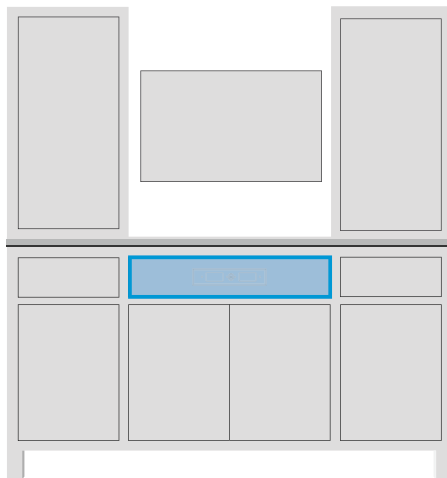

Need Mounting Diagrams?

Download resources at dockingdrawer.com/downloads

Most Popular Outlet:
15 amp Blade Duo In
Drawer Outlet-1514-232



Docking Drawer Blade Series outlets can be specified into living room console drawers to neatly stow and power gaming consoles, bluetooth speakers and other devices.

13" outlet width

2" of space needed behind drawer box

6" outlet assembly height

minimum cord bend radius

Pro Tip

The Blade Series cord can bend to the side to fit in constrained console drawer spaces.

The illustration to the left demonstrates the minimum cord bend radius.

Blade Series outlet assembly height is 6" when the cord is bent to the side.

Need Mounting Diagrams?

Download resources at dockingdrawer.com/downloads

Most Popular Outlet:
15 amp Blade Duo In Drawer Outlet-1514-232

Commercial

- 47 Hotel Nightstand
- 48 Professional Locker Room
- 49 Retail POS
- 50 Lab Casework





Docking Drawer Blade Series outlets can be specified into hotel nightstand drawers to offer guests the ability to conveniently charge tech devices out of site, overnight.

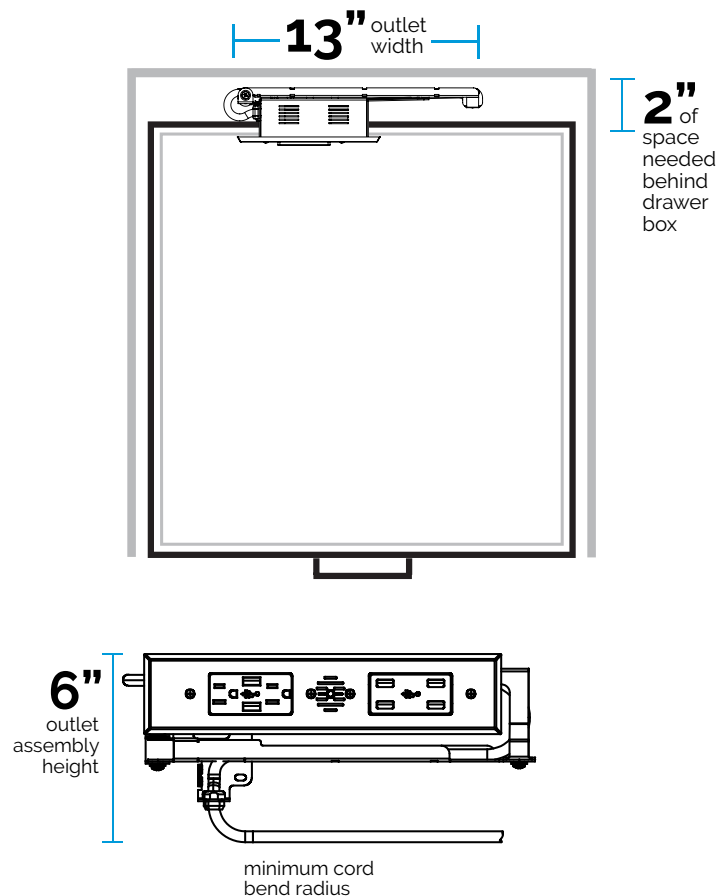
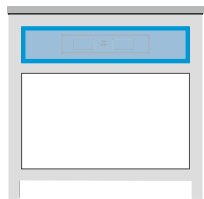

Pro Tip

The Blade Series cord can bend to the side to fit in constrained nightstand drawer spaces.

The illustration to the left demonstrates the minimum cord bend radius.

Blade Series outlet assembly height is 6" when the cord is bent to the side.

Need Mounting Diagrams?

Download resources at dockingdrawer.com/downloads

Most Popular Outlet: 15 amp Blade In Drawer Outlet-1514-110



Docking Drawer Blade Series outlets can be specified into lockers and locker room nooks, offering athletes the ability to safely stow and charge everyday tech devices while they're busy at work.

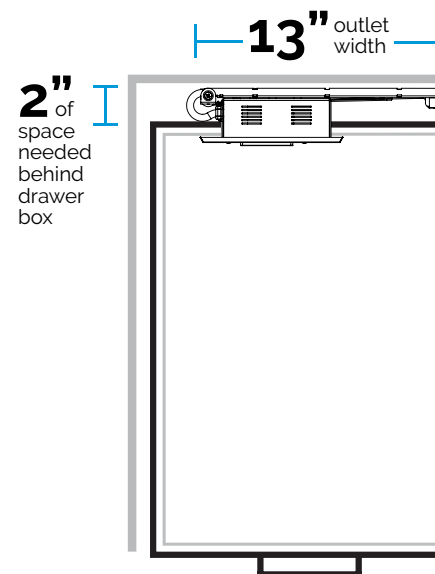
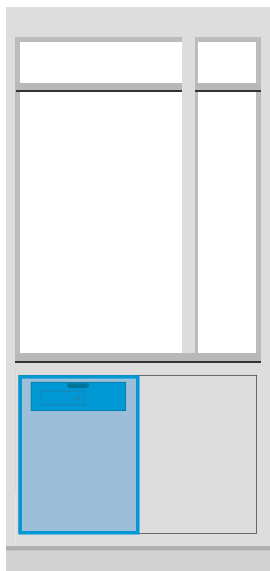

Need Mounting Diagrams?

Download resources at dockingdrawer.com/downloads

Most Popular Outlet: 15 amp Blade In Drawer Outlet-1514-110



Docking Drawer Blade Series outlets can be specified into retail POS (point of sale) drawers, creating a hidden power hub to conceal, charge and power business equipment and personal devices.

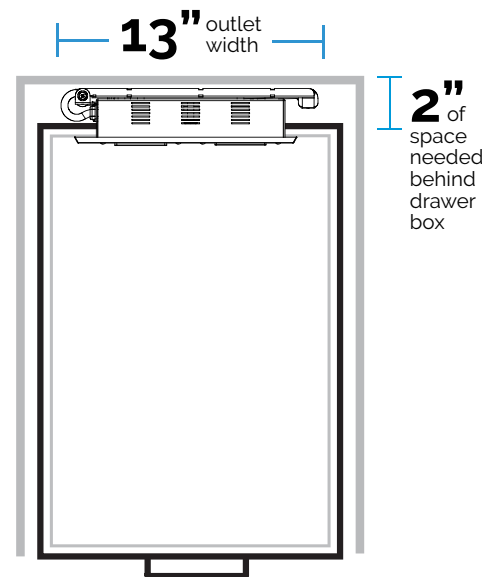

Need Mounting Diagrams?

Download resources at
dockingdrawer.com/downloads

Most Popular Outlet:
15 amp Blade Duo In
Drawer Outlet-1514-232



Docking Drawer Blade Series outlets can be specified into lab casework drawers, creating a dedicated space to stow and charge everyday devices nearby while keeping sensitive worktop surfaces clear of cord and tech clutter.

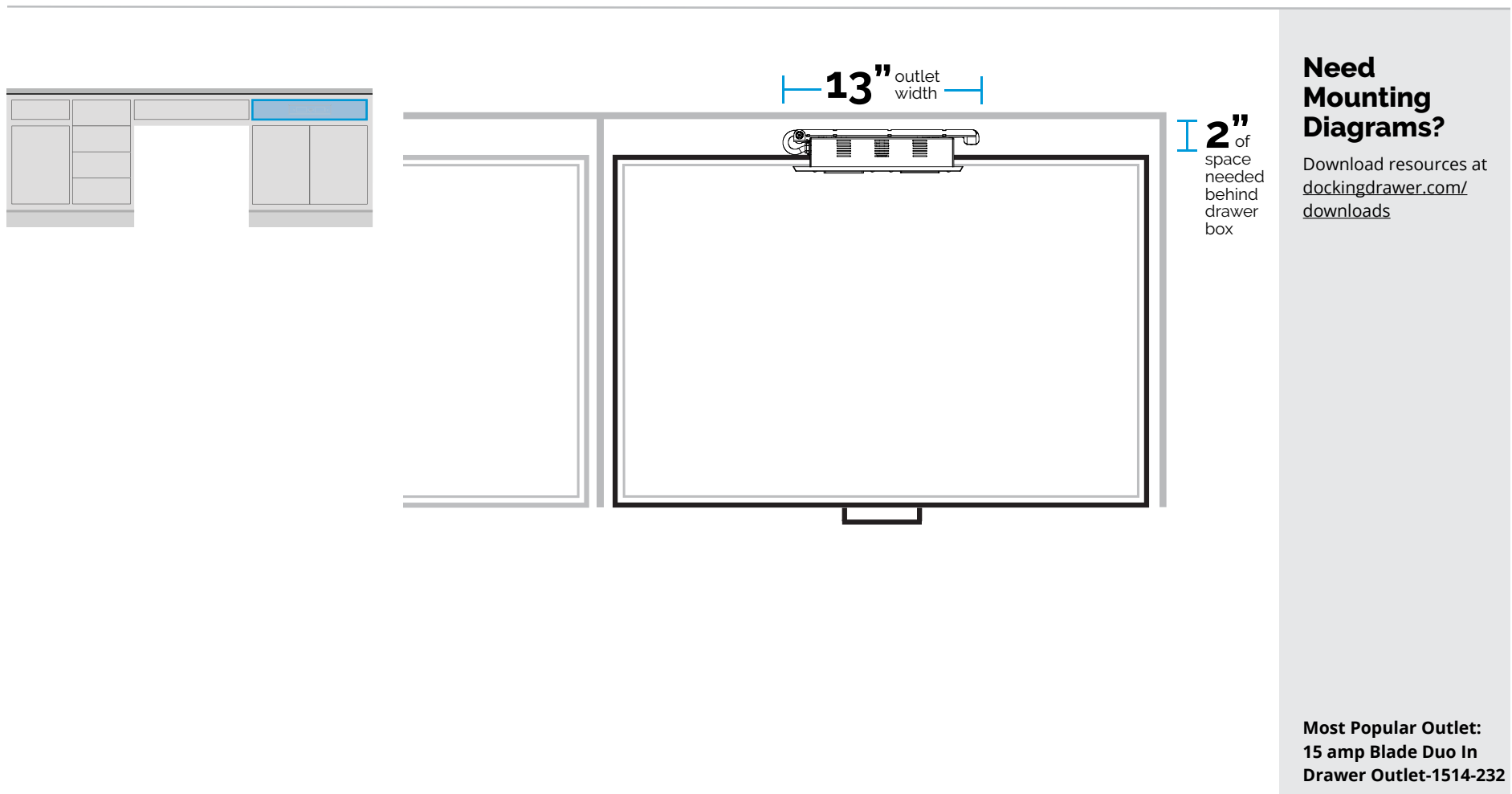

Installation Tips

53

Minimal Space Behind the
Drawer Box Installation
Techniques



Minimal Space Behind the Drawer Box

[Download the Spec Book for more detailed specifications](#)



Installation Technique 1: Create a Spacer (1.25" to 2" Behind the Drawer Box)

You can create a spacer to move the Docking Drawer Blade series outlet further into the drawer box. Spacers can range in length and depth to create a wide range of installation options.

Spacer Installation Technique

Minimal width spacer

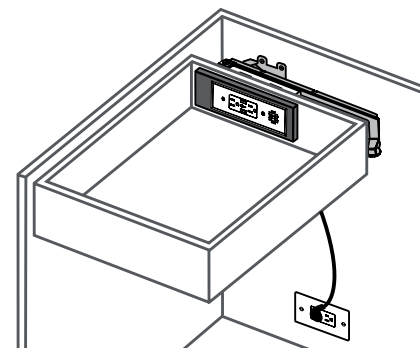
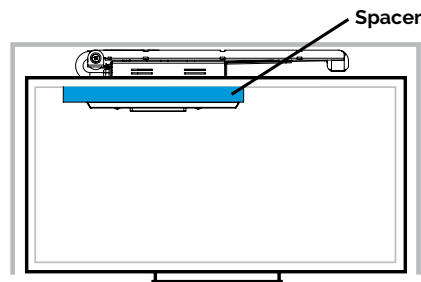

Spacer Installation Technique

Full width spacer

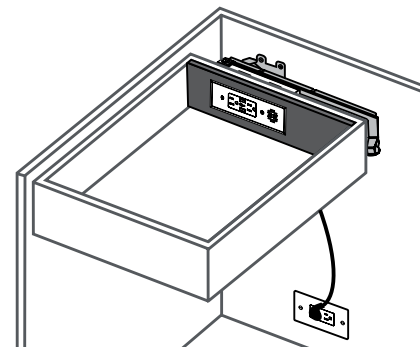
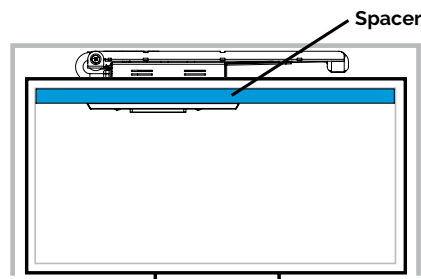

Pro Tip

For more installation examples, see our [mounting diagrams](#).

Minimal Space Behind the Drawer Box

[Download the Spec Book for more detailed specifications](#)



Installation Technique 2: Reposition the back of the drawer box (0" - 2" Behind the Drawer Box)

A new drawer back can be added to move the Docking Drawer Blade series outlet further into the drawer box. For a neater look, cover from the new drawer back panel to the rear of the drawer box so you will not see the mechanical parts of the in-drawer outlet behind the back panel.

Repositioned Drawer Box Installation Technique

Without cover

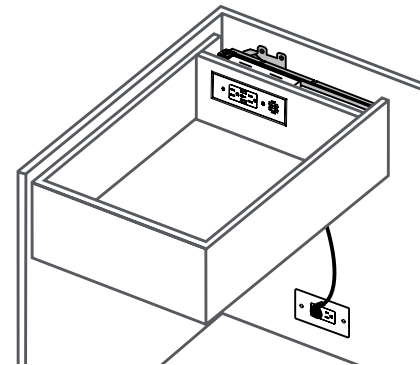
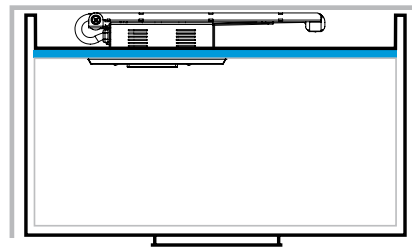

Repositioned Drawer Box Installation Technique

With cover

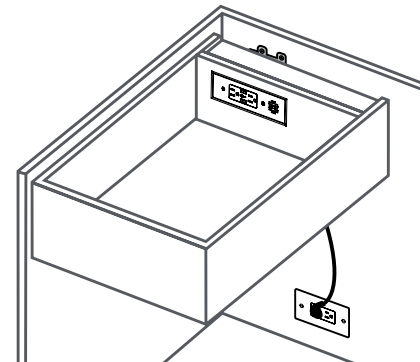
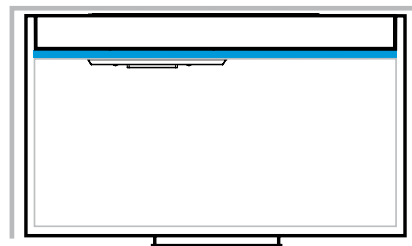

Pro Tip

Read more about [shortening the drawer box](#).

Minimal Space Behind the Drawer Box

[Download the Spec Book for more detailed specifications](#)



Installation Technique 3: Use space behind the cabinet (0" - 2" Behind the Drawer Box)

The back panel of the cabinet can be removed to utilize the extra space. If there is a filler gap between the back wall of your cabinets and the drywall, add a cutout to utilize that space and mount the Docking Drawer bracket directly to the drywall.

Drywall Installation Technique

Using #8 Drywall Anchors

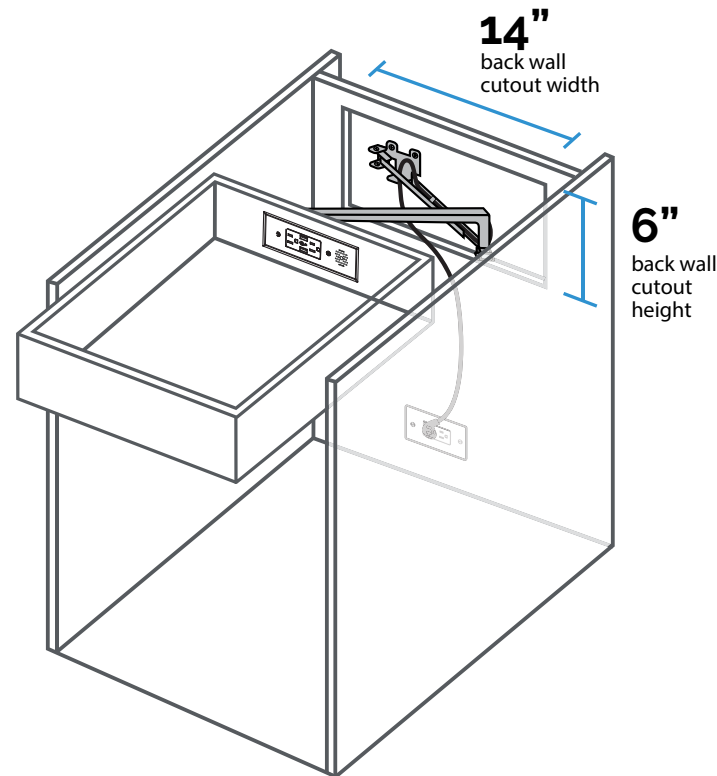

Pro Tip

Closet cabinetry doesn't have a back, Docking Drawer outlets can be mounted to the wall.

Read more about [shortening the drawer box](#).

Ready to Order?

Buy directly from
dockingdrawer.com or call your
hardware/electrical distributor.

We're Here to Help

sales@dockingdrawer.com

Email us here for help with your sales
questions, help with selecting the right
outlet or to request any catalogs.

orders@dockingdrawer.com

Email us here with your purchase orders.

support@dockingdrawer.com

Email us here for help with your technical
and project planning questions or with
any other specification questions.

Docking Drawer®

