

Docking Drawer®

5050- Flush Pop Up Outlet Installation Instructions



Downloadable Resources

For additional planning resources, visit
dockingdrawer.com/downloads

- Spec Books
- Electrical Certifications
- Tear Sheets
- Cut Out Templates



CAUTION – READ CAREFULLY

- For indoor use only.
- Avoid liquid spills into the outlet.
- When using the wireless charger, do not place metal objects, magnets, magnetic stripe cards, etc.
- Be sure to ground connection.
- Do not disassemble the unit.
- If the product has malfunctioned, electrical maintenance is required by a professional.

How to Install the Outlet

Step 1 - Select a location for the pop-up outlet that meets the following requirements:

- The edge of the cut out should be at least 40mm from the nearest wall.
- A power outlet should be within 1.5 meters of the installation cut out for the power cord to reach.
- Worktop thickness is between 10-45mm.
- Consult the following illustrations to ensure there is sufficient space underneath the worktop.

QUAD
5050-1555
5050-1155

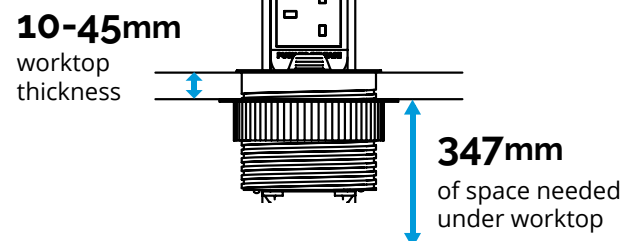

TRIO

5050-1550
5050-1150

10-45mm

worktop
thickness

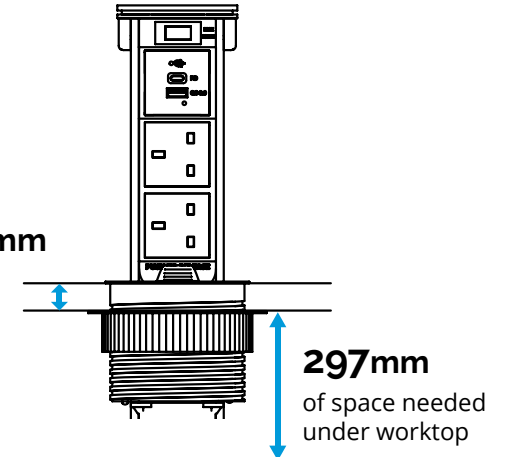

DUO

5050-1500

10-45mm

worktop
thickness

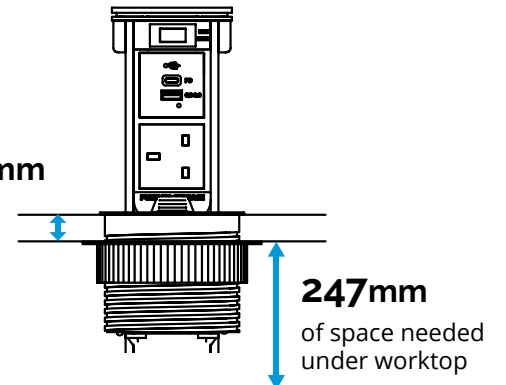

Step 2 -

Cut a
95mm hole in
the surface of
the worktop to
create the installation
cut out.

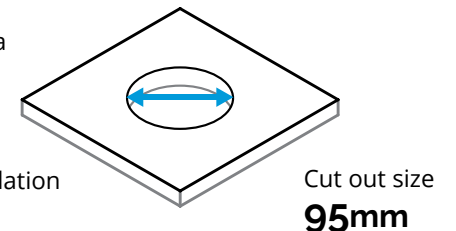

Step 3 - Rotate the adjustable ring in a counter-clockwise direction to remove. Place the power cord through the installation cutout and then insert the base of the outlet into the cut out. Be careful to avoid damage to power cord.

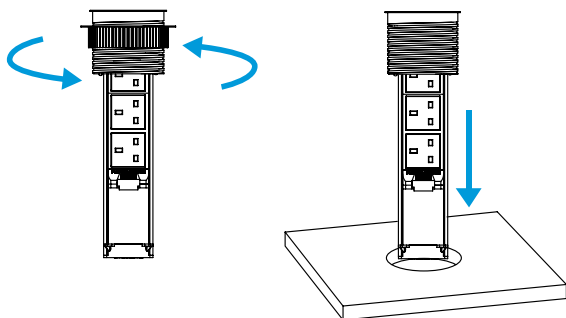

Step 4 - Adjust the front of the product to face the desired direction. Under the worktop, rotate the adjustable ring in a clockwise direction to tighten. Note that when the adjustable ring is askew, it will get stuck. If this occurs, re-tighten after alignment.

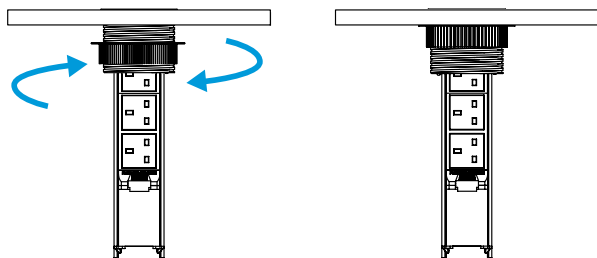

Step 5 - Connect the power cord to a power source within 1.5m, ensuring the outlet can open and close without tension on the cord.

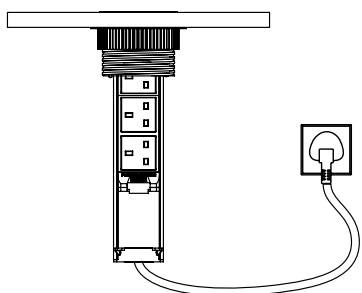

How to Use the Outlet

To Open - Press the center of the top and the outlet will pop up. Lift the outlet until it locks into place.

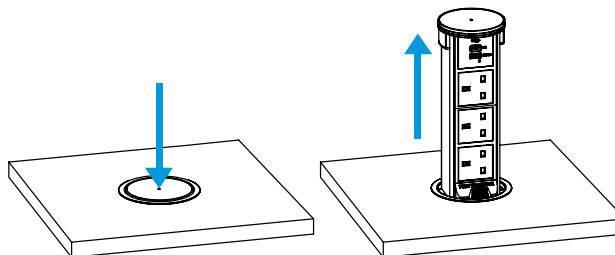

To Close - Press the “Push to Release” button to partially retract the outlet. Then press the top of the outlet to push the rest of the tower into the worktop and to lock into place.

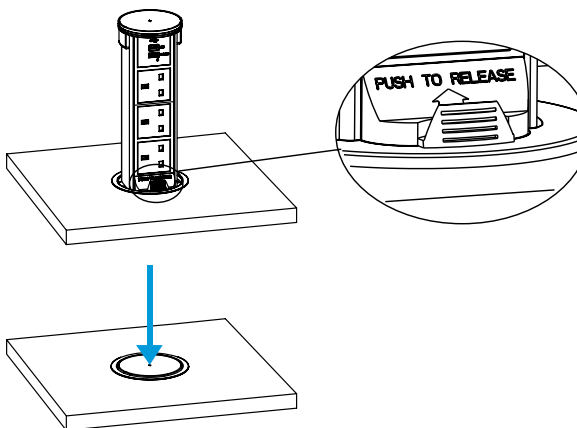

Wireless Charging - Place the device gently in the center of the top cover. Compatible with all Qi enabled devices. Ensure that there are no metallic foreign objects on the charging pad. If you're having an issue charging a device, remove the device case, if any, as it may block the wireless signal.

Also Available from Docking Drawer

Docking Drawer Trio

Install Docking Drawer in-drawer outlets into any drawer to clear worktop cord and device clutter and bring purpose to your drawers. Docking Drawer Trio outlets are UKCA and CE Listed for use in UK and Ireland.



Scan code to learn more

Docking Drawer®

+1 (925) 233-5598

✉ sales@dockingdrawer.com

🌐 www.dockingdrawer.com