

Docking Drawer®

5030- Flush Pop Up Motorized Outlet Installation Instructions

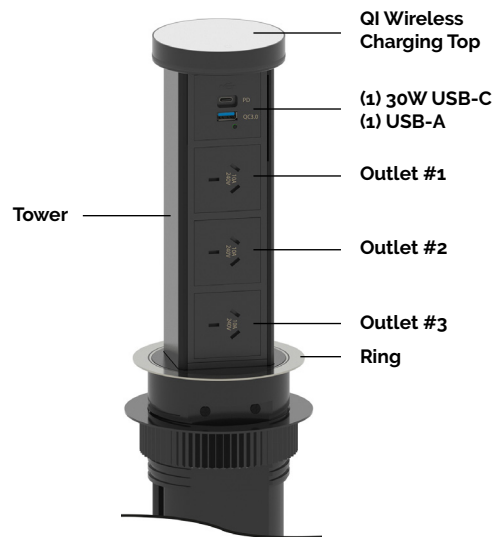

Downloadable Resources

For additional planning resources, visit
dockingdrawer.com/downloads

- Spec Books
- Electrical Certifications
- Tear Sheets
- Cut Out Templates



CAUTION - READ CAREFULLY

- For indoor use only.
- Avoid liquid spills into the outlet.
- When using the wireless charger, do not place metal objects, magnets, magnetic stripe cards, etc.
- Be sure to ground connection.
- Do not disassemble the unit.
- If the product has malfunctioned, electrical maintenance is required by a professional.

How to Install the Outlet

Step 1 - Select a location for the pop-up outlet that meets the following requirements:

- The edge of the cut out should be at least 40mm from the nearest wall.
- A power outlet should be within 1.5 meters of the installation cut out for the power cord to reach.
- Benchtop thickness is between 10-45mm.
- Consult the following illustrations to ensure there is sufficient space underneath the benchtop.

QUAD
5030-1333XXXQM

10-45mm

benchtop
thickness

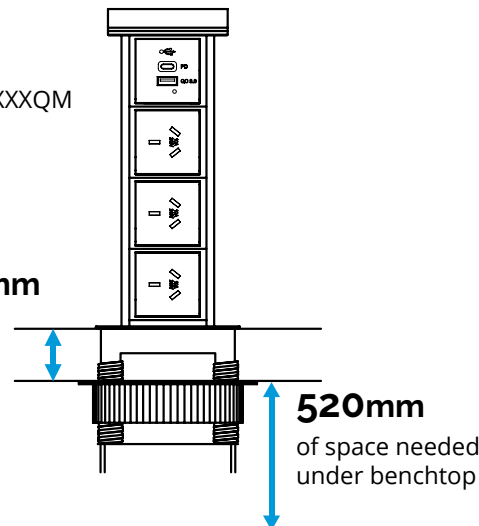

Step 2 - Cut a 95mm hole in the surface of the benchtop to create the installation cut out.

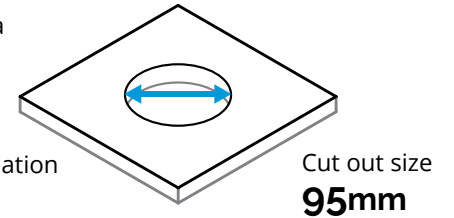

Step 3 - Rotate the adjustable ring in a counter-clockwise direction to remove. Place the power cord through the installation cutout and then insert the base of the outlet into the cut out. Be careful to avoid damage to power cord.

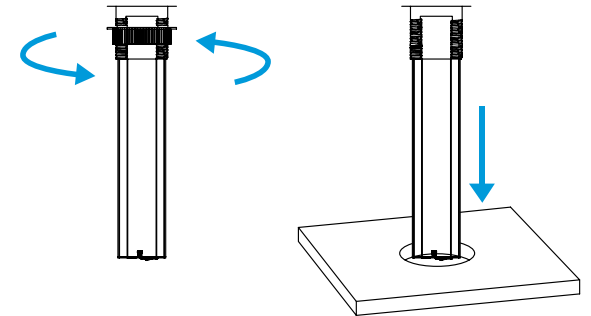

Step 4 - Adjust the front of the product to face the desired direction. Under the benchtop, rotate the adjustable ring in a clockwise direction to tighten. Note that when the adjustable ring is askew, it will get stuck. If this occurs, re-tighten after alignment.

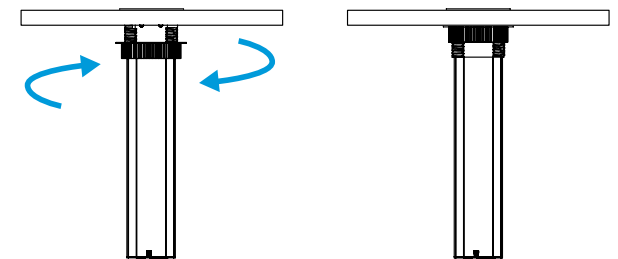

Step 5 - Connect the power cord to a power source within 1.5m, ensuring the outlet can open and close without tension on the cord.

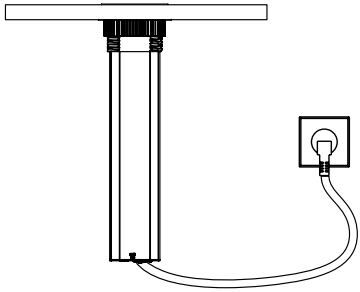

To Lower - Once the outlet is fully raised, tap the power icon on the top to lower the unit. The outlet can be paused by tapping the top again. If the outlet becomes obstructed, the anti-trap function will activate and the outlet will raise slightly then pause.

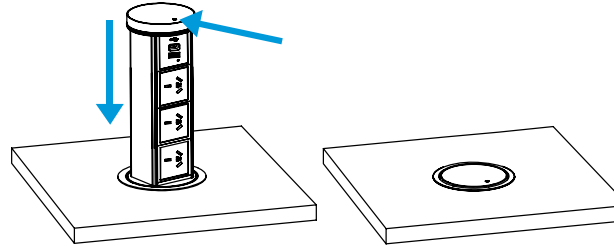

How to Use the Outlet

To Enable - Tap and hold the power icon on the top for 3 seconds until the LED light turns blue.

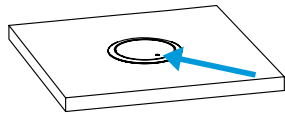

To Raise - Once the unit is enabled, tap the power icon again to raise the outlet. The outlet can be paused by tapping the top again. If the outlet becomes obstructed, the anti-force function will activate and pause the movement of the outlet. Clear the obstruction and tap the top again to continue raising the unit.

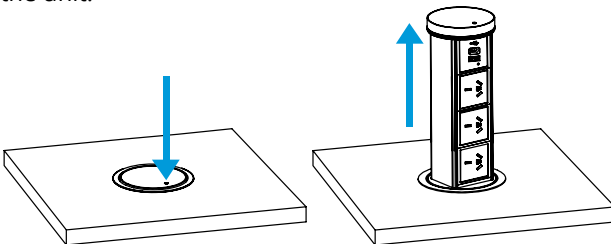

Wireless Charging - Place the device gently in the center of the top cover, avoiding contact with the touch switch. Compatible with all Qi enabled devices. Ensure that there are no metallic foreign objects on the charging pad. If you're having an issue charging a device, remove the device case, if any, as it may block the wireless signal.

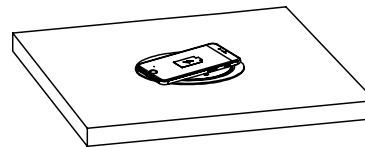

Also Available from Docking Drawer

Docking Drawer Trio

Install Docking Drawer in-drawer outlets into any drawer to clear benchtop cord and device clutter and bring purpose to your drawers. Docking Drawer Trio outlets are Australian Certified for Safety and EMC.



Scan code to learn more

Docking Drawer®

(866) 806-7228

✉ sales@dockingdrawer.com

🌐 www.dockingdrawer.com